

# Operation Manual

## Engine Hoist Support Beam

30154



Illustration similar, may vary depending on model

Read and follow the operating instructions and safety information before using for the first time.

Technical changes reserved!

Due to further developments, illustrations, functioning steps, and technical data can differ insignificantly.

Updating the documentation

If you have suggestions for improvement or have found any irregularities, please contact us.



The information contained in this document may alter at any time without previous notice. It is prohibited to copy or spread any parts of this document in any way without prior written allowance. All rights reserved.

The WilTec Wildanger Technik GmbH cannot be held accountable for any possible mistakes in this operating manual, nor in the diagrams and figures shown.

Even though, the WilTec Wildanger Technik GmbH has undergone biggest possible efforts to ensure that the operating manual is complete, faultless, and up to date, mistakes cannot be entirely avoided.

If you should find a mistake or wish to make a suggestion for improvement, we look forward to hearing from you.

Send an e-mail to:

[service@wiltec.info](mailto:service@wiltec.info)

or use our contact form:

<https://www.wiltec.de/contacts/>

The most recent version of this manual in various languages can be found in our online shop via:

<https://www.wiltec.de/docsearch>

Our postal address is:

WilTec Wildanger Technik GmbH  
Königsbenden 12  
52249 Eschweiler  
Germany

To return orders for exchange, repair, or other purposes, please use the following address. Attention! To allow for a smooth execution of your complaint or return, it is important to contact our customer service team before returning the goods.

Returns Department  
WilTec Wildanger Technik GmbH  
Königsbenden 28  
52249 Eschweiler

E-mail: **service@wiltec.info**

Tel: +49 2403 55592-0

Fax: +49 2403 55592-15

## Introduction

Thank you for purchasing this quality product. **To minimise the risk of injury we urge that our clients take some basic safety precautions when using this device. Please read the operation instructions carefully and make sure you have understood its content.** Keep these operation instructions safe.

## Exploded view and parts list

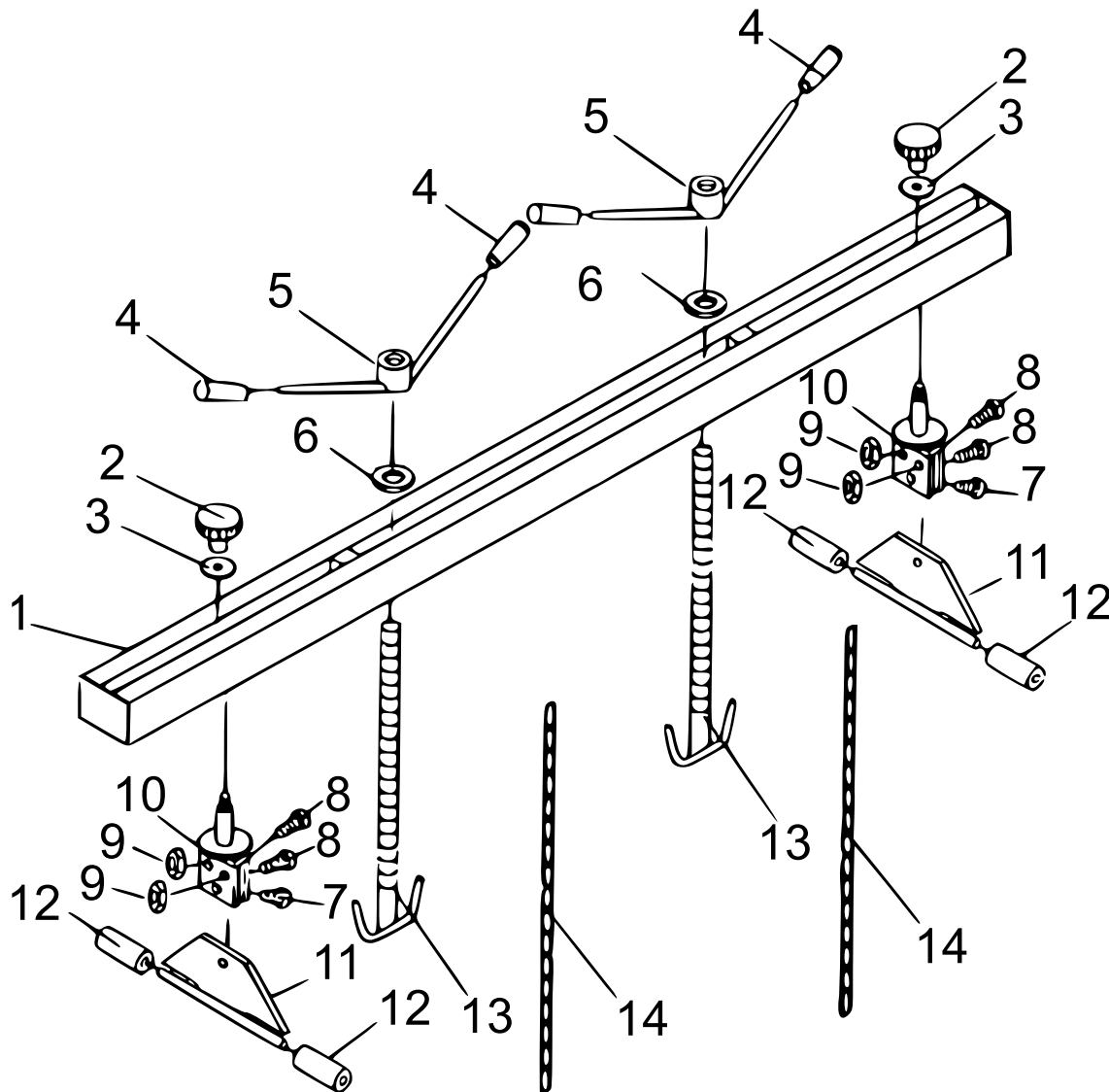

Nº	Name	Nº	Name
1	Support beam	8	Bolt M10×35
2	Milled screw	9	Hexagonal nut M10/M12
3	Washer	10	Trench support
4	Handle sleeve	11	Variable standing bracket
5	Grip handle	12	Rubber sleeve
6	Washer	13	Load hook M20×2.5 (330 mm)
7	Bolt M12×25	14	Load chain



## Safety instructions

**To avoid malfunctions, damage, and health impairments,  
observe the following instructions!**

- Unqualified persons must not use the engine hoist support beam.
- Use the beam for its intended purpose, only for lifting vehicle engines. Never use the beam to transport loads!
- Make sure that the vehicle structure is suitable for the use of the beam. The surface of the vehicle structure must be flat to prevent the beam from slipping.
- Determine the most stable area of the vehicle structure to set up the beam. Do not place the supports **(11)** with the rubber protective caps **(12)** on the mudguards (paint damage!), but on the inside of the spray wall (upper mudguard attachment) or on the shock absorber receptacle.
- Make sure that the vehicle cannot roll away when using the beam.
- Do not use the beam if there is a risk of petrol or other dangerous substances leaking.
- After the beam has been properly assembled, first tighten the bolts **(7)** and locking knurled screws **(2)** to stabilise the bridge.
- Never work under a raised engine!
- Do not exceed the permissible load capacity of the beam.
- Fasten the engine to be lifted by wrapping the load chains **(14)** around it and hang the chains on the load hook. To lift the motor, turn the hand lever nuts **(5)**.
- Clean and lubricate the threads on all parts from time to time.
- Store the beam in a dry place protected from moisture.
- Modifications and alterations to the beam are not permitted. We accept no liability for damage caused by improper use of the beam.
- Do not use the beam with parts being bent or damaged.

## Technical specifications

<b>Load capacity (kg)</b>	500
<b>Chain length (cm)</b>	approx. 90
<b>Lifting height (cm)</b>	approx. 20
<b>Weight (without chains) (kg)</b>	17

Important notice:

The reprint or reproduction, even of excerpts, and any commercial use, even in part, of this instruction manual require the written permission of WilTec Wildanger Technik GmbH.