

No	Name	No	Name
1	Front element	6	Roof
2	Ramp (1x)	7	Wooden rod
3	Upper rear panel	8	Divider
4	Side panel (2x)	9	Lower rear panel
5	Bottom		

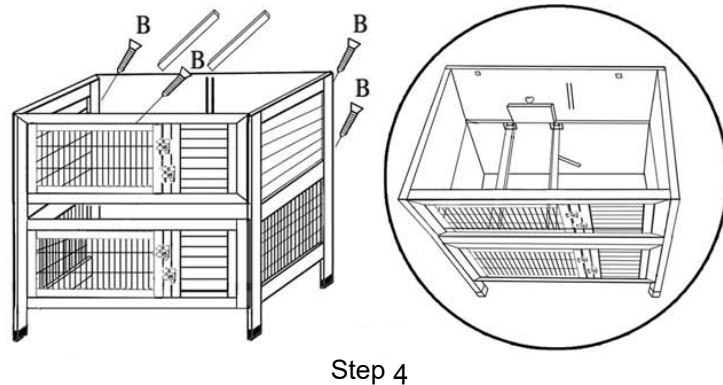

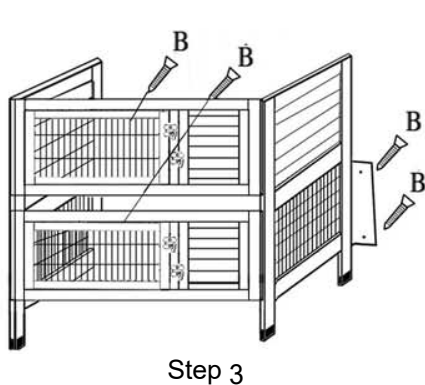

Step 5

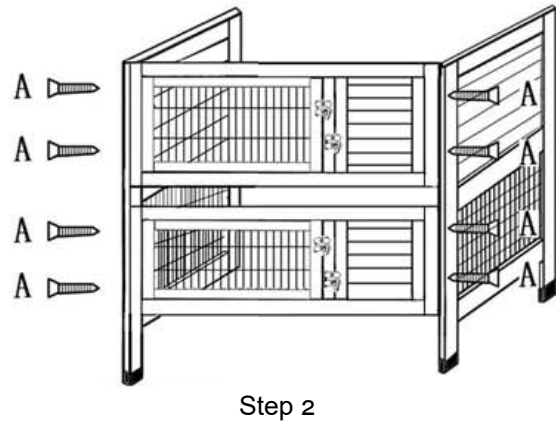
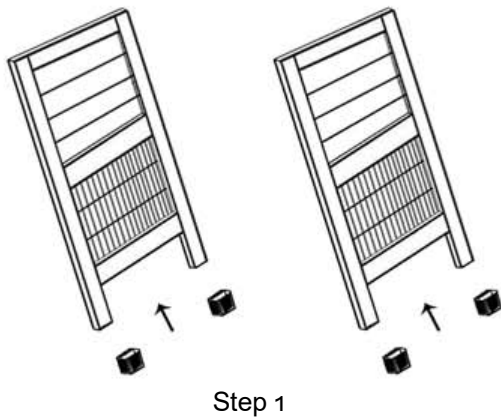
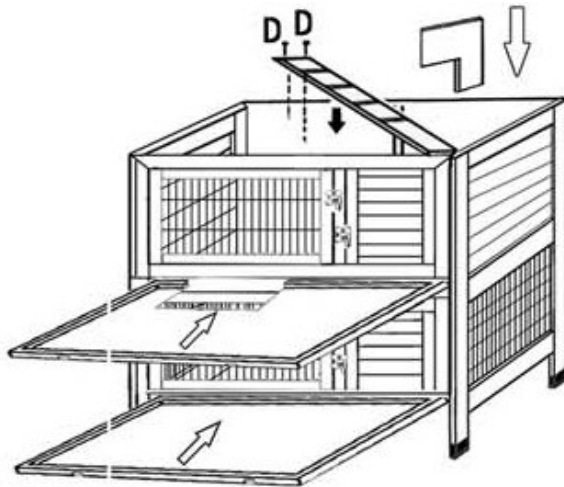
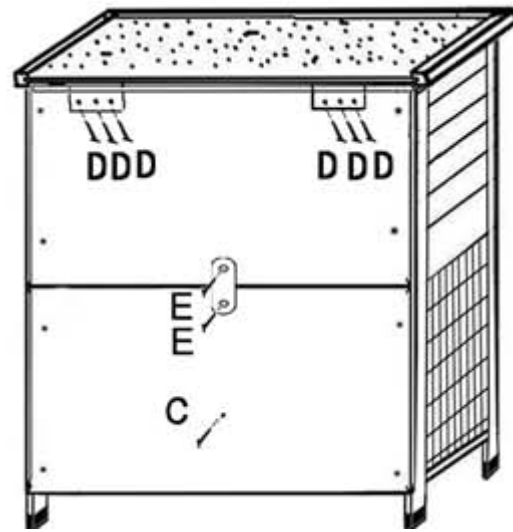

Secure bottom of ramp with screw **C** through rear panel

Step 6

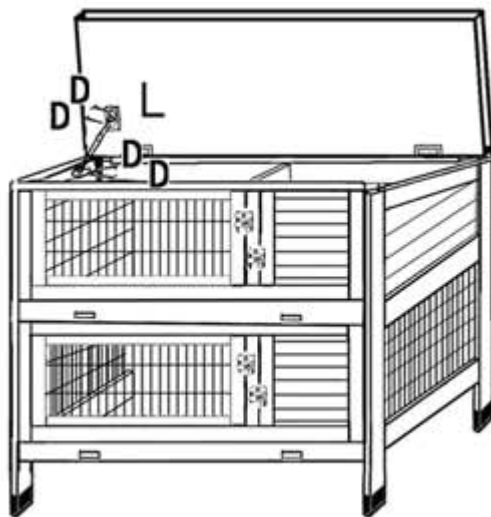

Step 7

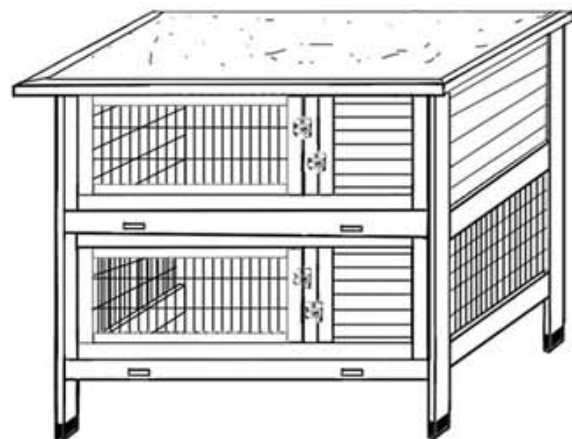

Step 8

**Important Note:**

Reproduction and any commercial use (of parts) of this operating manual, requires a written permission of WilTec Wildanger Technik GmbH.