

Operation Manual

Spreader 20 kg

50141

XPO ^{the} **tool**
experts



Illustration similar, may vary depending on model

Please read and follow the operating instructions and safety information prior to initial operation.

Technical changes reserved!

Illustrations, functional steps, and technical data may deviate insignificantly due to continuous further developments.



The information contained in this document may alter at any time without prior notice. No part of this document may be copied or otherwise duplicated without prior written consent. All rights reserved. WilTec Wildanger Technik GmbH cannot be held liable for any possible mistakes in this operating manual, nor in the diagrams and illustrations shown.

Although WilTec Wildanger Technik GmbH has made every possible effort to ensure that this operating manual is complete, accurate, and up-to-date, errors cannot be ruled out entirely.

If you have found an error or wish to suggest an improvement, we look forward to hearing from you. Send us an e-mail to:

service@wiltec.info

or use our contact form:

<https://www.wiltec.de/contacts/>

The most recent version of this manual in several languages can be found in our online shop:

<https://www.wiltec.de/docsearch>

Our postal address is:

WilTec Wildanger Technik GmbH
Königsbenden 12
52249 Eschweiler Germany

Retourenabteilung
WilTec Wildanger Technik GmbH
Königsbenden 28
52249 Eschweiler Germany

E-mail: **service@wiltec.info**
Phone: +49 2403 55592-0
Fax: (+49 2403 55592-15)

Introduction

Thank you for choosing to purchase this quality product. To minimise the risk of injury, we ask you to always take some basic safety precautions when using this product. Please read this operating manual carefully and make sure that you understand it. Keep these operation instructions in a safe place.

Parts list

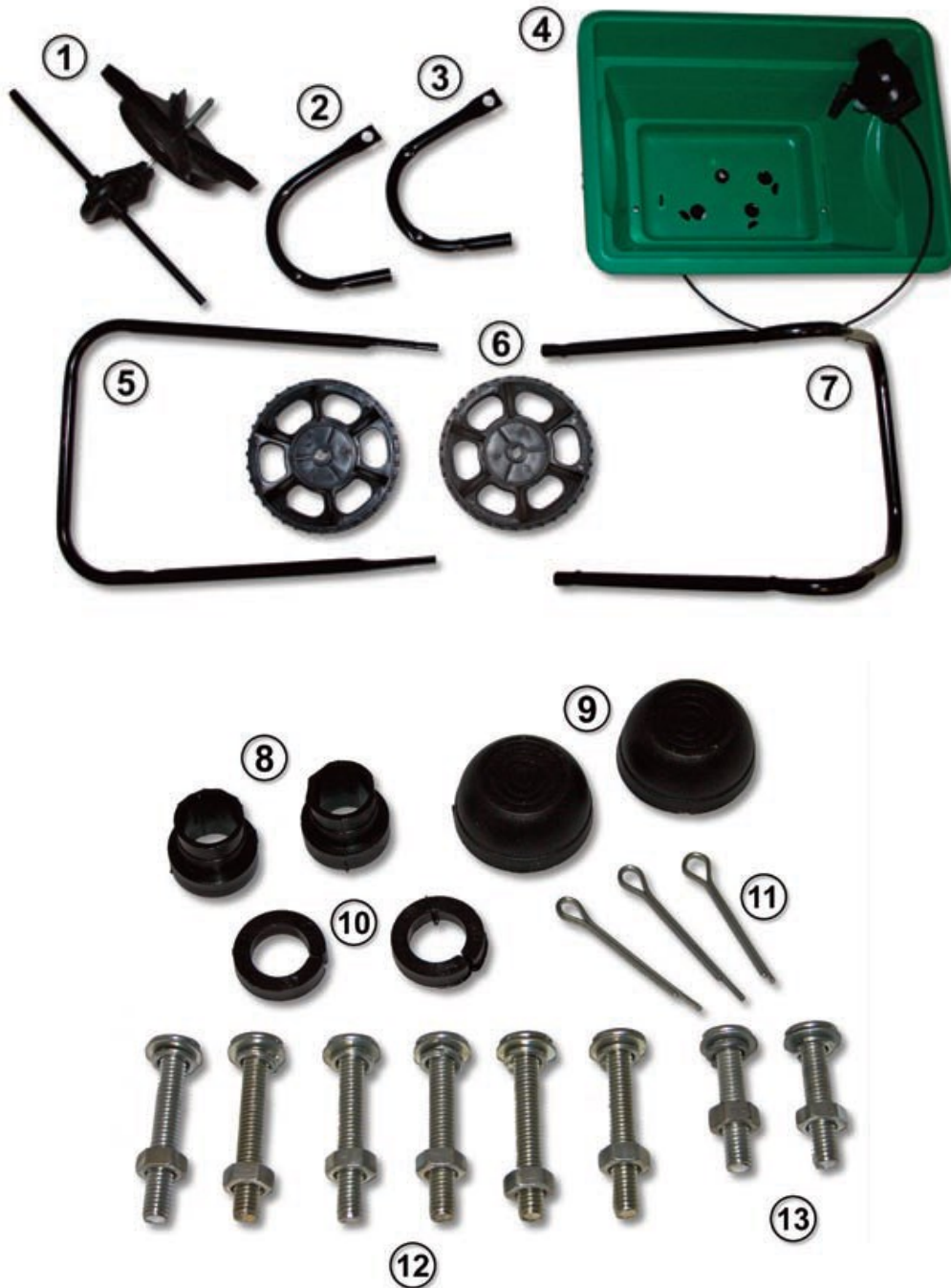

Assembly

Step 1

Assemble the handle (7) and its extension (5) with the help of the screws (13) as depicted.



Step 2

Slide the parts (8) and then parts (2) and (3) on one end of both axles (1). Now fix the wheels with each one ring (10) and one cotter (11).

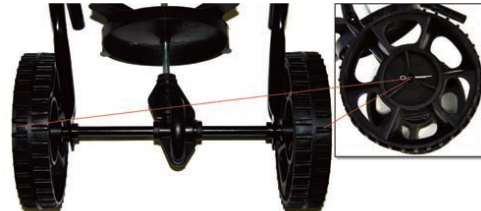

Step 3

Now, as depicted, fix the axle and spreading disc under the grit hopper (4) with the help of the screws (12).



Step 4

Now the handle assembled in step 1 is screwed into the axle construction (12). Make sure that the Bowden cable can be guided up between the bars after assembly.

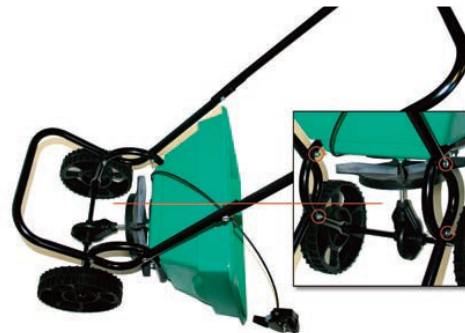

Step 5

The last step consists of fixing the driving unit to the grit hopper with the help of the remaining cotter (11). Mount the decorative caps (9) to the wheels and fix the adjusting switch to the handle bar.



Important Note: Reproduction and any commercial use (of parts) of this operating manual requires a written permission of WilTec Wildanger Technik GmbH.