

Operation Manual

Mitre-box Saw

51331



Illustration similar, may vary depending on model

Read and follow the operating instructions and safety information before using for the first time.

Technical changes reserved!

Due to further developments, illustrations, functioning steps, and technical data can differ insignificantly.

Updating the documentation

If you have suggestions for improvement or have found any irregularities, please contact us.



The information contained in this document may alter at any time without previous notice. It is prohibited to copy or spread any parts of this document in any way without prior written allowance. All rights reserved.

The WilTec Wildanger Technik GmbH cannot be held accountable for any possible mistakes in this operating manual, nor in the diagrams and figures shown.

Even though, the WilTec Wildanger Technik GmbH has undergone biggest possible efforts to ensure that the operating manual is complete, faultless, and up to date, mistakes cannot be entirely avoided.

If you should find a mistake or wish to make a suggestion for improvement, we look forward to hearing from you.

Send an e-mail to:

service@wiltec.info

or use our contact form:

<https://www.wiltec.de/contacts/>

The most recent version of this manual in various languages can be found in our online shop via:

<https://www.wiltec.de/docsearch>

Our postal address is:

WilTec Wildanger Technik GmbH
Königsbenden 12
52249 Eschweiler
Germany

To return orders for exchange, repair, or other purposes, please use the following address. Attention! To allow for a smooth execution of your complaint or return, it is important to contact our customer service team before returning the goods.

Returns Department
WilTec Wildanger Technik GmbH
Königsbenden 28
52249 Eschweiler

E-mail: **service@wiltec.info**

Tel: +49 2403 55592-0

Fax: +49 2403 55592-15



Introduction



Thank you for purchasing this quality product. **To minimise the risk of injury we urge that our clients take some basic safety precautions when using this device. Please read the operation instructions carefully and make sure you have understood its content.**

Keep these operation instructions safe.

Field of application

This product is intended for performing multi-angle cuts on materials such as wood, bamboo, plastic or aluminium.

Safety instructions

- Always make sure to keep your working area clean and well-lit. Cluttered or dark working areas greatly increase the risk of accidents.
- Check the saw as well as its saw blade for signs of damage or wear before each use. Damaged or worn-out parts must be exchanged before the saw is used.
- The saw blade must be sharp and requires enough free punch. Always replace blunt saw blades before using the saw.
-  **Attention!** Always be attentive when handling this saw or the work pieces. Saw blades and sharp edges of work pieces can lead to injuries.
-   Always make sure to wear appropriate safety equipment such as safety glasses and cut-resistant safety gloves when using this tool.
- Make sure to always keep a safe distance between the saw blade and your fingers and do not reach into the blade while performing cuts.
- Do not attempt to saw materials others than the material recommended.
- When mounting a work piece, make sure that it does not suffer from tension and that it has been placed properly to guarantee a precise and secure handling of the saw.
- Keep bystanders away from the working area while working with the tool, as distractions may lead to a loss of control. Furthermore, always keep the tool and its packaging inaccessible to children.
- The saw blade of this mitre-box saw should be removed when the tool is stored and both should be stored in a dry environment and inaccessible to children.

Technical specifications

Max. cutting width (mm)	with 45°	110
	with 90°	160
Max. cutting height (mm)		120
Saw blade length (mm)		600
Saw blade width (mm)		45
Mitre-cutting angle (°)		between -45 and +45 (stepless adjustment)

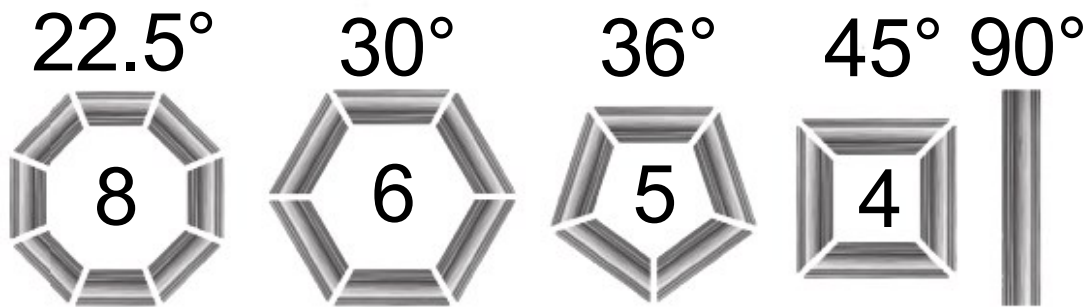

1. **Saw table:** The sturdy saw table consists of high-quality cast iron covered by a layer of rust protection varnish. Aside from the pre-set angles shown above, the angle can be adjusted manually with help of the angle adjusting screw.
2. **Saw blade:** The saw blade included in the scope of delivery is intended for cutting wood and can easily be exchanged.
3. **Cutting depth adjustment:** The cutting depth can be adjusted manually in order to meet your demands.
4. **Guide bar:** Four guide bars ensure an exact, stable and secure handling of the saw.

Assembly and adjustment

First, remove the saw and its parts from its packaging, check its integrity, and carefully read the operation manual. Check every part before setting this product up.

1. Place the base plate (5) on the end of the saw table (15) and attach it with help of the seat screw (8).



Attention: The seat screw (8) should be tightly attached with help of a screw-wrench to prevent the screw from loosening during the daily use.

2. Place the pivot spindle (10) into the round hole of the angle plate (9) and turn the saw table (15) in a manner that causes its underside face upwards. Then carefully attach the pivot spindle (10) to the saw table (15) with the help of a wooden hammer. Fasten the pivot spindle (10) with the angle adjusting screw (14) by putting the same into the respective hole of the angle plate (9). Mount the locator (12) to the angle plate (9) and fix it in place with the locator screw (11). Afterwards insert the screws to ensure that the angle plate (9) is reliably and permanently connected to the saw table (15).



Attention: The clearance between the left, the right, the upper and lower parts the angle plate (9) and the saw table (15) should not be too large to enable a perpendicular position between saw blade (18) and the saw table (15).

3. Adjust the cutting depth setting (3) with help of the guide bar and fix the adjusting screw (4) before then adjusting the saw mount (17) according to your demands by using the guide bars.
4. Screw the vertical (2) and the horizontal vice (1) to the saw table (15) in a position matching the requirements of your task.

Use

1. To horizontally adjust the cutting angle, lightly lift the saw at its handle (16) and set the angle plate (9) to the desired angle. Adjust and fix the cutting depths setting (3) to regulate the cutting depth.
2. To vertically adjust the cutting angle, loosen the screws on both sides of the angle plate (9), bring the saw the saw to the desired position and once again tighten the screws. Please consider the maximum cutting angle and make sure to use the cutting depth setting (3) to ensure that the saw does not damage the surface of the sawing table.

3. Insert the work pieces and securely fix them in place with help of the horizontal (1) and vertical (2) vices to ensure a clean and secure sawing process.

Maintenance and storage

1. Apply some lubricating oil or rust preventive oil on to the saw blade to protect it from corrosion and to reduce the friction while sawing.
2. After cleaning the mitre-box saw make sure to store it within a dry environment. It is advised to apply a protective layer of lubricant onto the metal surfaces, if the tool is stored for longer period of times.
3. The mitre-box saw should be maintained regularly to ensure a consistent and efficient operation.

Attention!

- Before beginning the cutting process, make sure to mark the parts you wish to cut. Please only exert light pressure on the saw blade during the sawing process.
- Do not use damaged or deformed saw blades.
- Always make sure to replace worn-out parts before continuing to work with this tool.
- Only use original saw blades to guarantee perfect compatibility as well as adequate quality.

Exploded view and parts list

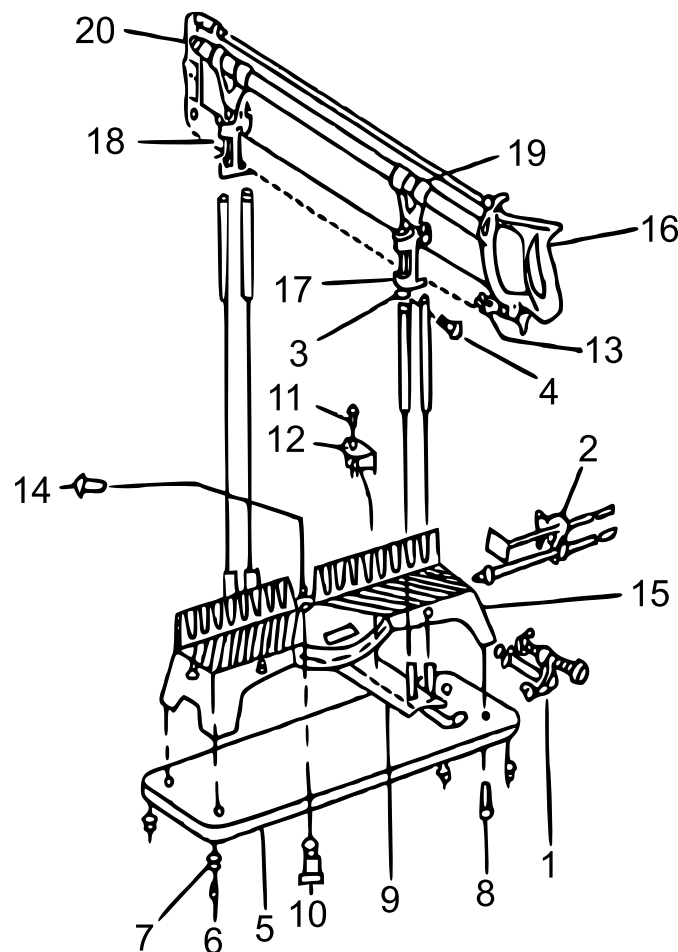

Nº	Name	Nº	Name
1	Horizontal vice	11	Locator screw
2	Vertical vice	12	Locator



3	Cutting depth setting	13	Saw blade bolt
4	Adjusting screw	14	Angle adjusting screw
5	Base plate	15	Saw table
6	Screw	16	Handle
7	Distance rubber	17	Saw mount
8	Seat screw	18	Saw blade
9	Angle plate	19	Support
10	Pivot spindle	20	End piece

Important notice:

The reprint or reproduction, even of excerpts, and any commercial use, even in part, of this instruction manual require the written permission of WilTec Wildanger Technik GmbH.