

# Instruction manual

## UV Filter Fountain CUF-2800, CUF-3800, CUF-4800, CUF-5800 55557–55560



Illustration similar, may vary depending on model

Please read and follow the operating instructions and safety information prior to initial operation.

Technical changes reserved!

Illustrations, functional steps and technical data may deviate insignificantly due to continuous further developments.



The information contained in this document may alter at any time without prior notice. No part of this document may be copied or otherwise duplicated without prior written consent. All rights reserved. WilTec Wildanger Technik GmbH cannot be held liable for any possible mistakes in this operating manual, nor in the diagrams and illustrations shown.

Although WilTec Wildanger Technik GmbH has made every possible effort to ensure that this operating manual is complete, accurate, and up-to-date, errors cannot be ruled out entirely.

If you have found an error or wish to suggest an improvement, we look forward to hearing from you.

Send us an e-mail to:

[service@wiltec.info](mailto:service@wiltec.info)

or use our contact form:

<https://www.wiltec.de/contacts/>

The most recent version of this manual in several languages can be found in our online shop:

<https://www.wiltec.de/docsearch>

Our postal address is:

WilTec Wildanger Technik GmbH  
Königsbenden 12  
52249 Eschweiler Germany

To return your goods for exchange, repair, or other purposes, please use the following address. Attention! To allow for a trouble-free complaint or return, it is important to contact our customer service team before returning your goods.

Retourenabteilung  
WilTec Wildanger Technik GmbH  
Königsbenden 28  
52249 Eschweiler Germany

E-mail: **service@wiltec.info**

Phone: +49 2403 55592-0

Fax: (+49 2403 55592-15)



## Introduction

Thank you for choosing to purchase this quality product. To minimise the risk of injury, we ask you to always take some basic safety precautions when using this product. Please read this operating manual carefully and make sure that you understand it.

Keep these operation instructions in a safe place.

### **Warning!**

Read the manual and familiarize yourself with the device before using it. The correct and safe use of the system requires the absolute compliance with the safety instructions. Children and young people under the age of 16 as well as users not able to be aware of potential hazards or not sufficiently familiar with this manual are not allowed to use this device.

## Features

- This elaborate and compact product allows for filtering, clarifying, and pumping water, building up a culture of biochemical bacteria, and fulfilling other functions in one single device.
- Large filtering area, suitable water flow conduct with amazing efficiency
- Filter material box integrated and independent, allowing for a simple replacing and adding different biochemical filter material
- Filtering media (no. 11, 12, and 13 on the exploded view) separately available and stackable to stretch the maintenance cycle
- Suitable for ponds

## Safety instructions

**Attention!** The CUF series product are combinable UVC clarifying devices. They comprise a water pump and a UV-C lamp. Every damage to the device and every incorrect use of it lead to dangerous radiation getting in contact with skin and eyes. The device being damaged, it must not be used any longer. This device is not intended to be used by persons (including children) with reduced physical or mental abilities or with a lack of experience and knowledge, unless they be supervised and/or instructed by a person responsible for their safety. The device should be placed out of children's reach.

- This device must be placed in the water. Make sure that the device is completely immersed in the water at a spot whose depth does not exceed 2 m.
- If there is not enough water to completely immerse the device, never plug in the plug; thus, you avoid dry running (operation without water) and damages to the device.
- For the UVC lamp is made of fragile quartz crystal glass, avoid dropping or tapping the device.
- Before all parts are completely assembled, the device must not be plugged in.
- If the power cable, the UVC lamp, or the housing is damaged, the device must not be operated.
- Make sure that the existing mains voltage and frequency match the specifications on the nameplate of the device.
- When installing the device, you must respect the installation regulations for pond pumps.
- The device must be earthed. The earthing should be controlled by a qualified electrician. For safety reasons, we recommend installing a leakage protection.
- Do not pull out the plug by pulling the power cable. Keep the cable away from heat, oil, or sharp edges.
- If the pump makes unusual noises, disconnect it from the mains and try to find the reason.
- With frost danger, remove the UVC filter to avoid frost damages.
- A dirty quartz crystal glass tube affects the efficiency of the device; thus, regularly and timely clean the quartz crystal glass tube.
- If the housing of the device is clogged with sand or other deposits, the quartz crystal glass tube and water pump might be damaged. Therefore, put the filter sponge into the water outlet. The filter sponge must regularly be cleaned (once a month).



- UVC radiation is harmful to eyes and skin. Do not look directly into the lamp and do not allow your skin to get in contact with the radiation.
- Before installing or repairing the device, pull out the plug.

## Notes

- This device is equipped with a filter sponge, a basket for biochemical bacteria, a UVC lamp, and a water pump. It has an appropriate water conduct suitable for both indoor and outdoor use, for garden ponds, pisciculture ponds, for clarifying water and for operating water fountains.
- Large filtering area, suitable water flow conduct with amazing efficiency
- The UVC lamp is designed as a closed device; no UVC radiation can escape. The UVC radiation, having a wavelength of 253.7 nm, kills harmful bacteria and algae whereby the water is clarified.

## Technical specifications

| Model<br>(item number)      | Voltage (V)<br>and frequency (Hz) | Power (W) | UVC power<br>(W) | Max. lifting<br>height (m) | Max. flow<br>rate (l/h) | Connections (cm)                                 |
|-----------------------------|-----------------------------------|-----------|------------------|----------------------------|-------------------------|--|
| <b>CUF-2800<br/>(55557)</b> | 220–240/50                        | 30        | 11               | 2,0                        | 2800                    | 2.54/3.30<br>( <sup>3</sup> / <sub>4</sub> "/1") |
| <b>CUF-3800<br/>(55558)</b> |                                   | 35        |                  | 2,8                        | 3600                    |  |
| <b>CUF-4800<br/>(55559)</b> |                                   | 45        |                  | 4                          | 4500                    |  |
| <b>CUF-5800<br/>(55560)</b> |                                   | 55        |                  | 4,8                        | 5200                    |  |

## Exploded view and parts list

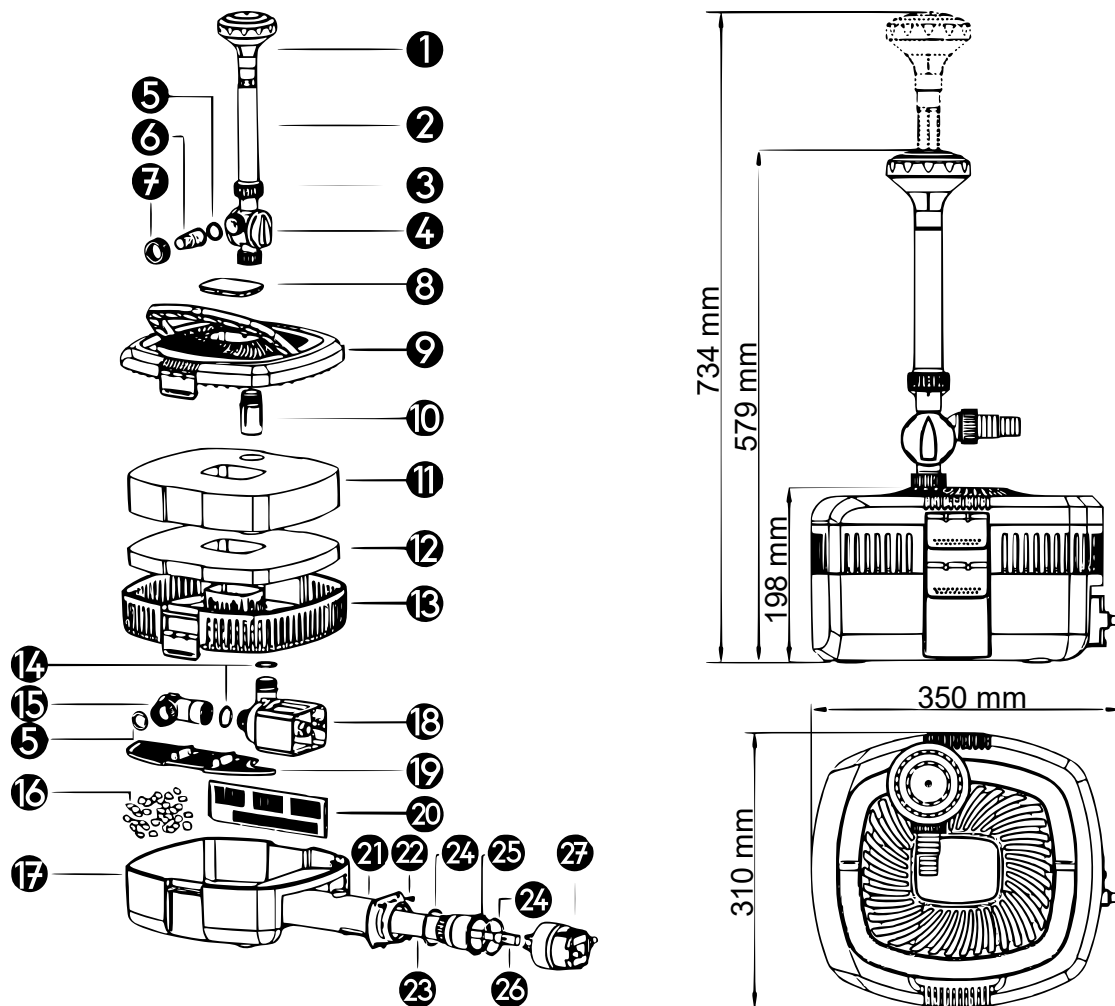

| No | Name          | No | Name                | No | Name               | No | Name                        |
|----|---------------|----|---------------------|----|--------------------|----|-----------------------------|
| 1  | Nozzle        | 8  | UV control window   | 15 | Curved connection  | 22 | Screw                       |
| 2  | Flexible hose | 9  | Upper filter cover  | 16 | Filter material    | 23 | Quartz crystal glass tube   |
| 3  | Nut           | 10 | Connection thread   | 17 | Lower filter cover | 24 | O-ring 2                    |
| 4  | T connection  | 11 | Rough sponge        | 18 | Pump motor         | 25 | Quartz crystal glass sleeve |
| 5  | Gasket        | 12 | Fine sponge         | 19 | Divider 1          | 26 | UV lamp                     |
| 6  | Outlet        | 13 | Middle filter cover | 20 | Divider 2          | 27 | UVC head with connection    |
| 7  | Cap nut       | 14 | O-ring 1            | 21 | UV light housing   |    |                             |



## **Assembly and maintenance**

Switch off the power when you will clean the inner parts of the device or replace the UVC lamp. Consider the above parts list.

### *Assembly*

After having assembled the parts of the fountain in accordance to the exploded view, adjust the extension tube to the appropriate height and immerge the device into the water. If the pump is intended to pump clean water, you can remove the fountain construction and connect the water outlet conduct.

### *Maintenance*

#### Filter sponge and material:

1. Remove the parts of the fountain and open the clamps on both sides of the filter cover; then you can open the filter cover.
2. Remove the filter sponge and material(s), clean them or replace them (it is advisable to clean the filter sponge weekly).

#### UVC lamp:

1. Open the pump and remove the UVC lamp. Open the safety lock and turn the lamp head counter-clockwise to remove the quartz crystal glass tube construction. Now you can replace the UVC lamp (with CUF-2800 series, the pump does not need to be opened, simply turn the lamp head counter-clockwise to remove).
2. If you should want to clean the quartz crystal glass tube, remove the fastening nut and take out the tube for cleaning.

#### Water pump:

1. Turn the rotor cover counter-clockwise until it snaps, open it outward to separate the rotor cover from the pump housing.
2. Remove the rotor and clean all parts with the small brush.

## **Winter storage**

1. Take out the device of the water.
2. Thoroughly clean the device.
3. Check all parts and the condition of the device.
4. Keep the device safe from frost and inside a container filled with clean water.

## **Highly fragile parts**

1. UVC lamp
2. Filter material (bioballs, gravel, filter sponge).



## Trouble shooting

| Problem                     | Possible cause                           | Solution                     |
|-----------------------------|--|------------------------------|
| Water pump does not run.    | Lack of power                            | Connect to mains.            |
|                             | Burnt out                                | Replace water pump.          |
|                             | Rotor clogged                            | Remove obstruction.          |
| Water pump loud             | Rotor clogged                            | Remove obstruction.          |
|                             | Rotor or shaft worn                      | Replace rotor or shaft.      |
| Lack of water in water pump | Damaged rotor or closed water flow valve | Replace rotor or open valve. |
|                             | Device inlet or water pump inlet clogged | Remove obstruction.          |
|                             | Voltage too low                          | Use appropriate voltage.     |
| UVC lamp does not work      | Lack of power                            | Connect to mains.            |
|                             | Damaged UVC lamp                         | Replace UVC lamp.            |
|                             | Bad connection of UVC lamp               | Replace UVC lamp.            |



## Regulations for waste disposal

The Waste Electrical and Electronic Equipment Directive (WEEE Directive, 2012/19/EU) of the EU was implemented in the German law related to electrical and electronic equipment and appliances.

All WilTec electric devices that fall under the WEEE directive are labelled with the symbol of a crossed-out wheeled rubbish bin. This symbol indicates that this electric device must not be disposed of with the domestic waste.

WilTec Technik GmbH is registered with the German registration authority EAR (Stiftung Elektro-Altgeräte Register) under the WEEE-registration number DE45283704.

Disposal of used electrical and electronic devices (intended for use in the countries of the European Union and other European countries with a separate waste collection system for these devices).

The symbol on the packaging or the product itself indicates that this product must not be treated as normal domestic waste but must be disposed of at a recycling collection station for electrical and electronic waste.

By disposing of this product correctly, you contribute to the protection of the environment and the health of your fellow people. Inappropriate disposal threatens the environment and health.

Material recycling helps to reduce the consumption of raw materials.

Additional information about the recycling of this product can be provided by your local commune, the municipal waste disposal facilities, or the store where you purchased the product.

Address:  
WilTec Wildanger Technik GmbH  
Königsbenden 12 / 28  
52249 Eschweiler Germany

### Important Note:

Reproduction and any commercial use (of parts) of this operating manual require a written permission of WilTec Wildanger Technik GmbH.