

# Operation Manual

## Manual Tyre Changer 61309



Illustration similar, may vary depending on model

Read and follow the operating instructions and safety information before using for the first time.

Technical changes reserved!

Due to further developments, illustrations, functioning steps, and technical data can differ insignificantly.

Updating the documentation

If you have suggestions for improvement or have found any irregularities, please contact us.



The information contained in this document may alter at any time without previous notice. It is prohibited to copy or spread any parts of this document in any way without prior written allowance. All rights reserved.

The WilTec Wildanger Technik GmbH cannot be held accountable for any possible mistakes in this operating manual, nor in the diagrams and figures shown.

Even though, the WilTec Wildanger Technik GmbH has undergone biggest possible efforts to ensure that the operating manual is complete, faultless, and up to date, mistakes cannot be entirely avoided.

If you should find a mistake or wish to make a suggestion for improvement, we look forward to hearing from you.

Send an e-mail to:

[service@wiltec.info](mailto:service@wiltec.info)

or use our contact form:

<https://www.wiltec.de/contacts/>

The most recent version of this manual in various languages can be found in our online shop via:

<https://www.wiltec.de/docsearch>

Our postal address is:

WilTec Wildanger Technik GmbH  
Königsbenden 12  
52249 Eschweiler  
Germany

To return orders for exchange, repair, or other purposes, please use the following address. Attention! To allow for a smooth execution of your complaint or return, it is important to contact our customer service team before returning the goods.

Returns Department  
WilTec Wildanger Technik GmbH  
Königsbenden 28  
52249 Eschweiler

E-mail: **service@wiltec.info**

Tel: +49 2403 55592-0

Fax: +49 2403 55592-15



## Introduction

Thank you for purchasing this quality product. **To minimise the risk of injury we urge that our clients take some basic safety precautions when using this device. Please read the operation instructions carefully and make sure you have understood its content.**

Keep these operation instructions safe.

## Safety notes

- Read all safety notes and instructions and make sure that you have understood them. Non-compliance with the instructions can lead to serious injury. Keep the operating manual for future reference.
- Keep the work area clean and well lit. Untidy workbenches and dark areas invite accidents. Keep bystanders and children away when operating the tool. Distractions can lead to a loss of control. If required, keep barriers or shields ready.
- Ensure that the tyre changer is placed on an even and solid surface holding the weight of the device including the tyre and other equipment used.
- Do not let children or other unauthorised people operate the tyre changer or play with it.
- Do not operate the tyre changer with force. The device will work better and more safely if operated with the speed and capacity that it is designed for.
- Read and follow all safety notes and instructions found in the tyre manufacturer's manuals before operating the tyre changer.
- Use the right tools for the individual tasks needing to be carried out. Do not try to use a smaller tool to carry out the work of a bigger industrial tool. There are specific purposes for which this tool has been designed. It will carry the work out better and in a safer speed, when used as designated. Do not modify this device in any way and do not use it for anything else other than its intended purpose.
- Always be careful. Pay attention to what you are doing and be cautious when using tools and devices. Do not use tools and devices if tired or under the influence of alcohol, drugs, or medicine.
- Even a short moment of inattentiveness when handling a tool or machinery can lead to serious injury.
- Wear adequate clothing. Do not wear any loose clothing or jewellery. Tie long hair together.
- Do not lean over too far. Make sure to have a stable footing and always to be able to keep your balance. A secure footing and balance allow better control of the device if anything unforeseen happens.
- Use a protective equipment. Wear protective glasses and full-face protection when assembling or operating the device.
- Examine the tyre changer before every use. Check for loose screws, misalignment, or jammed moving parts, etc. Also check for parts torn or broken and unusual noises or vibrations. Have any problems checked and, if necessary, repaired before operating the device again. Do not use damaged devices.

## Quad and ATV tyres

- **Note:** Quad/ATV tyres are more difficult to mount and demount due to their small diameter. But also, the tyres are soft and bend easily when pressing the side walls slightly.
- If the bead breaker **(10)** slips off the tyre, hold it in its place and work your way around the rim to press the side walls down step for step.
- Place lubricant between the tyre and the rim so that it can slide off easier.
- If the tyre has a high rim with a small inner diameter so that the rim does not reach above the round plate of the centre post **(1)** and cannot be placed on the spider post **(4)** or if the lug pin **(3)** runs through the hole, you should still be able to use the device to mount and dismount the tyres. Most rims are tightened via the post cap. With the cap on, one should still be able to hold the rim in its place to be able to mount and dismount the tyre as mentioned.

**Explosion view and parts list**

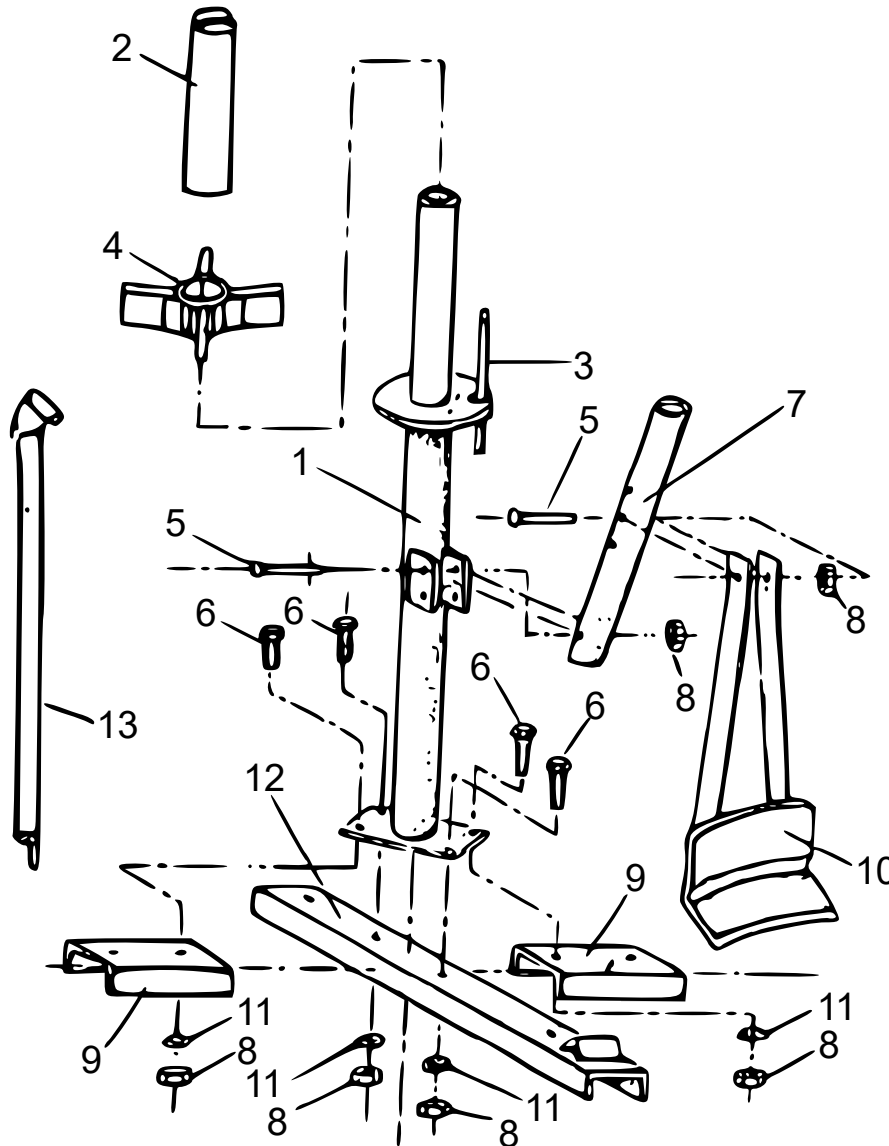

Nº	Name	Qty.	Nº	Name	Qty.
1	Centre post	1	8	Hexagonal nut (M10)	6
2	Post cap	1	9	Side bases	2
3	Lug pin	1	10	Bead breaker	1
4	Spider post	1	11	Lock washer	4
5	Hexagonal screw (M10×65)	4	12	Post base	1
6	Big hexagonal screw (M10×25)	4	13	Mounting/demounting bar	1
7	Bead breaker handle	1			



## Assembly and operating instructions

### Technical specifications

<b>Sizes (cm)</b>	<b>Application</b>	Suitable for all tyres measuring 20.3 cm (8") and light lorries, such as 19 cm (7.5") × 40.6 cm (16") and flotation tyres up to 31.8 cm (12.5") L × 40.6 cm (16").
	<b>Basis</b>	38.1 × 45.72
	<b>Holes for ground mounting</b>	∅ 1.1 (7/16") (4 pieces)
	<b>Mounting/demounting bar</b>	94 (37") L × ∅ 5 (15/16")
	<b>Support surface for the tyre</b>	∅ 19 (7 1/2") × 0.47 (3/16") (thickness)
	<b>Legs</b>	3.81 (1 1/2") × 7.62 (3") × 0.38 (0.15") (wall rail)
	<b>Centre post</b>	7.3 (2 7/8")

### Removal of tyres

1. Before starting, use a rubber lubricant (not included in the delivery) to simplify the mounting and dismounting of the bead/tyre.
2. Deflate the tyre entirely.
3. To be able to push the bead off the tyre rim, lay the tyre flat onto the base. The triangular stopper ensures that the tyre cannot slide.
4. Place the flat end of the mounting/demounting bar **(13)** into the bead breaker handle **(7)**.
5. Place the bead breaker **(10)** on the tyre against the side of the rim. During the process, it might be possible that the height of the bead breaker needs to be adjusted. This is done by removing the screws **(5)** and then placing the bead breaker on the right height. Then place the screws back again.
6. To remove the bead from the rim, push the mounting/demounting bar **(13)** down. If the bead does not come off at once, turn the tyre over and try it in several places again.
7. Turn the tyre around and repeat the steps 1–6.

### Mounting and dismounting tyres

1. After the bead has been removed, place the tyre with the valve stem upward on the machine and the lug pin **(3)**, which pokes out of the rim.
2. Place the spider post **(4)** onto the centre post **(1)** with the conical side, which goes into the wheel hub.
3. Screw the post cap **(2)** onto the centre post **(1)**. Lock the spider post **(4)** by hand. Tightening it by hand should be sufficient. However, if you do require more strength, place the flat end of the mounting/demounting bar **(13)** through the top side of the post cap and use additional leverage force to remove the post cap further.
4. As soon as the tyre is securely held in place, push the flat end of the mounting/demounting bar **(13)** between the tyre and the rim. This should be carried out with the flat end.
5. Work your way around the centre post **(1)** with the mounting/demounting bar **(13)** to demount the bead entirely.
6. Pull the tyre to the upper side of the bead. Then place the flat end of the mounting/demounting bar **(13)** between tyre and rim as previously done. Repeat the process to remove the tyre from the rim entirely.
7. Repair the tyre. Then mount the tyre back to the rim again.
8. Hang the end of the mounting/demounting bar **(13)** over the edge of the rim.
9. Press the tyre forward over the edge of the rim in the spot where the mounting/demounting bar **(13)** is placed.
10. Position the side wall so that it slides over the flat bit of the end on the hook of the mounting/demounting bar **(13)**.
11. Push the tyre against the rim by hand. With the other hand, pull the mounting bar **(13)** clockwise around the centre post **(1)** until the side wall begins to mount to the rim. It should only be moved



by a few centimetres until you can let go of the tyre and can use both hands on the mounting/demounting bar.

12. Continue around the rim until the tyre is mounted over the edge of the bead. Repeat this procedure on the second side wall, to mount the tyre entirely.

**Important!** As soon as the side wall starts to sit whilst mounting the tyre, it needs to stretch more and thus is harder to mount. To avoid this, push the tyre down so that it cannot sit on the top edge of the rim.

**Note:** The bead, which is located on the upper side of the mounting/demounting bar **(13)**, holds the bar hooked into the edge of the rim. The tyre bead is on the upper side (flat piece of the mounting end of the bar) and against the bent lug pin **(3)** when you mount the tyre to the rim.

Important notice:

The reprint or reproduction, even of excerpts, and any commercial use, even in part, of this instruction manual require the written permission of WiITec Wildanger Technik GmbH.