

Operation Manual

Hand Lever Shears

61577-61579



Illustration similar, may vary depending on model

Read and follow the operating instructions and safety information before using for the first time.

Technical changes reserved!

Due to further developments, illustrations, functioning steps, and technical data can differ insignificantly.

Updating the documentation

If you have suggestions for improvement or have found any irregularities, please contact us.



The information contained in this document may alter at any time without previous notice. It is prohibited to copy or spread any parts of this document in any way without prior written allowance. All rights reserved.

The WilTec Wildanger Technik GmbH cannot be held accountable for any possible mistakes in this operating manual, nor in the diagrams and figures shown.

Even though, the WilTec Wildanger Technik GmbH has undergone biggest possible efforts to ensure that the operating manual is complete, faultless, and up to date, mistakes cannot be entirely avoided.

If you should find a mistake or wish to make a suggestion for improvement, we look forward to hearing from you.

Send an e-mail to:

service@wiltec.info

or use our contact form:

<https://www.wiltec.de/contacts/>

The most recent version of this manual in various languages can be found in our online shop via:

<https://www.wiltec.de/docsearch>

Our postal address is:

WilTec Wildanger Technik GmbH
Königsbenden 12
52249 Eschweiler
Germany

To return orders for exchange, repair, or other purposes, please use the following address. Attention! To allow for a smooth execution of your complaint or return, it is important to contact our customer service team before returning the goods.

Returns Department
WilTec Wildanger Technik GmbH
Königsbenden 28
52249 Eschweiler

E-mail: **service@wiltec.info**

Tel: +49 2403 55592-0

Fax: +49 2403 55592-15



Introduction

Thank you for purchasing this quality product. **To minimise the risk of injury we urge that our clients take some basic safety precautions when using this device. Please read the operation instructions carefully and make sure you have understood its content.**

Keep these operation instructions safe.

Warning: Read carefully and understand all assembly and operating instructions before operating. Failure to follow the safety rules and other basic safety precautions may result in serious personal injury.

These 125 mm (5"), 200 mm (8") and 300 mm (12") plate shears are designed for certain applications only. The manufacturer is not responsible for problems arising from the modification or use of these products in an application for which they were not designed. We strongly recommend that these products not be modified and/ or used for any application other than that for which they were designed.

Intended use

The 125 mm (5"), 200 mm (8") and 300 mm (12") plate shears are suitable for shearing carbon steel plate and can also be used to shear non-ferrous metals or plastic plate and bar.

Technical specifications

Item number		61577	61578	61579
Blade	Length (mm)	approx. 125	approx. 200	approx. 300
	Width (mm)	6		
Cutting capacity	Sheet metal and steel (mm)	70 × 6		
	Round steel (mm)	11	13	
Weight (kg)		10	18	25

Important safety information



Warning!

- Read and understand all instructions. Failure to follow all instructions may result in serious injury.
- The warnings, cautions and instructions in this manual cannot cover all possible conditions or situations that could occur. Exercise common sense and caution when using this tool.
- Always be aware of the environment and ensure that the tool is used in a safe and responsible manner.
- Do not allow people to operate or assemble this product until they have read this manual and have developed a thorough understanding of how the product works.
- Do not modify the product in any way. Unauthorised modification may impair the function and/or safety and could affect the lifespan of the product. There are specific applications for which the product was designed.
- Use the right tool for the job. Do not attempt to force a smaller tool to do the work of larger industrial tool. There are certain applications for which this equipment is designed. It will do the job better and more safely at the capacity for which it was intended. Do not use this equipment for a purpose for which it was not intended.



Work area safety

Warning!

- Inspect the work area before each use. Keep the work area clean, dry, free of clutter and well lit. Cluttered, wet, or dark work areas can result in injury. Using the tool in confined work areas may put you dangerously close to other cutting tools and rotating parts.
- Do not use the tool in areas which have a risk of causing a fire or an explosion, e.g., in the presence of flammable liquids, gases, or dust. The tool can create sparks, which may ignite the dust or fumes.
- Do not allow the tool to come in contact with an electrical source. Contact will cause a shock.
- Keep children and bystanders away from the work area while operating the tool. Do not allow children to play with the tool.
- Be aware of all power lines, electrical circuits, water pipes, and other hazards in your work area. Some of these hazards may be below the work surface hidden from your view and may cause personal harm or property damage if unintentionally contacted.

Personal safety

- Stay alert, concentrate on what you are doing, and use common sense when operating the tool. Do not use the tool while you are tired or under the influence of drugs, alcohol, or medicine. A moment of inattention while operating the tool may result in serious personal injury.
- Dress properly. Do not wear loose clothing, dangling objects, or jewellery. Keep your hair, clothing, and gloves away from moving parts. Loose clothes, jewellery or long hair can be caught.
- Use safety goggles or safety glasses with side shields or when needed, a face shield. Use a dust mask in dusty work conditions. Also use non-skid safety shoes, hard hat, gloves, dust collection systems and hearing protection when necessary. This applies to all people in the work area.
- Do not overreach. Always keep proper footing and balance.
- Secure the work with clamps or a vice instead of your hand when practical. This safety precaution allows for proper tool operation using both hands.

Use and care of the shears

Caution!

- Do not apply too much force when using the tool. Tools work better and more safely when used for the purpose for which they are designed. Plan your work and use the correct tool for the work to do.
- Check for damaged parts before each use. Carefully check that the tool will operate properly and perform for its intended function. Replace damaged or worn parts immediately. Never operate the tool with a damaged part.
- Store the tool when it is not in use. Store it in a dry, secure place out of the reach of children. Inspect the tool for a good working condition prior to storage and before re-use.
- Only use equipment that is recommended by the manufacturer for use with your tool. Equipment that may be suitable for one tool may create a risk of injury when used with another tool. Never use equipment that has a lower operating speed or operating pressure than the tool itself.

Specific operation warnings

Warning

- Blade Hazard. Keep hands clear from the blade when operating.
- Wear the proper safety gear including safety glasses and gloves.
- Fasten the shears to a sturdy, level surface that can hold the load of the shears and workpiece before use.
- The shears blades are very sharp! Keep body parts away from the cutting area or serious injury might result.
- **Note:** If the material seems too thick or too hard, do not force the shears to cut! Instead, use a metal-cutting band saw to cut the workpiece.



Assembly

When first unpacking the shears from its shipping container, make sure that all parts are fully equipped and not damaged (see the parts list for reference). The anti-rust grease on processing surfaces and other parts can be removed with kerosene or another suitable degreaser.

To assemble and mount your shears, follow the steps below:

1. Secure the handle to the plate shears assembly using the included hex bolts and flat washers, as shown in the diagram.
2. Place the shears on the workbench and use the holes in the base as a guide for drilling and attaching the shears to the workbench.
3. We recommend using long hex bolts that go through the workbench and are secured from the other side with flat washers and hex nuts, if possible. If it is not possible to use through bolts, use lag screws with flat washers and fasten the screws directly into the workbench.

Before each usage

Check the shears for wear or damaged parts and that they are debris-free to perform properly. Periodically check if the shears are still securely held in place. Re-secure them when required.

Usage

Warning: Read and understand this manual to understand the equipment structure and principle before operating the shears. Failure to understand and follow all instructions may result in serious injury.

Note: The shears should be mounted on a hard surface or specific stand (not supplied). Leave enough room around machine for ease of operating and to avoid injury.

- Before shearing, adjust the hold-down disc **(12)** to secure the workpiece.
- When ready to shear, raise the handle **(10)**, the upper blade **(4)** will rise.
- Insert the workpiece and position it as desired.
- Pull the handle down to shear the workpiece.

After each usage

Clear away any debris from the previously use to prepare for the device for the next use.

Maintenance

- Do maintain your tool. It is recommended that the general condition of any tool be examined before it is used.
- Keep your tool in good repair by adopting a program of conscientious repair and maintenance in accordance with the recommended procedures found in this manual. Keep all cutting tools sharp and clean.
- Properly maintained cutting tools with sharp cutting edges are less likely to bind and are easier to control.
- Keep handles dry, clean, and free from oil and grease. Lubricate the rotating parts of the shears every day.

Exploded view and parts list

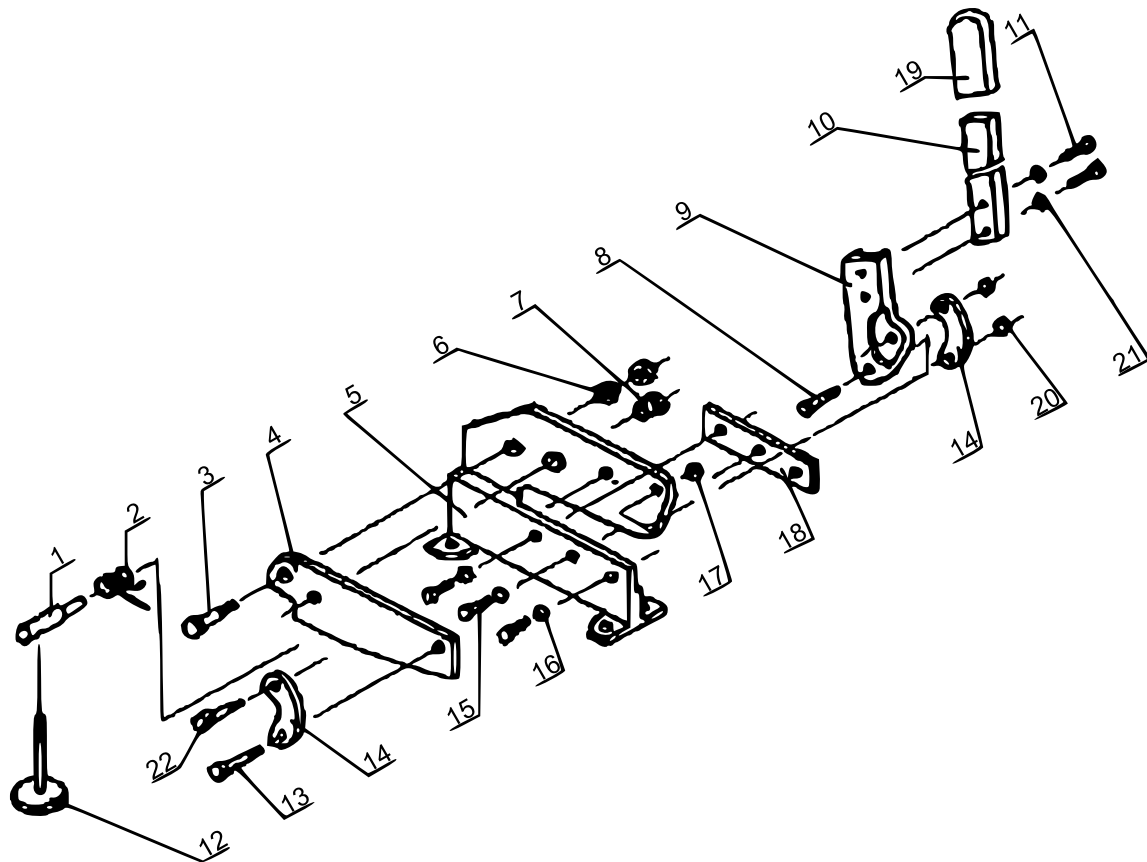

No	Name	Qty.	No	Name	Qty.
1	Shaft	1	12	Disc	1
2	Spring	1	13	Screw	1
3	Bolt	1	14	Rocker	1
4	Upper blade	1	15	Screw	3
5	Body	1	16	Washer	3
6	Nut	2	17	Nut	1
7	Sleeve	1	18	Lower blade	1
8	Screw	1	19	Rocker	1
9	Lever	1	21	Nut	2
10	Handle	1	21	Washer	2
11	Screw	2	22	Screw	1

Important notice:

The reprint or reproduction, even of excerpts, and any commercial use, even in part, of this instruction manual require the written permission of WilTec Wildanger Technik GmbH.