

Operation Manual

Cutting Stand for One-hand Angle Grinder

61823



Illustration similar, may vary depending on model

Read and follow the operating instructions and safety information before using for the first time.

Technical changes reserved!

Due to further developments, illustrations, functioning steps and technical data can differ insignificantly.

Updating the documentation

If you have suggestions for improvement or have found any irregularities, please contact us.

The information contained in this document may alter at any time without previous notice. It is prohibited to copy or spread any parts of this document in any way without prior written allowance. All rights reserved.

The WilTec Wildanger Technik GmbH cannot be held accountable for any possible mistakes in this operating manual, nor in the diagrams and figures shown.

Even though, the WilTec Wildanger Technik GmbH has undergone biggest possible efforts to ensure that the operating manual is complete, faultless and up to date, mistakes cannot be entirely avoided.

If you should find a mistake or wish to make a suggestion for improvement, we look forward to hearing from you.

Send an e-mail to:

service@wiltec.info

or use our contact form:

<https://www.wiltec.de/contacts/>

The most recent version of this manual in various languages can be found in our online shop via:

<https://www.wiltec.de/docsearch>

Our postal address is:

WilTec Wildanger Technik GmbH
Königsbenden 12
52249 Eschweiler
Germany

Do you wish to pick goods up? Our pick-up address is:

WilTec Wildanger Technik GmbH
Königsbenden 28
52249 Eschweiler
Germany

To shorten the waiting time and allow for a rapid on-site transaction, we ask you to call us previously or placing your order via the webshop.

E-mail: service@wiltec.info
Tel: +49 2403 55592-0
Fax: +49 2403 55592-15

To return orders for exchange, repair or for other purposes, please use the following address. Attention! To allow for a smooth execution of your complaint or return, it is important to contact our customer service team before returning the goods.

Returns Department
WilTec Wildanger Technik GmbH
Königsbenden 28
52249 Eschweiler

E-mail: service@wiltec.info
Tel: +49 2403 55592-0
Fax: +49 2403 55592-15



Introduction

Thank you for purchasing this quality product. **To minimize the risk of injury we urge that our clients take some basic safety precautions when using this device. Please read the operation instructions carefully and make sure you have understood its content.**

Keep these operation instructions safe.

Safety precautions

Warning! It is important to follow the precautions below to avoid electrical shock, accident, and other difficulties when using the cutting stand with a power tool.

- Carefully read these safety instructions and carefully follow all notes and instructions. Keep the instructions in a safe place so that you can refer to them at any time.
- Also follow the instructions of the manufacturer of the power tools that you want to use with the cutting stand.
- The stand must be attached to a workbench before use.
- Keep your work area tidy. Untidy work areas can lead to accidents and injuries.
- Only use the device in a well-lit area and only on a stable, level surface. The work area should also be dry, well ventilated and not in the immediate vicinity of flammable substances. It should also have enough space.
- Make sure that no unauthorized persons are in your work area or near the device while you are working with it.
- Never use the device in a damp or wet environment. Never expose it to the rain.
- The use of the device by children or untrained persons is prohibited.
- Carefully check that all parts listed in the exploded view are present and undamaged. If this is not the case, the device must not be used.
- Wear appropriate work clothing, e.g., protective goggles, a dust-proof face mask and suitable safety gloves.
- When you are not using the device, store it in a dry, safe place or a lockable area and always out of the reach of children.
- Make sure that accessories are not damaged.
- Never use the holder for tools that are not suitable for it.
- Make sure that all adjustment keys have been removed before using the tool.
- Never use blunt or damaged tools.
- Never use the tool and the respective accessories for purposes or work for which they are not intended.
- Never remove parts of the device, e.g., the spindle protection.
- Regularly check that all screws and bolts are tightened.
- Make sure that the tool is properly attached to the stand before use.
- Never overload the tool.
- Make sure that you are standing on a stable surface during use. Always keep your balance when using the tool.
- Always disconnect the tool from the power supply when it is not in use and before servicing it or replacing an accessory.
- Carefully proceed in all work and stop working if you feel exhausted.
- Never pull the plug out of the socket by the cable. Keep the power cord away from heat, oil and sharp edges.
- Always check that all parts of the tool are operational and working properly and that all moving parts and safety devices are tightened.
- If possible, hold workpieces with a clamp.
- The tools must be mounted optimally and be able to rotate freely.
- If you notice that the power cord has been cut or damaged, do not touch it. Pull the plug out of the socket. Never use tools with a damaged power cord.
- Make sure that the power cord is always at a certain distance from the stand and the immediate work area.



- Check the bracket screws and nuts every 3 hours. Make sure that they are tightened securely.
- Before plugging in the power plug, make sure that the power tool switch is in the off position.
- Let the drill run idle for a few minutes before starting work.
- Never stop the tool with your hands or other objects.
- Never overload the tool and make sure that it always works without undue stress.
- Follow the instructions of the manufacturer of the power tool and the grinding wheels used. Only use angle grinders with a max. grinding wheel cutting speed of 80 m/s.
- Only use grinding wheels with specifications for cutting ferrous and low-alloy materials, pipes and sections with a maximum cutting speed of 80 m/s.
- Never use circular saw blades or ceramic grinding discs.

Recommendations for use and application

- When cutting wheels are used, the guard must be fitted to the carrier, the protective cover to the power tool.
- The protective cover of the power tool be always oriented so that it can protect the user from a potential explosion.
- Avoid working from an unstable position.
- Grinding wheels must always be stored in a dry place where they cannot be hit or fall down.
- Assure yourself of the perfect condition of the grinding wheel used. Perform a sound test to ensure that the grinding wheel is not making a sound indicating damage.
- Use cutting wheels with a maximum diameter of 230 mm and never allow them to wear out over 80 mm.
- Only use grinding wheels with a speed equalling at least the one of the power tool idling.
- The grinding tools used must always be properly installed and be able to rotate freely. Immediately stop using deformed or vibrating grinding wheels.
- Replace all worn grinding wheels before they touch the mounting plates of the grinder or when they have been subjected to impact.
- Never work on materials such as glass, ceramics, plastic, wood, etc.
- The workpiece must always be securely clamped before work.
- Never exert lateral pressure on cut-off wheels.

Technical specifications

Max. work piece size (mm)	metal sheets, tubes from ferrous alloy	60 × 40
	round bars	30
Suitable for angle grinders with	a max. grinding wheel speed (m/s)	80
	handle attachments (mm)	min. 95–max. 115

Exploded view and parts list

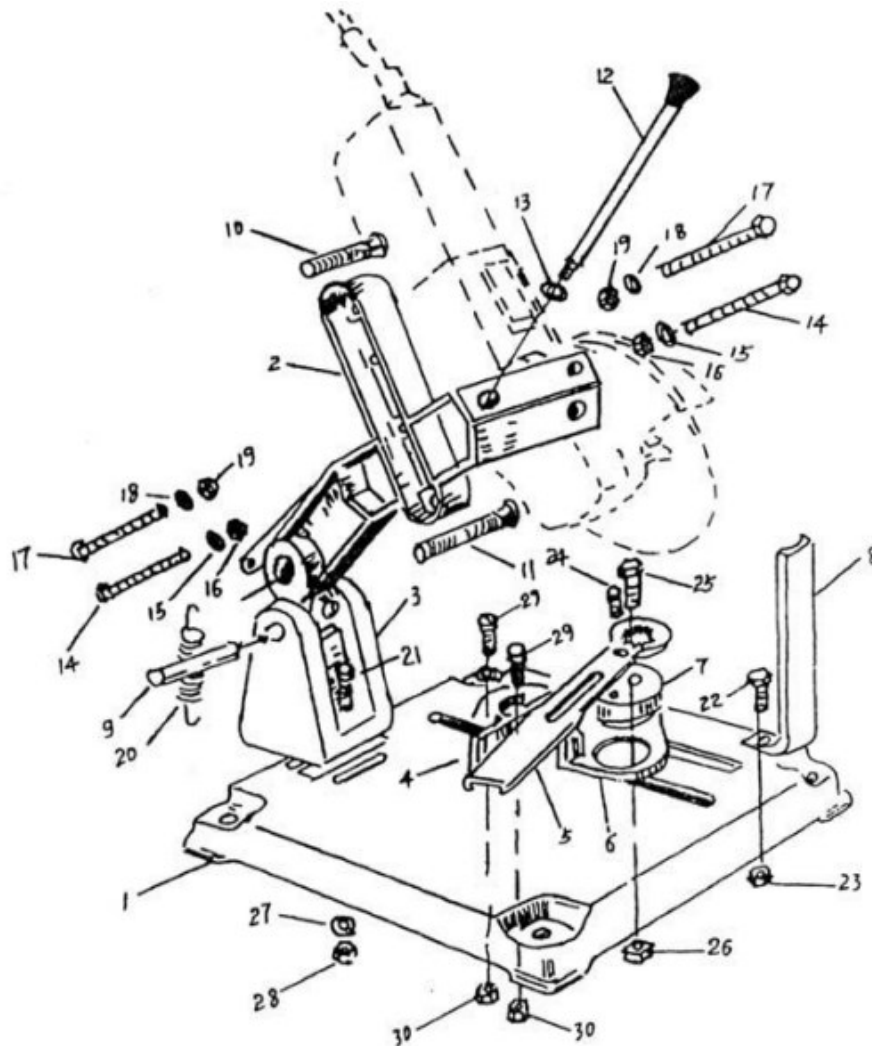

No	Name	No	Name	No	Name
1	Base	11	Long screw	21	Screw M8×20
2	Support	12	Handle	22	Screw M8×10
3	Support base	13	Washer 8 mm	23	Nut M8
4	Locating bracket	14	Screw M10×8	24	Screw M6×10
5	Screw wrench	15	Washer 10 mm	25	Screw M8×30
6	Clamp	16	Nut M10	26	Square nut M8
7	Rotating unit	17	Screw M8×50	27	Washer 8 mm
8	Cap	18	Washer 8 mm	28	Nut M8
9	Piston	19	Nut M8	29	Nut M20
10	Short screw	20	Spring	30	Nut M8

Important notice: The reprint or reproduction, even of excerpts, and any commercial use, even in part, of this instruction manual require the written permission of WiITec Wildanger Technik GmbH.