

Operating instructions

Three-Roll Bending Machine

62059



Illustration similar, may vary depending on model

Read and follow the operating instructions and safety information prior to initial operation.

Technical changes reserved!

Illustrations, functional steps, and technical data may deviate insignificantly due to continuous further developments.

Updating the documentation

If you have suggestions for improvement or have found any irregularities, please contact us.



The information contained in this document may alter at any time without prior notice. No part of this document may be copied or otherwise duplicated without prior written consent. All rights reserved. WilTec Wildanger Technik GmbH cannot be held liable for any possible mistakes in this operating manual, nor in the diagrams and illustrations shown.

Although WilTec Wildanger Technik GmbH has made every possible effort to ensure that this operating manual is complete, accurate, and up-to-date, errors cannot be ruled out entirely.

If you have found an error or wish to suggest an improvement, we look forward to hearing from you. Send us an e-mail to:

service@wiltec.info

or use our contact form:

<https://www.wiltec.de/contacts/>

The most recent version of this manual in several languages can be found in our online shop:

<https://www.wiltec.de/docsearch>

Our postal address is:

WilTec Wildanger Technik GmbH
Königsbenden 12
52249 Eschweiler – Germany

To return your goods for exchange, repair, or other purposes, please use the following address. Attention! To allow for a trouble-free complaint or return, it is important to contact our customer service team before returning your goods.

Retourenabteilung
WilTec Wildanger Technik GmbH
Königsbenden 28
52249 Eschweiler – Germany

E-mail: **service@wiltec.info**

Tel: +49 2403 55592-0

Fax: +49 2403 55592-15



Introduction

Thank you for choosing to purchase this quality product. To minimise the risk of injury, we ask you to always take some basic safety precautions when using this product. Please read this operating manual carefully and make sure that you understand it.

Keep these operation instructions in a safe place.

Safety instructions

- Do not use the device when being tired or under the influence of alcohol, drugs, or medicine. Read the warnings on the package leaflet for your medicine to find out whether your judgement and reflexes will be affected by taking it.
- Do not wear loose items of clothing or jewellery. These could be caught by the machine.
- Wear protective gloves and non-slip footwear.
- Cover long hair with a hairnet or other suitable headgear.
- Wear hearing protection and protect your eyes with approved safety goggles.
- Stand in such a way that you always keep your balance and cannot slip.
- Use the tool that matches the respective job to do. Do not try to force a small tool to do a job that requires a large industrial tool.
- Do not modify the device and do not use it for a purpose for which it has not been manufactured.
- For safety reasons, have the appliance serviced by a specialist.
- Keep the work area tidy, clean, and sufficiently lit.
- Only work in a dry environment protected from moisture and rain to avoid the risk of injury, damage to the device, fire, or electric shock.
- Never allow children to use the device.
- The device is supplied pre-assembled. When you unpack it, check for loose parts in the packaging. If parts are damaged or missing, contact the seller or another specialist.

Use

1. Attach the device to a workbench using the screws **(24)**.
2. Before using the device, make sure that it is properly attached and adjusted. Turn the handle **(19, 20)** and check that the two drive wheels **(5)** engage securely. The three shafts should be clean, with no metal residue adhering to them.
3. Adjust the distance between the first shaft **(10)** and the second shaft **(9)** if necessary. This can be done using the adjusting screws **(12, 4)**. To reduce the distance, turn the two screws clockwise. To increase the distance, turn the two screws anti-clockwise.
4. Insert the steel plate between the first shaft **(10)** and the third shaft **(6)**. Tighten the locking screw **(8)**, the adjusting screw **(13)**, the screw **(14)**, and the press plate **(15)**.
5. Turn the handle **(19, 20)** while turning the nut **(3)**, the rod **(4)**, and the knob **(12)** and push the second shaft **(9)** higher depending on the diameter of the roller.
6. After bending, loosen the locking screw **(8)**, the adjusting screw **(13)**, and the screw **(4)**. Turn the press plate **(15)** half a turn, press the first shaft **(10)** upwards, and remove the steel plate from the right.

Exploded view and parts list

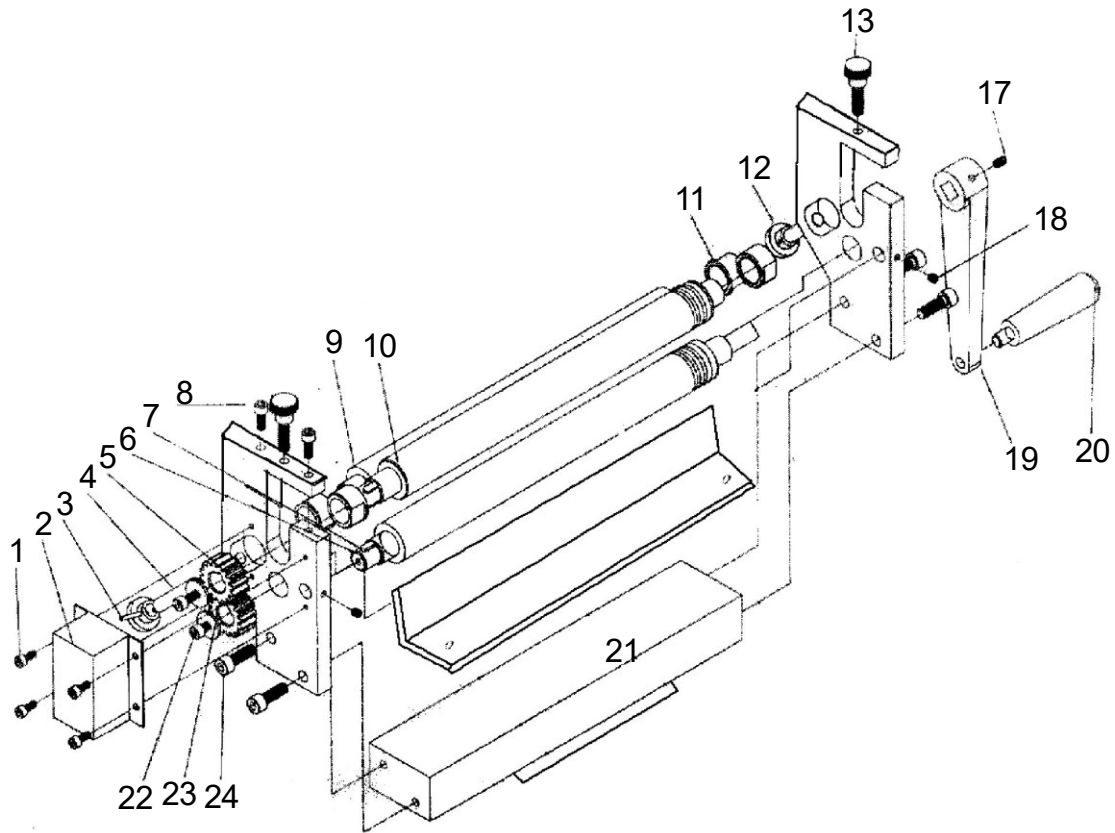

Nº	Name	Qty.	Nº	Name	Qty.
1	Screw M5×12	4	12	Knob 10×40	2
2	Shield	1	13	Adjusting screw	2
3	Nut 3×22	2	17	Screw M6×12	1
4	Bar	2	18	Locking screw M6×8	2
5	Driving wheel	2	19	Crank handle, part 1	1
6	Shaft 3	1	20	Crank handle, part 2, M10×80	1
7	Key 5×12	2	21	Base	1
8	Locking screw	2	22	M8×25 screw	4
9	Shaft 2	1	23	Washer	2
10	Shaft 1	1	24	M6×12 screw	2
11	Sleeve	4			

Important note:

Reproduction and any commercial use (of parts) of this operating manual, requires a written permission of WilTec Wildanger Technik GmbH.