

# User's manual

## Chain Hoist

62583, 62584, 62585, 62586, 62587, 62588, 62589, 62590, 62591, 62592



Illustration similar, may vary depending on model

Read and follow the operating instructions and safety information before using for the first time.

Technical changes reserved!

Illustrations, functional steps, and technical data may deviate insignificantly due to continuous further developments.

Updating the documentation

If you have suggestions for improvement or have found any irregularities, please contact us.



The information contained in this document may alter at any time without prior notice. No part of this document may be copied or otherwise duplicated without prior written consent. All rights reserved. WilTec Wildanger Technik GmbH cannot be held liable for any possible mistakes in this operating manual, nor in the diagrams and illustrations shown.

Although WilTec Wildanger Technik GmbH has made every possible effort to ensure that this operating manual is complete, accurate, and up-to-date, errors cannot be ruled out entirely.

If you have found an error or wish to suggest an improvement, we look forward to hearing from you. Send us an e-mail to:

[service@wiltec.info](mailto:service@wiltec.info)

or use our contact form:

<https://www.wiltec.de/contacts/>

The most recent version of this manual in several languages can be found in our online shop:

<https://www.wiltec.de/docsearch>

Our postal address is:

WilTec Wildanger Technik GmbH  
Königsbenden 12  
52249 Eschweiler Germany

To return your goods for exchange, repair, or other purposes, please use the following address. Attention! To allow for a trouble-free complaint or return, it is important to contact our customer service team before returning your goods.

Retourenabteilung  
WilTec Wildanger Technik GmbH  
Königsbenden 28  
52249 Eschweiler Germany

E-mail: **service@wiltec.info**  
Tel: +49 2403 55592-0  
Fax: +49 2403 55592-15



## Introduction

Thank you for choosing to purchase this quality product. To minimise the risk of injury, we ask you to always take some basic safety precautions when using this product. Please read this operating manual carefully and make sure that you understand it.

Keep these operation instructions in a safe place.

## Name

The chain hoist is a portable lifting device that can easily be operated via a hand chain. It is particularly suitable for operation in factories and mines, in agriculture, on construction sites, dockyards, landing stages, and for loading and unloading of goods. The chain hoist, being adjustable, can be fixed to any type of vehicle. It is suitable for overhead monorail tracks, manual cranes, and slewing cranes.

## Technical specifications

Item number		62583	62584	62585	62586	62587
Capacity (kg)		1000	2000	3000	5000	5000
Drum dimensions (mm)		145×145×130	145×145×130	180×180×155	200×200×160	200×200×160
Hook	Max. opening (mm)	20	25	40	40	
	Inner dimension (diameter) (mm)	30	40	65	60	
Chain	Thickness of load chain (mm)	6	6	10	10	10
	Thickness of pulling chain (mm)	4	4	4	4	
	Length (m)	3	3	3	5	5
Weight (kg)		8	11	19	30	39

Item number		62588	62589	62590	62591	62592
Capacity (kg)		1000	2000	3000	5000	5000
Drum dimensions (mm)		150×150×140	150×150×140	180×180×155	200×200×170	200×200×170
Hook	Max. opening (mm)	20	25	29	40	40
	Inner dimension (diameter) (mm)	30	40	44	65	60
Chain	Thickness of load chain (mm)	6	6	8	10	10
	Thickness of pulling chain (mm)	4	4	4	4	4
	Length (m)	3	3	3	3	5
Weight (kg)		8.5	11.5	19.5	30	39

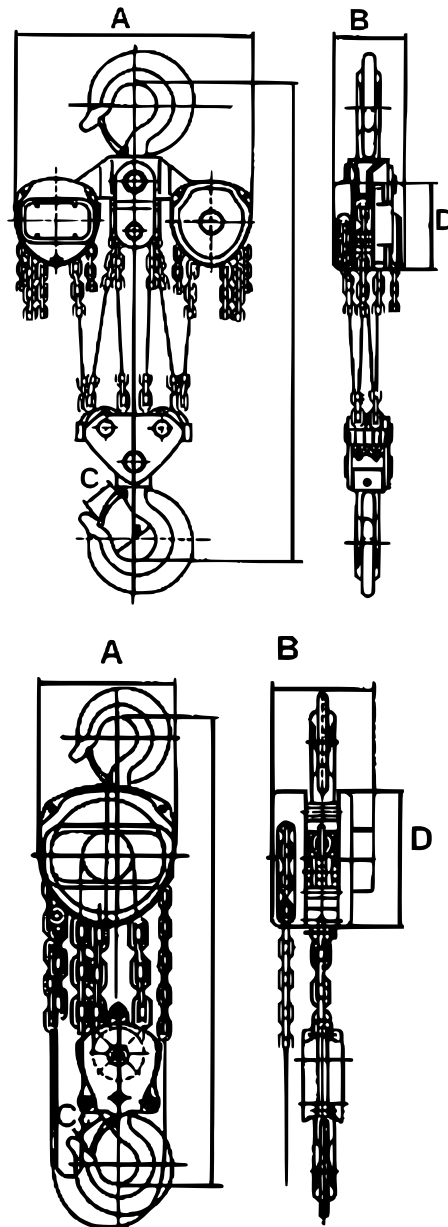

## Features

The chain hoist has the following 5 features due to its design and function:

- safe operation and easy maintenance
- high efficiency and small hand pull
- small weight and easy operation
- classy design and small size
- high robustness during operation

## Operation

The chain hoist is equipped with a transmission mechanism with two-stop cylindrical gears symmetrically disposed. Its functional principle is as follows: When one pulls the hand chain, the hand wheel turns clockwise, pressing the friction plates and ratchet disc firmly against the brake seat and causing these components to turn in common mode. The transmission shaft turns the disc wheel, pinion shaft, and



gear wheel, so that the load chain wheel mounted to the gear wheel moves the load chain for smooth and stable lifting (or pulling) of the load.

### Warnings

- Do under no circumstances exceed the max. admissible charge.
- The chain hoist can only be operated by persons.
- Make sure that the chain hoist, lubrication of the piece transmitted, and load chain are in good condition.
- Before lifting, check if the hooks are safely attached. Do not suspend a load to the hook anchor. The load chain should be vertical, straight, and torsion-free to work properly.
- During operation, the operator should be on the level of the hand wheel. To lift a load, pull the hand chain for turning the hand wheel clockwise. When pulling the hand chain in reverse direction, the load is lowered smoothly.
- For safety reasons, it is strictly forbidden that anybody be or work under a load lifted.
- When lifting or lowering a load, the hand chain should be pulled evenly to avoid any jerking or twisting.
- Immediately stop operation if the pulling force of the chain exceeds its normal-operation force. Then check
  - if there is anything caught in or at the load;
  - if there are problems with some parts of the block;
  - if the maximum capacity has been exceeded.

### Maintenance

- Remove dirt at the chain hoist, lubricate its components after use, and store it in a dry place.
- Only have it maintained and inspected by a qualified person. Never allow unqualified persons to dismount or mount the block.
- Align the “o” markings of both gear wheel mountings.
- When mounting the brake mechanism, make sure that the inclined teeth of the ratchet disc and ratchet engage. Make sure that the spring and ratchet work reliably and sensitively. Then turn the plates on the brake. Should there be a distance between the disc and plates, turn then counter-clockwise.
- After cleaning and repairing the block, it should be subject to an idle test and stress test. A chain hoist can be re-operated after being tested and found reliable and in good condition.
- Keep the friction surface of the brake clean. The brake mechanism should be tested regularly to avoid any incorrect braking and falling of the load.

### Parts lists

62583–62587

Nº	Name	Nº	Name	Nº	Name	Nº	Name
1	Load chain	11	Friction plate	21	Left side plate	31	Bent plate
2	Right side plate	12	Cylinder	22	Suspension sheet	32	Cylinder
3	Return stop A	13	Bearing bush	23	Suspension pin	33	Sheet cover
4	Chain wheel	14	Blocking ring	24	Scraper	34	Axle
5	Driving shaft	15	Hand chain	25	Spring ring	35	Needle
6	Gear wheel with spline	16	Ratchet	26	Pin	36	Idle disc
7	Driving shaft	17	Stop	27	Guide pulley	37	Hook holder



<b>8</b>	Disc gear	<b>18</b>	Hand wheel cover	<b>28</b>	Steel casing	<b>38</b>	Hook
<b>9</b>	Hand wheel	<b>19</b>	Circlip	<b>29</b>	Return stop B	<b>39</b>	Locking set
<b>10</b>	Brake seat	<b>20</b>	Ratchet bolt	<b>30</b>	Hook mounting	<b>40</b>	Double springing

62588–62592

<b>№</b>	<b>Name</b>	<b>№</b>	<b>Name</b>	<b>№</b>	<b>Name</b>	<b>№</b>	<b>Name</b>
<b>1</b>	Hand wheel cover	<b>13</b>	Rivet	<b>25</b>	Pin	<b>37</b>	Sheet cover
<b>2</b>	Nut	<b>14</b>	Upper hook hanger	<b>26</b>	Scraper	<b>38</b>	Nut
<b>3</b>	Pin	<b>15</b>	Bolt shaft	<b>27</b>	Nut	<b>39</b>	Washers
<b>4</b>	Hand wheel	<b>16</b>	Pull anchor	<b>28</b>	Suspension plate	<b>40</b>	Bolt
<b>5</b>	Friction plate	<b>17</b>	Right side plate	<b>29</b>	Suspension pin	<b>41</b>	Lower hook hanger
<b>6</b>	Ratchet disc	<b>18</b>	Bearing bush	<b>30</b>	Chain wheel	<b>42</b>	Guide shaft
<b>7</b>	Return stop	<b>19</b>	Rail tothing	<b>31</b>	Circlip	<b>43</b>	Needles
<b>8</b>	Return stop pin	<b>20</b>	Disc gear	<b>32</b>	Cylinder	<b>44</b>	Hook
<b>9</b>	Left side plate	<b>21</b>	Bent plate	<b>33</b>	Nut	<b>45</b>	Locking shaft
<b>10</b>	Spring	<b>22</b>	Hand chain	<b>34</b>	Rail gear	<b>46</b>	Traction sheave
<b>11</b>	Pin	<b>23</b>	Brake seat	<b>35</b>	Gear shaft	<b>47</b>	Load chain
<b>12</b>	River	<b>24</b>	Cylinder	<b>36</b>	Bearing bush		

Exploded view

62583-62587

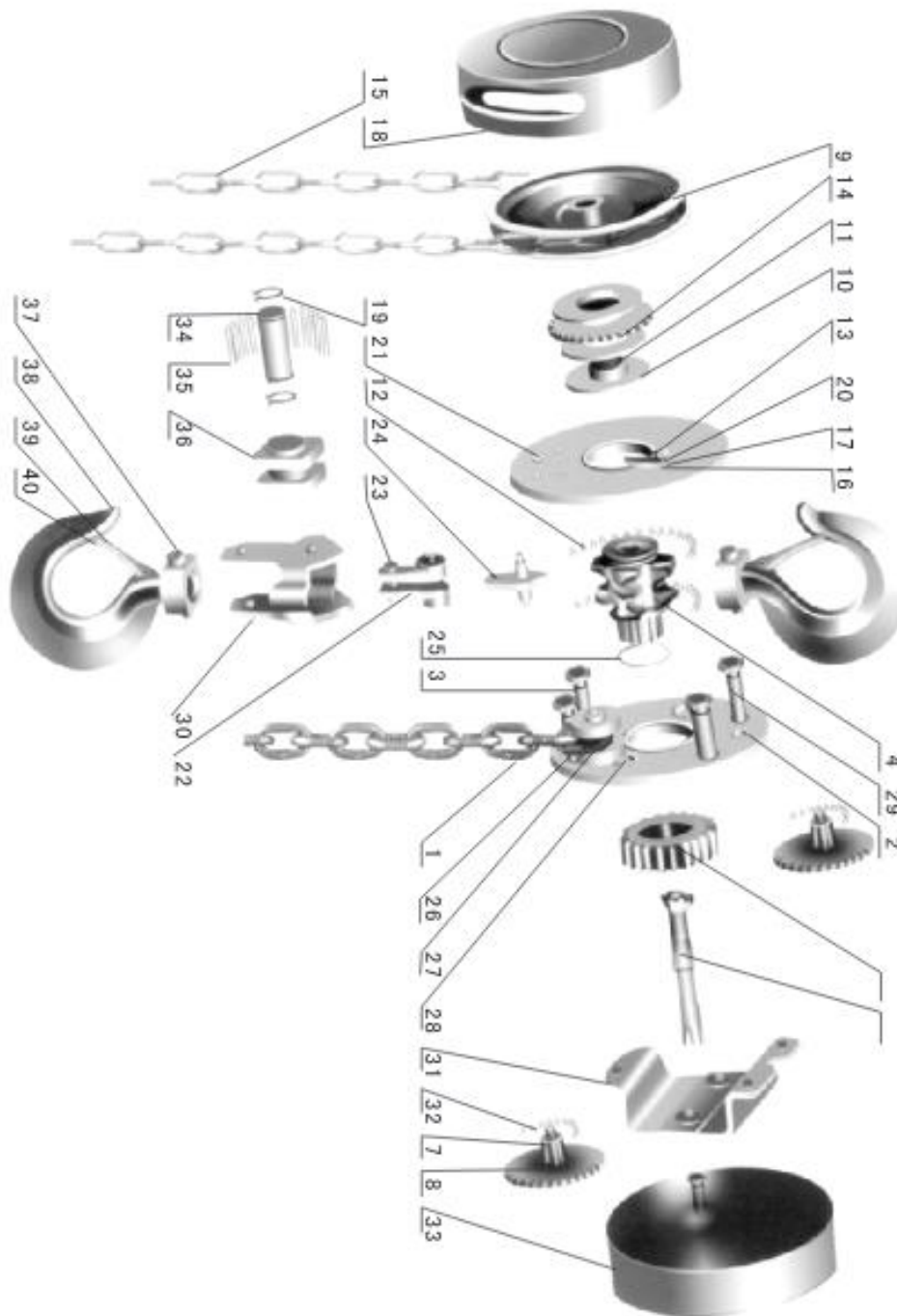

62588–62592

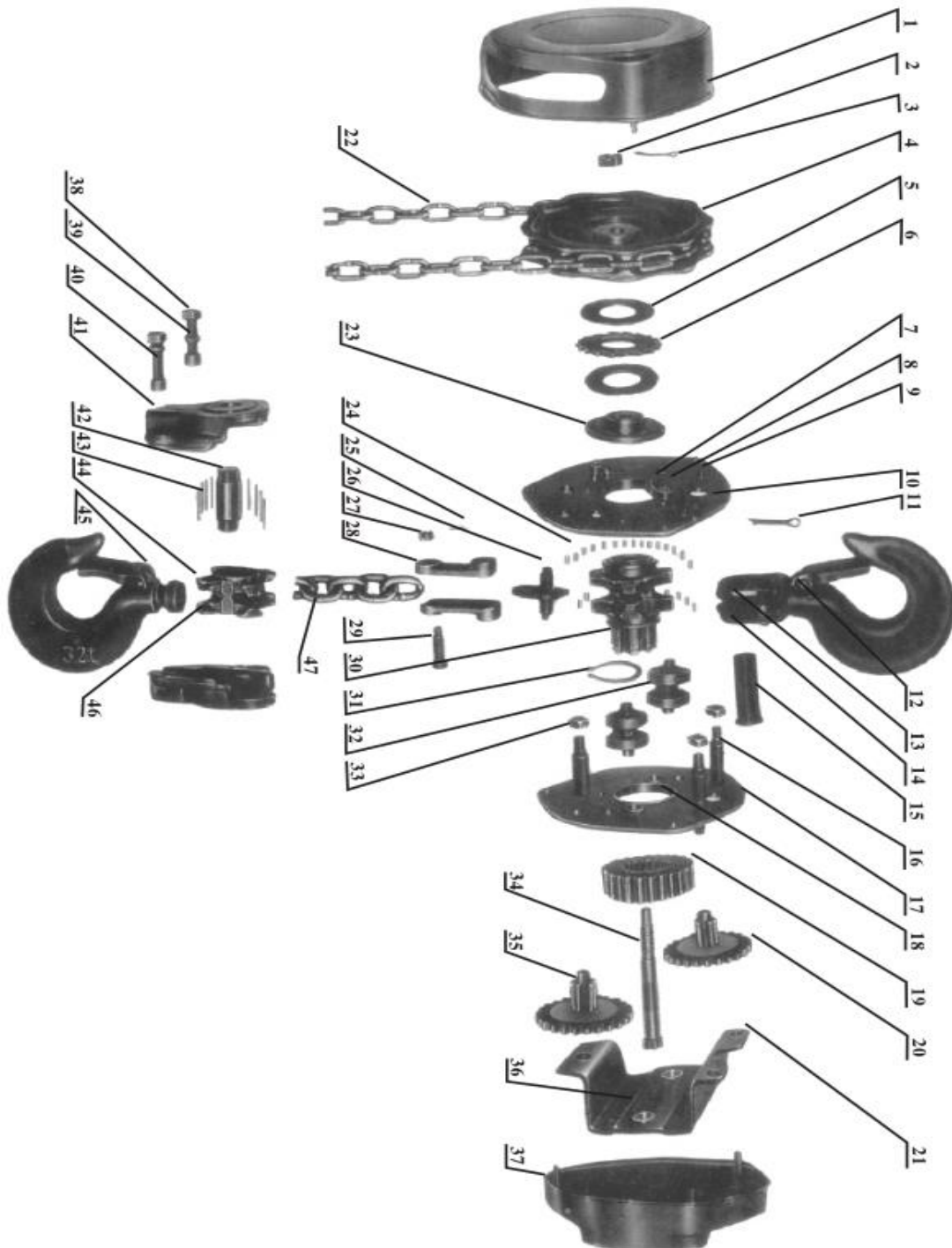

**Important Note:**

Reproduction and any commercial use (of parts) of this operating manual, requires a written permission of WilTec Wildanger Technik GmbH.