

# Operation Manual

## Toilet Waste Water Pump

62738



Illustration similar, may vary depending on model

Read and follow the operating instructions and safety information before using for the first time.

Technical changes reserved!

Due to further developments, illustrations, functioning steps, and technical data can differ insignificantly.

Updating the documentation

If you have suggestions for improvement or have found any irregularities, please contact us.



The information contained in this document may alter at any time without previous notice. It is prohibited to copy or spread any parts of this document in any way without prior written allowance. All rights reserved.

The WilTec Wildanger Technik GmbH cannot be held accountable for any possible mistakes in this operating manual, nor in the diagrams and figures shown.

Even though, the WilTec Wildanger Technik GmbH has undergone biggest possible efforts to ensure that the operating manual is complete, faultless, and up to date, mistakes cannot be entirely avoided.

If you should find a mistake or wish to make a suggestion for improvement, we look forward to hearing from you.

Send an e-mail to:

[service@wiltec.info](mailto:service@wiltec.info)

or use our contact form:

<https://www.wiltec.de/contacts/>

The most recent version of this manual in various languages can be found in our online shop via:

<https://www.wiltec.de/docsearch>

Our postal address is:

WilTec Wildanger Technik GmbH  
Königsbenden 12  
52249 Eschweiler  
Germany

To return orders for exchange, repair, or other purposes, please use the following address. Attention! To allow for a smooth execution of your complaint or return, it is important to contact our customer service team before returning the goods.

Returns Department  
WilTec Wildanger Technik GmbH  
Königsbenden 28  
52249 Eschweiler

E-mail: **service@wiltec.info**

Tel: +49 2403 55592-0

Fax: +49 2403 55592-15



## Introduction

Thank you for purchasing this quality product. **To minimise the risk of injury we urge that our clients take some basic safety precautions when using this device. Please read the operation instructions carefully and make sure you have understood its content.**

Keep these operation instructions safe.

## Safety instructions

### **CAUTION:**

This device is not intended to be used by persons (including children) with limited physical, sensory, or mental capabilities or lack of experience and/or knowledge, unless they are supervised by a person responsible for their safety or have received instructions on how to use the device. Children should be supervised to ensure that they do not play with it.

## Product description

The toilet waste water pump consists of a housing, a motor, and a pump. The pump is suitable for domestic sewage and sanitary facilities. The system automatically switches the pump on and off depending on the liquid level.

### **Caution!**

- Visually inspect the device on a regular term. Do not use it if safety devices are damaged or worn. Never override safety devices.
- Only use the device for the purpose specified in these operating instructions.
- You are responsible for the safety in the work area.
- If the cable or plug is damaged due to external influences, the device must not be used! The cable must first be exchanged for a new one. This work should only be carried out by a qualified electrician.
- The voltage of 230 V (50 Hz) AC indicated on the nameplate of the device must correspond to the existing mains voltage.
- Never lift, transport, or fix the device by the power cord.
- Make sure that the electrical plug connections are protected from flooding and moisture. Before working on the device, pull out the mains plug.
- Avoid exposing the device to direct water jets.
- The operator is responsible for compliance with local safety and installation regulations. You may ask a qualified electrician.
- The user must take appropriate measures to prevent consequential damage after a room is flooded in the event of malfunctions on the device (e.g., installation of an alarm system, reserve pump, etc.).
- If the device fails, repairs should only be carried out by a qualified electrician. No responsibility is accepted for damage caused by improper repairs or maintenance.
- The device must never run dry or be operated with the suction line completely closed. The warranty expires for damage to the device caused by dry running.
- The device must not be used to operate swimming pools.
- The device must not be installed in the drinking water circuit.

### **Warning!**

Read all safety warnings and instructions. Failure to follow the safety instructions could result in electric shock, fire, and/or serious injury. Keep all safety notices and instructions for future use.

### Technical specifications

<b>Power consumption (W)</b>	400
<b>Voltage (V)</b>	220–240
<b>Frequency (Hz)</b>	50
<b>Max. pump head (m)</b>	8.5
<b>Max. draw (m)</b>	85
<b>Max. water temperature (°C)</b>	90
<b>Max. flow rate (l<sub>min</sub>)</b>	135
<b>Heat protection (°C)</b>	90
<b>Noise level (dB (A))</b>	35–50
<b>Protection class</b>	IPX4

### Main components

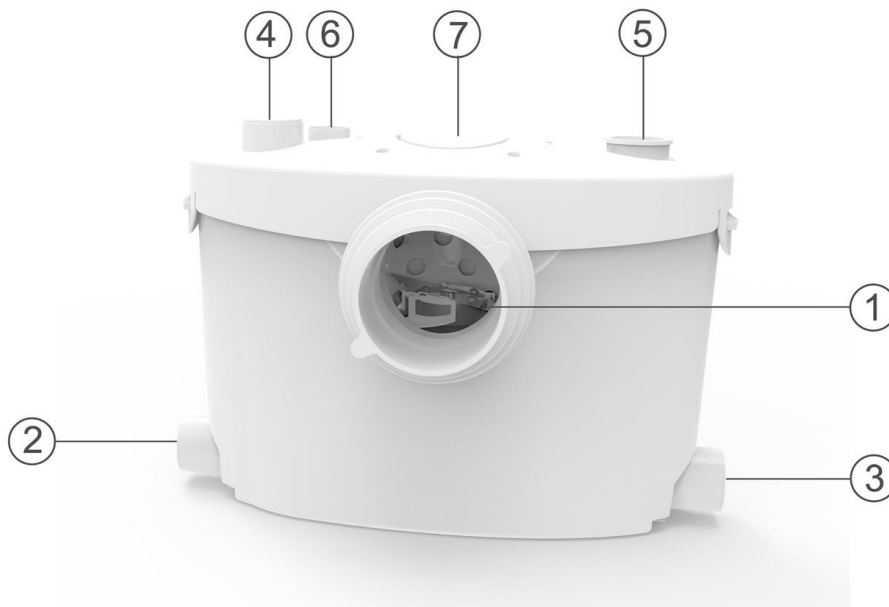

Nº	Name	Nº	Name
1	Toilet intake ø100 mm	5	Outlet ø 23/28/32/44 mm
2	Intake ø 40 mm	6	Vent
3	Intake ø 40 mm	7	Maintenance flap
4	Intake ø 40 mm (optional)		

**Figures**

*Figure 1: Size*

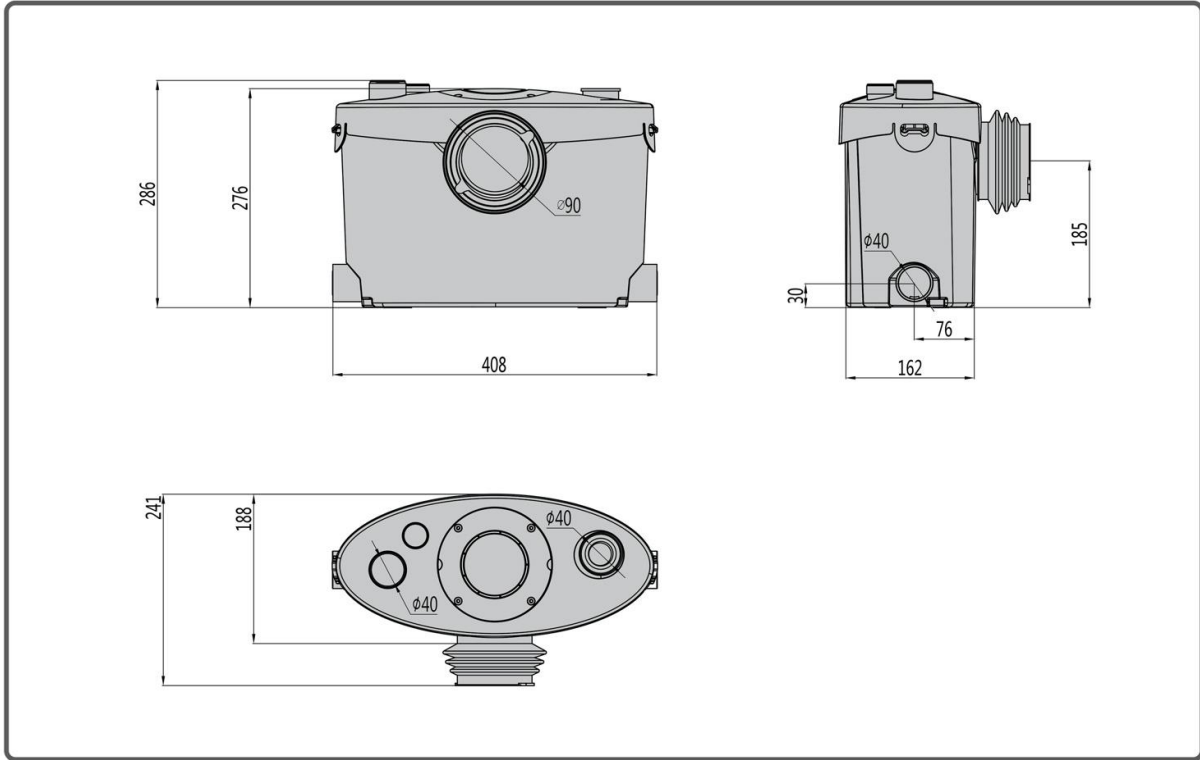

*Figure 2: Spare parts*

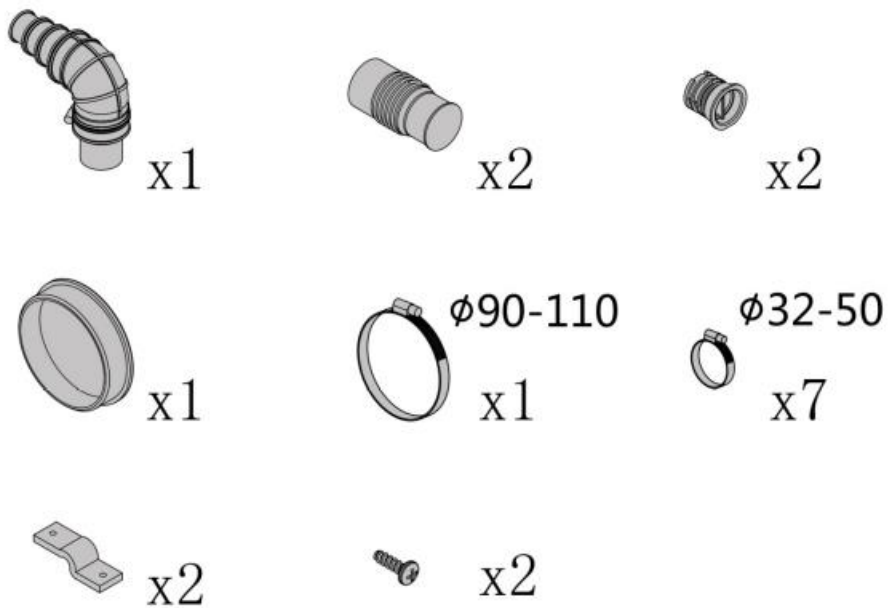
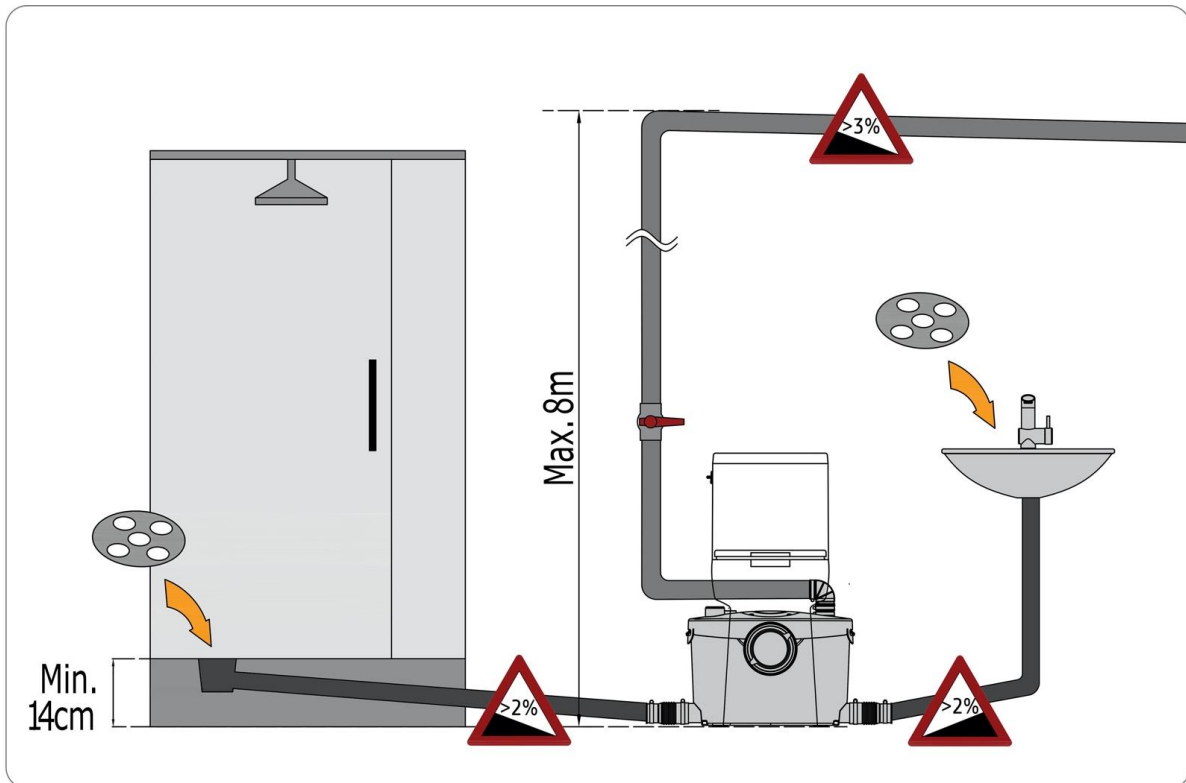

Figure 3: Mounting



- An outlet check valve is required.
- Install an additional manual check valve for repair (suggestion).
- Use a filter in the shower and toilet to prevent hair from getting into the device.

Figure 4: Connections

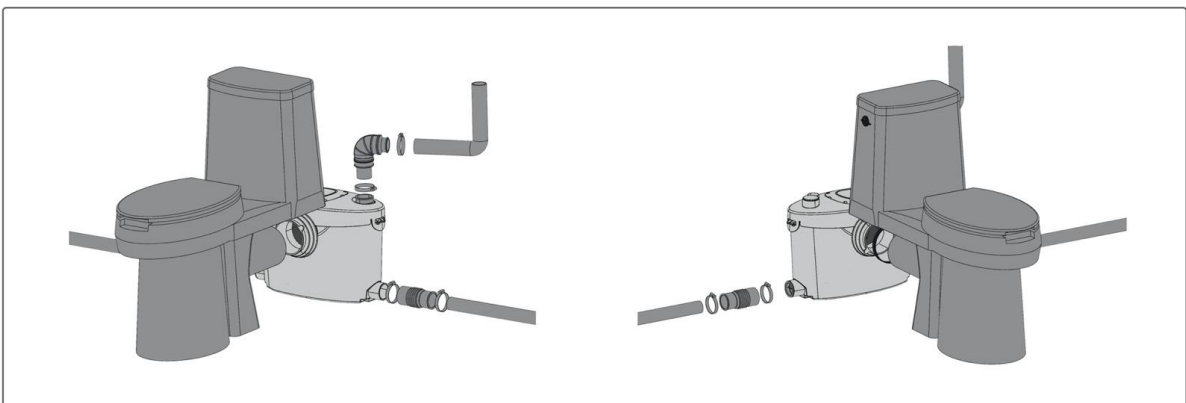

Figure 5: Optional intake for additional equipment

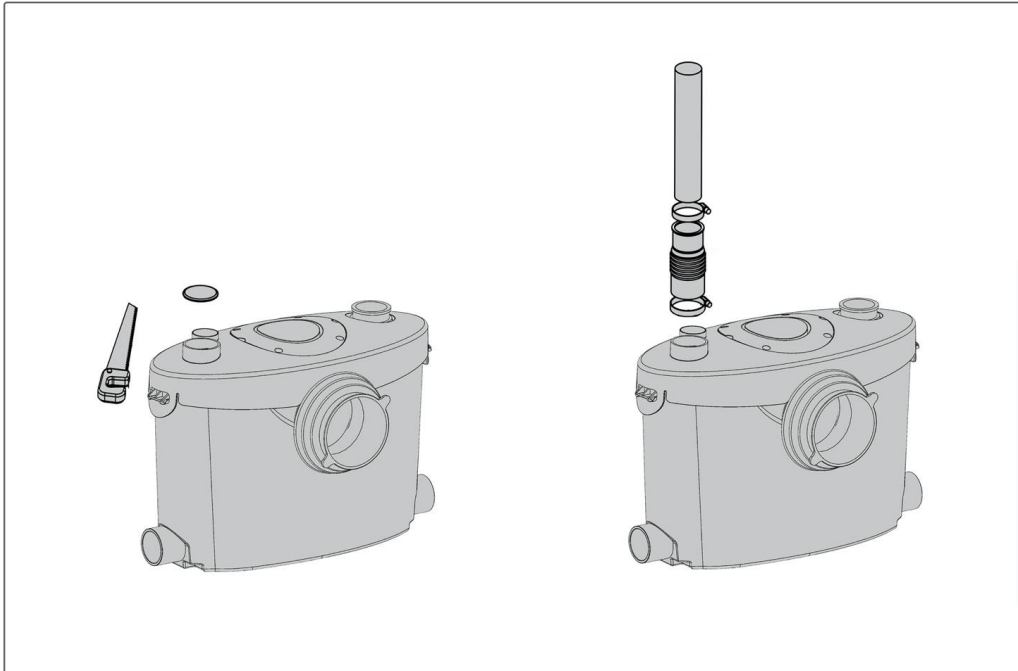

Figure 6: Intake cover

Cover all intakes that are not used.

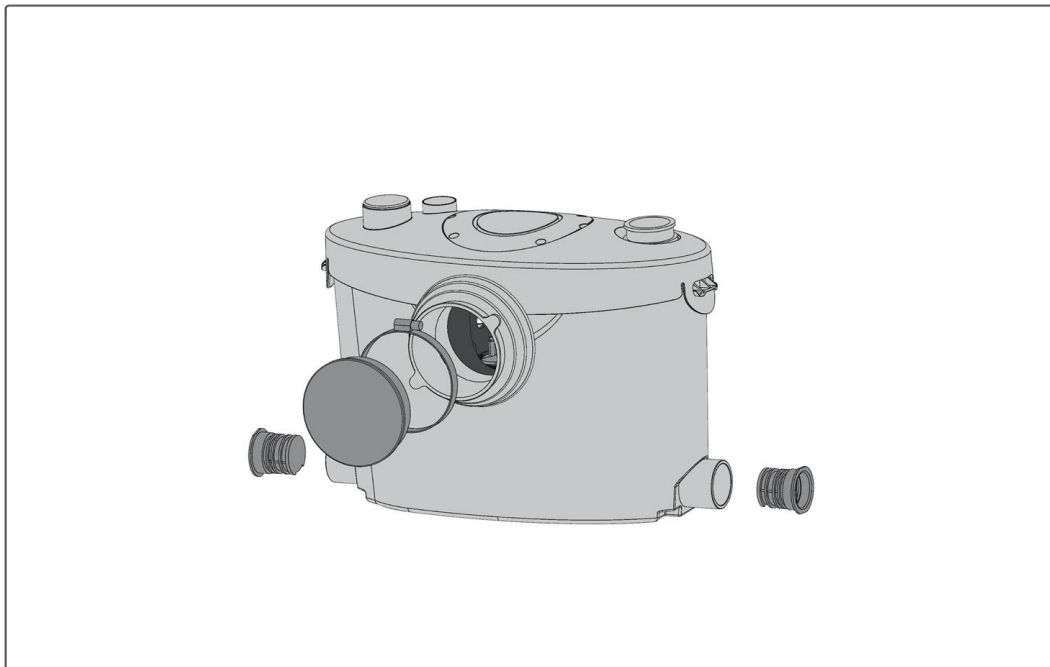

Figure 7: Fixations

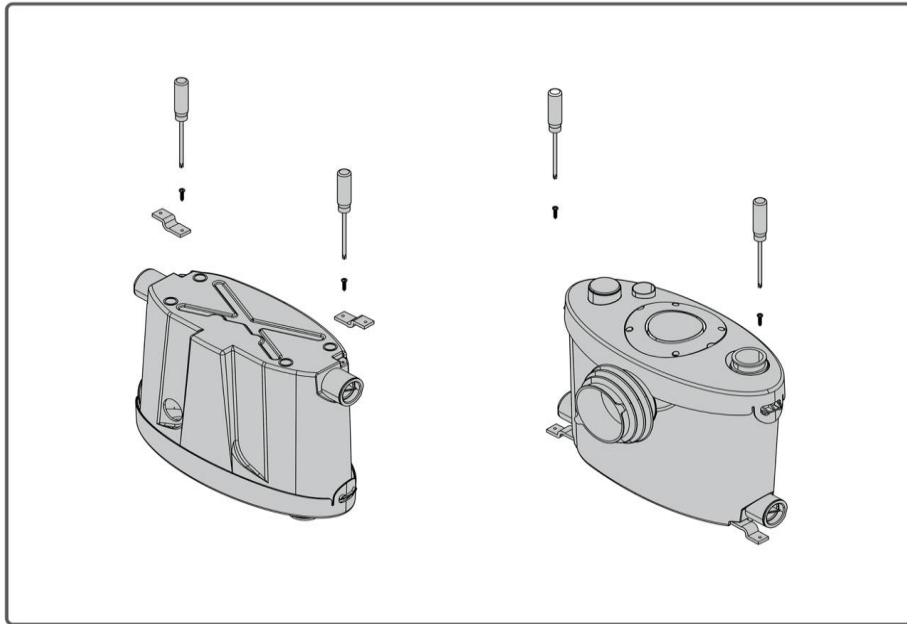

Figure 8: Outlet (non-return valve)

The non-return valve being only 1–2 cm in size, avoid inserting it too far.

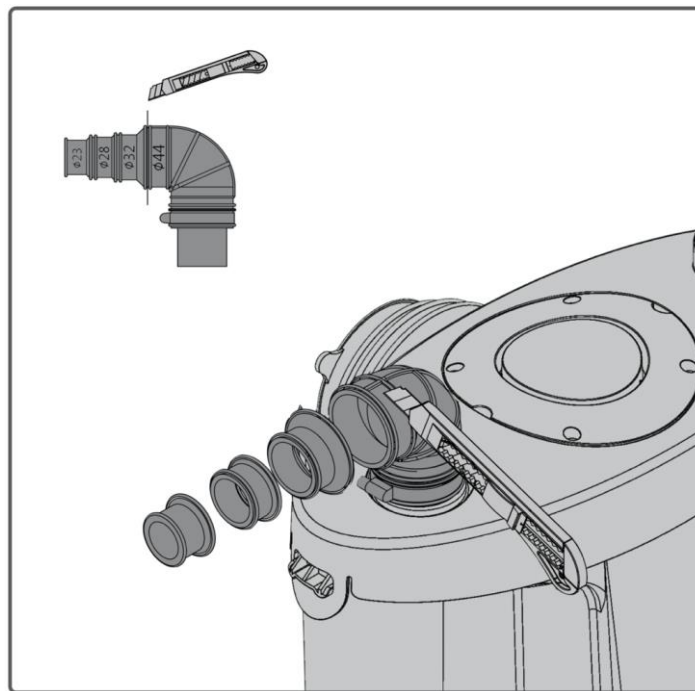



Figure 9: Maintenance flap

Open the upper maintenance flap. You can easily take out the block near the blade.

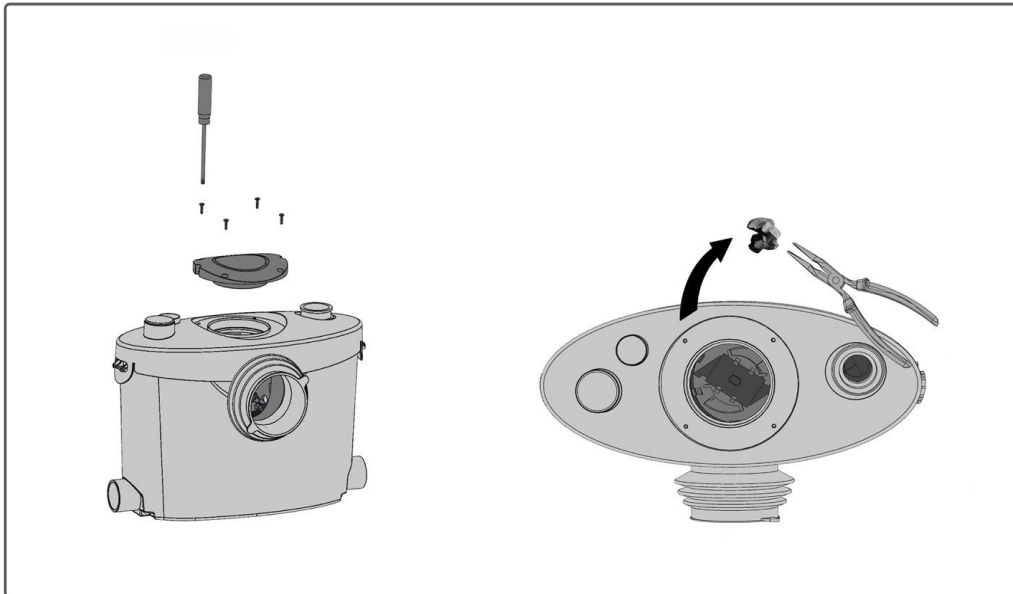

Figure 10: Heads and draws

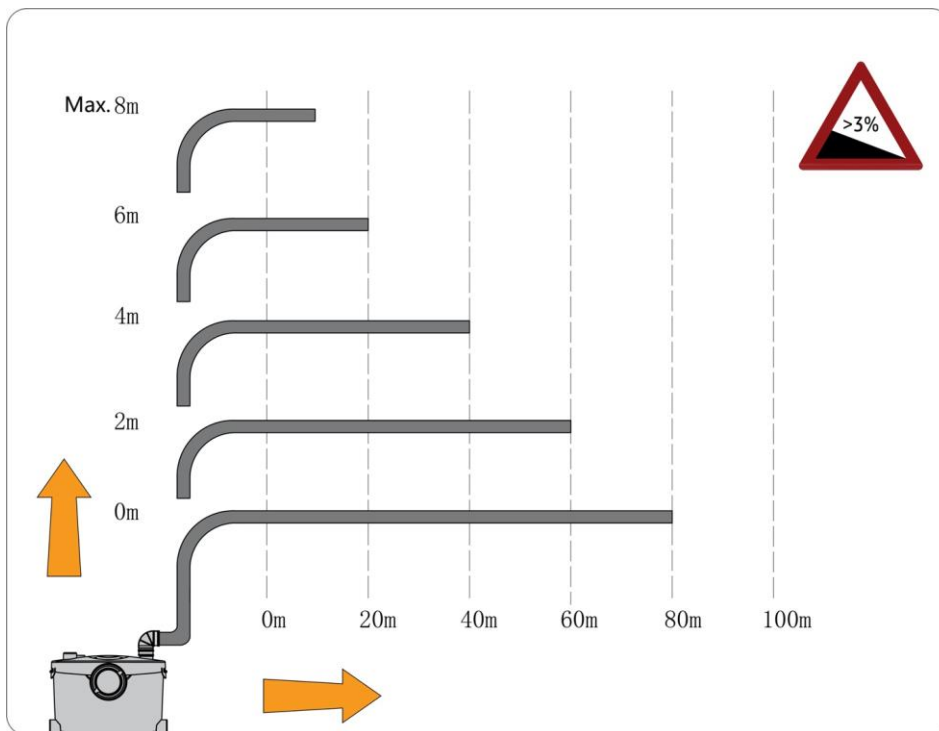

Figure 11: Flow rates

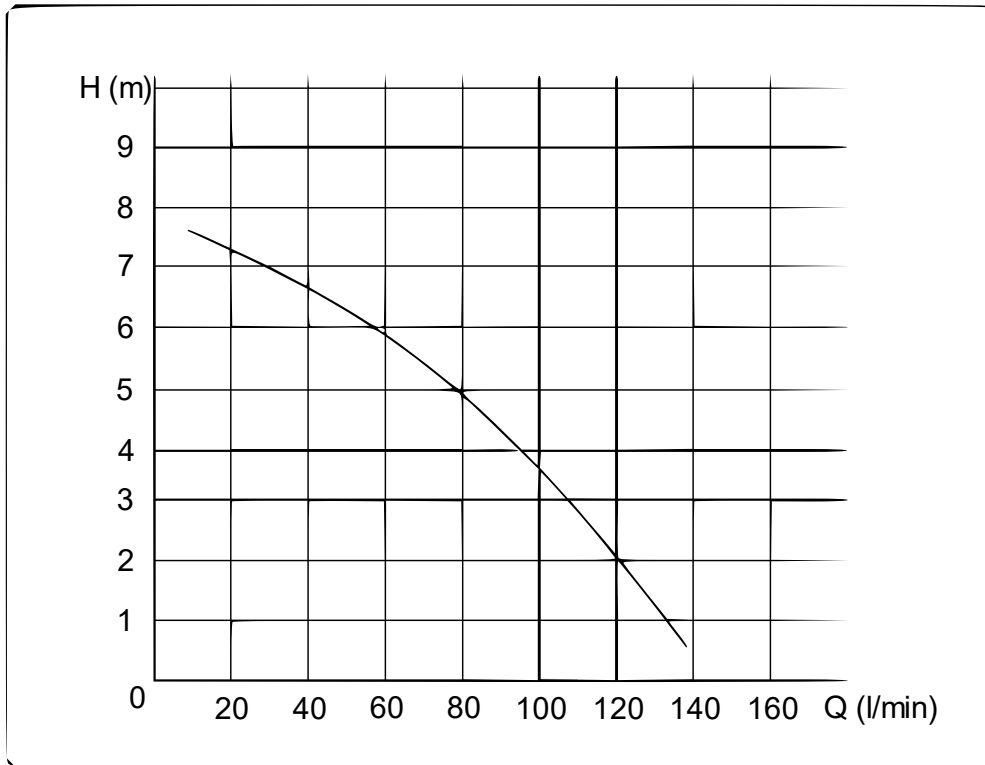

Figure 12: Distance from the wall

The minimum distance between the toilet outlet and the rear wall is 245 mm.

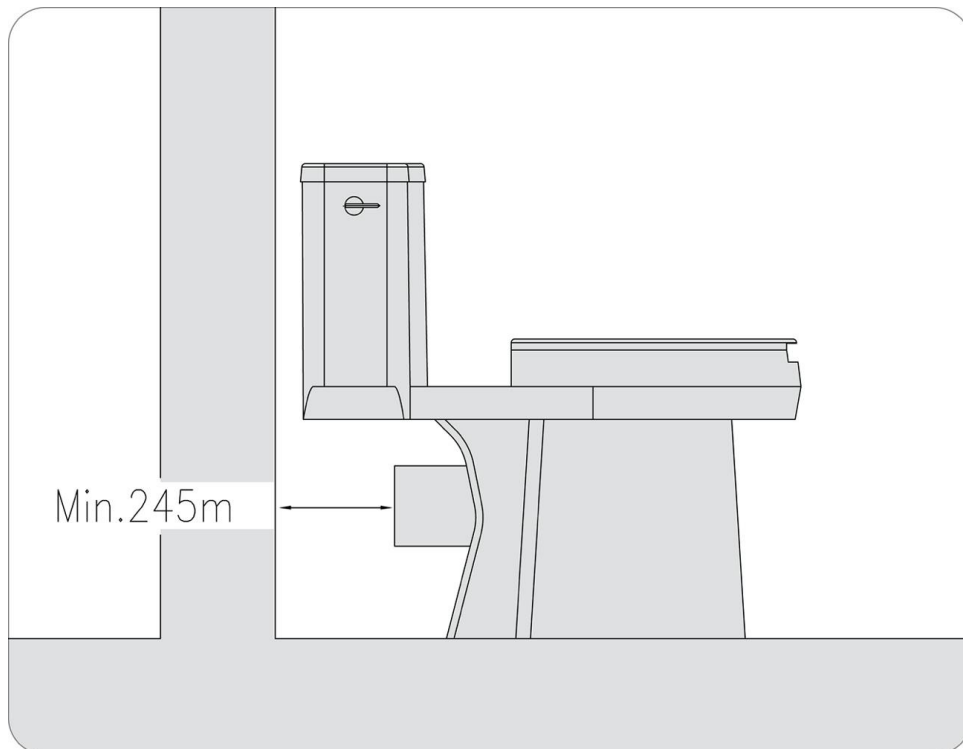

Figure 13: Elbow fittings

We recommend two 45° elbow fittings instead of one 90° elbow fitting.

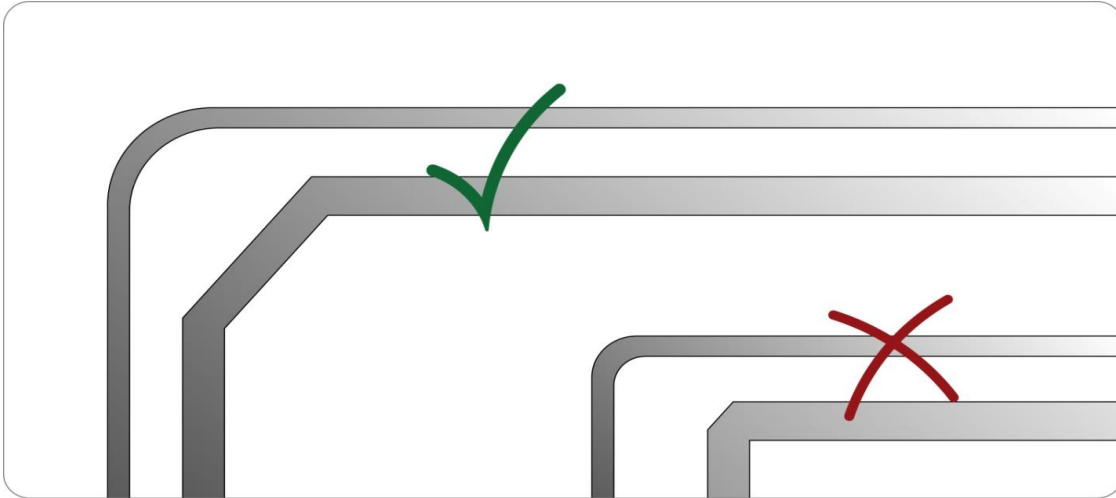
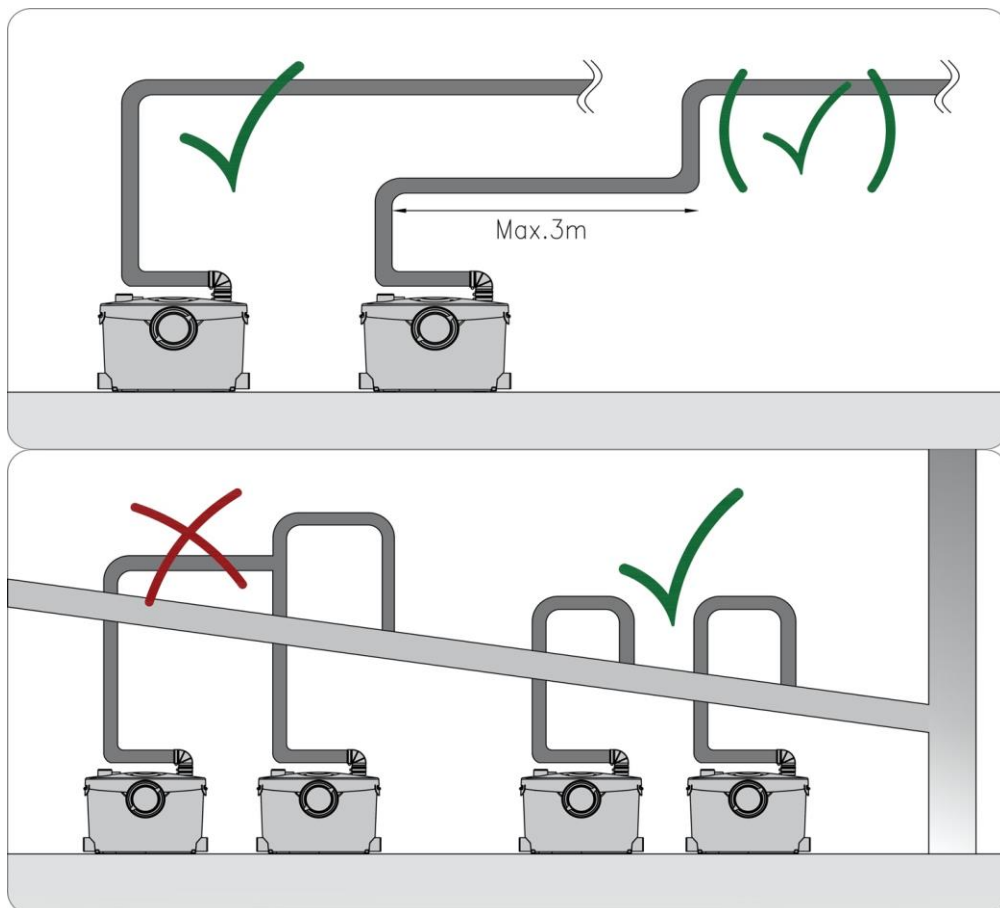
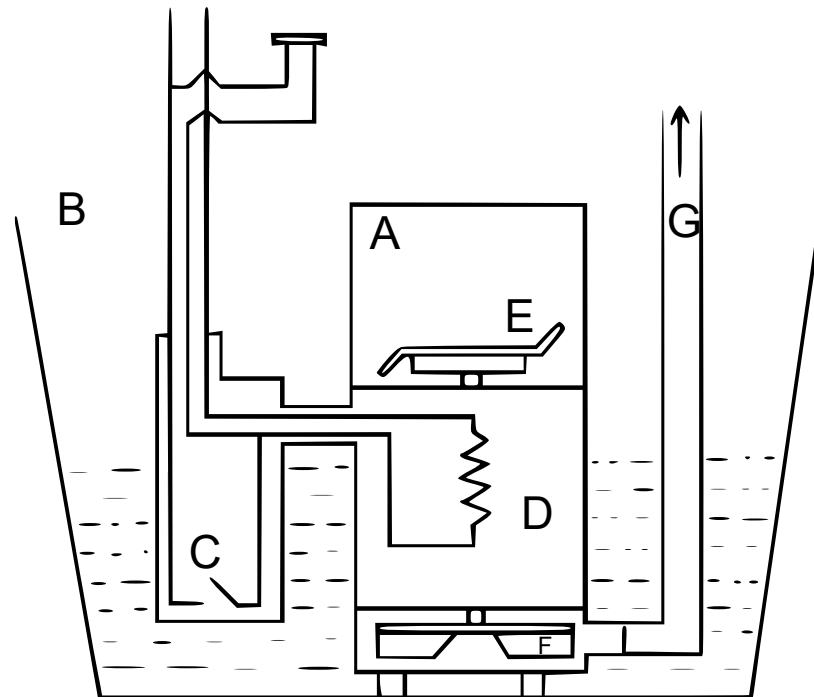

Figure 14 and 15: Outlet tube connection



## Functional principle

- The device is designed to pump wastewater from toilets and other sanitary facilities.
- It consists of an electric pump (D) automatically controlled by a float switch (C).
- The emptying process is triggered like with a conventional toilet by pressing the flush (see fig.).



## Installation

### Toilet connection

- First put some silicone or liquid soap on the toilet port.
- Fit the supplied collar onto the escape of the bowl.
- Pull the rubber lip over the toilet port.
- Position the hose clamp over the edge of the rubber lip and tighten it with a screwdriver.
- After the device has been set up, fasten it to the floor with the two screws supplied.
- If you are using the two floor mounting brackets, attach them to the floor before aligning the device.

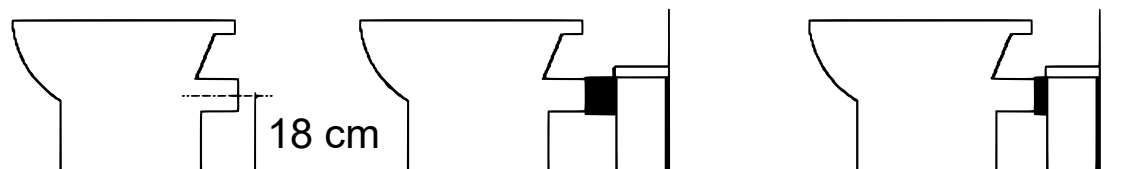

**Warning!** No water should drip from the toilet cistern or other sanitary facilities. If so, the unit will repeatedly be activated while draining the water.

### Drain pipe connection

Insert the outlet elbow into the rubber outlet pipe. Turn it in the desired direction and fasten it with the metal hose clamp supplied (36–50 mm). Then connect the hose using the 20–32 mm metal hose clamp, being careful not to kink the hose. A 22–32 mm plastic reducer is provided in the event that a 32 mm drain line is to be installed.



### Technical advice on drain pipes

- Horizontal pipes must have a gradient of at least 1:200 (5 mm/m) to the floor shaft.
- If a vertical lift is required, this must be done before the horizontal run at the beginning of the pipe run.
- We recommend installing a drainage point so that the drain pipe can be drained before maintenance work.
- If the drain line is significantly lower than the unit, the resulting siphoning effect can suck out the water seal in the unit. Installing an air inlet valve at the highest point of the pipeline solves this problem.
- The drainage pipes must be connected to the floor shaft with a suitable flange.
- Make sure that all external piping is sufficiently insulated to prevent possible freezing.

**Note!** Every angle on the pressure line of the system generates frictional losses (about 50 cm per angle piece must be deducted from the technical data for vertical conveyance). Always use even angles (or 2 45° elbows) and no 90° elbows.

### Electrical supply connection

- The electrical installation should be carried out by a specialist.
- The device should be connected to a fully earthed electrical supply.

### Commissioning the device

Once the electrical and wiring connections are made, flush the toilet once. The motor should run for 5 to 10 s to remove the wastewater (depending on the height of the pipe run). If it runs longer than 20 s, check whether the pipes are free and whether the drain hose is kinked. Flush the toilet and check that all seals and connections are watertight. Check both the drain lines of the unit and the connections to the other sanitary facilities.

### Use and warning notices

- If you are going to be absent for a longer period (e.g., during holiday), we recommend that you turn off the water supply to the toilet operated by the unit.
- The toilet attached to this unit can be used like any normal toilet, requiring very little maintenance. The unit works by itself as soon as the required water level is reached in the housing.
- The overheating protection of the motor is switched on as soon as the motor is overheated. Pull the plug out of the socket and plug it in again. After a waiting time of around 30–60 min, the device will work normally again.

 **Warning!** The device is only suitable for the disposal of toilet paper, faeces, and sewage! Damage caused by foreign objects such as cotton, condoms, sanitary towels, wet wipes, food, hair, metal, wood, or plastic objects are not covered by the guarantee. Solvents, acids, and other chemicals can also damage the device and void the warranty.

### Maintenance

- Disconnect the device from the power supply before starting work on it.
- No special maintenance work is required.
- This device is equipped with an activated carbon filter and does not require external ventilation.

## Disposal regulations

EU guidelines regarding the disposal of scrap electric appliances (WEEE, 2012/19/EU) were implemented in the law related to electrical and electronic equipment and appliances.

All WiITec electric devices that fall under the WEEE regulations are labelled with the crossed-out wheeled waste bin logo. This logo indicates that this electric equipment must not be disposed with the domestic waste.

The company WiITec Technik GmbH has been registered in the German registry EAR under the WEEE-registration number DE45283704.

Disposal of used electrical and electronic appliances (intended for use in the countries of the European Union and other European countries with a separate collection system for these appliances).

The logo on the article or on its packaging points out that this article must not be treated as normal household waste but must be disposed to a recycling collection point for electronic and electrical waste equipment. By contributing to the correct disposal of this article you protect the environment and the health of your fellow men. Environment and health are threatened by inappropriate disposal.



Material recycling helps reduce the consumption of raw materials.

Additional information on recycling this article can be provided by your local community, municipal waste disposal facilities, or the store where you purchased the article.

Address:  
WiITec Wildanger Technik GmbH  
Königsbenden 12 / 28  
D-52249 Eschweiler

Important notice:

The reprint or reproduction, even of excerpts, and any commercial use, even in part, of this instruction manual require the written permission of WiITec Wildanger Technik GmbH.