

Operation Manual

Electric Tiller

62862



Illustration similar, may vary depending on model

Read and follow the operating instructions and safety information before using for the first time.

Technical changes reserved!

Due to further developments, illustrations, functioning steps, and technical data can differ insignificantly.

Updating the documentation

If you have suggestions for improvement or have found any irregularities, please contact us.



The information contained in this document may alter at any time without previous notice. It is prohibited to copy or spread any parts of this document in any way without prior written allowance. All rights reserved.

The WilTec Wildanger Technik GmbH cannot be held accountable for any possible mistakes in this operating manual, nor in the diagrams and figures shown.

Even though, the WilTec Wildanger Technik GmbH has undergone biggest possible efforts to ensure that the operating manual is complete, faultless, and up to date, mistakes cannot be entirely avoided.

If you should find a mistake or wish to make a suggestion for improvement, we look forward to hearing from you.

Send an e-mail to:

service@wiltec.info

or use our contact form:

<https://www.wiltec.de/contacts/>

The most recent version of this manual in various languages can be found in our online shop via:

<https://www.wiltec.de/docsearch>

Our postal address is:

WilTec Wildanger Technik GmbH
Königsbenden 12
52249 Eschweiler
Germany

To return orders for exchange, repair, or other purposes, please use the following address. Attention! To allow for a smooth execution of your complaint or return, it is important to contact our customer service team before returning the goods.

Returns Department
WilTec Wildanger Technik GmbH
Königsbenden 28
52249 Eschweiler

E-mail: **service@wiltec.info**

Tel: +49 2403 55592-0

Fax: +49 2403 55592-15



Introduction

Thank you for purchasing this quality product. **To minimise the risk of injury we urge that our clients take some basic safety precautions when using this device. Please read the operation instructions carefully and make sure you have understood its content.** Keep these operation instructions safe.

Signs and symbols



Warning! Indicates a hazardous situation that, if not avoided, could result in death or serious injury.



Familiarise yourself with the operating instructions before use.



Wear safety glasses to protect your eyes.



Wear hearing protection to protect yourself against noise.



Always wear approved protective gloves.



If the cable is damaged, disconnect the unit from the power source immediately.



Do not expose the unit to rain or other sources of water or to environments with high humidity.



Protection class 2 tool



In accordance with the essential applicable safety standards of the European directives

Safety

Scope of use

This tiller is exclusively designed for private use and hobby and DIY projects for the following purposes:

- Breaking sod
- Preparing seed beds
- Cultivating gardens and flower beds

It must be used in accordance with the instructions and safety warnings contained in this manual and must not be used for any other purpose. It is designed for DIY use only and is not suitable for commercial or heavy-duty use, such use may damage your tiller and invalidate your warranty. Neither the



manufacturer nor the retailer can accept any responsibility for injury, loss or damage caused by misuse of the tiller of any kind.

Examples of misuse are given in the following non-exhaustive list:

- Use of the tiller for any other than its intended purpose
- Non-observance of the safety warnings and instructions as well as the assembly, operating, cleaning and maintenance instructions contained in this manual
- Non-observance of any applicable health, safety and accident prevention regulations concerning the use of this tiller
- Use of accessories or spare parts that are not suitable for the tiller
- Use of the tiller in modified form
- Commercial or otherwise excessive use

Anyone operating or servicing the tiller must be familiar with these instructions and must be aware of possible dangers. This tiller may only be used by a competent person – in case of doubt seek training or advice from an expert.

Non-observance of the safety, assembly, and operating instructions while operating the tiller is considered as misuse. Any applicable health and safety regulations must be followed. Any other applicable local and national legislation must as well be followed. The tiller may not be modified, as modifications may cause damage or injury.

Residual risks

A residual risk of injury remains even if the tiller is used for its intended purpose in accordance with the safety, assembly, and operating instructions.

Due to the nature of the machine, the following dangers may arise:

- Risk of injury when foreign objects come in contact with the tines. Ejected or flying debris can cause injury if the correct preventative measures are not followed.
- Damage to hearing if effective hearing protecting is not worn.
- Health defects resulting from vibration emissions if the tiller is being used over a longer period of the time or not adequately managed and properly maintained.

General safety instructions

Warning!

- **Read all safety warnings and all instructions.** Failure to follow the warnings and instructions may result in electric shock, fire, and/or serious injury.
- **Save all warnings and instructions for future reference.** The term “power tool” in the warnings refers to a mains-operated (corded) power tool or battery-operated (cordless) power tool.

Personal safety and preparation

- Carefully read the operating and safety instructions. Be familiar with the controls and the scope of use of the electric tiller.
- The electric tiller is not intended for use by persons (including children) with reduced physical, sensory, or mental capabilities or lack of experience and knowledge. Never allow children or people unfamiliar with these instructions to use the electric tiller. Local regulations can restrict the age of the operator. Children should be supervised to ensure that they do not play with the electric tiller.
- Never work while people, especially children, or pets are nearby. Keep in mind that the operator or user is responsible for accidents or hazards occurring to other people or their property.
- Dress properly. Do not wear loose clothing or jewellery. Keep your hair, clothing, and gloves away from moving parts. Loose clothes, jewellery, or long hair can be caught in moving parts.
- Always wear substantial footwear and long trousers. Thoroughly inspect the area where the electric tiller is to be used and remove all objects which can be thrown up by the machine.



- Before using the electric tiller, always visually inspect to see that the tines are not worn out or damaged. Replace worn out or damaged tines and bolts in sets to preserve balance.

Electrical safety

- The plug of the electric tiller must match the outlet. Never modify the plug in any way. Unmodified plugs and matching outlets will reduce risk of electric shock.
- Do not expose the electric tiller to rain or wet conditions. Water entering the electric tiller will increase the risk of electric shock.
- Do not abuse the cord. Never use the cord for carrying, pulling, or unplugging the electric tiller. Keep cord away from heat, oil, sharp edges, or moving parts. Damaged or entangled cords increase the risk of electric shock.
- If the mains cable is damaged, it should be replaced by a qualified electrician to avoid a hazard.
- Use an extension cord suitable for outdoor use. Use of a cord suitable for outdoor use reduces the risk of electric shock.

Safety of operation

- Work only in daylight and in good weather conditions. Never work in rainy, wet, or stormy conditions.
- Avoid accidental starting. Ensure the switch is in the off-position before plugging in. Carrying the electric tiller with your finger on the switch or plugging in the electric tiller with the switch on invites accidents.
- Do not operate the electric tiller in explosive atmospheres such as flammable liquids, gases, or dust. The electric tiller can create sparks which may ignite the dust or fumes.
- Ensure that you maintain a firm grip of both handles when operating the electric tiller. Walk, never run with the electric tiller and exercise extreme caution when reversing or pulling the electric tiller towards you.
- Do not overreach. Always keep proper footing and balance. This enables better control of the electric tiller in unexpected situations.
- Working on slopes is hazardous. Do not work on very steep slopes. Always be sure of your footing on slopes. Exercise extreme caution when changing direction on slopes.
- Start the electric tiller carefully according to manufacturer's instructions and with feet well away from the tines. Do not put your hands or feet near or under rotating parts.
- Never pick up or carry the electric tiller while its running. Stop it whenever you leave the machine and before performing any kind of cleaning or maintenance.
- Do not force the electric tiller. Use the correct tool for your application. The correct tool will do a better and safer job at the rate which it was designed for.
- Do not use the electric tiller if the switch does not turn it on and off. Any power tool that cannot be controlled with the switch is dangerous and must be repaired.
- Stay alert, watch what you are doing, and use common sense when operating the electric tiller. Do not use power tool while you are tired or under the influence of alcohol, drugs, or medicine. A moment of inattention while operating power tools may result in serious personal injury.

Service, maintenance, and storage

- Disconnect the plug from the power source before making any adjustments, changing accessories, or storing the electric tiller. Such preventive safety measures reduce the risk of the electric tiller starting accidentally.
- Maintain your electric tiller. Check it for moving parts misaligned or blocked, parts broken, and any other condition that may affect the electric tiller's operation. Keep all nuts, bolts, and screws tight to ensure the safety of operation. Replace worn or damaged parts for safety reasons.
- If damaged, have the electric tiller repaired with identical replacement parts before using it again. This will ensure that the safety of the power tool is maintained.
- Store the electric tiller out of children's reach and do not allow persons unfamiliar with the electric tiller or these instructions to operate the power tool. The electric tiller can be dangerous in the hands of untrained users.

List of contents

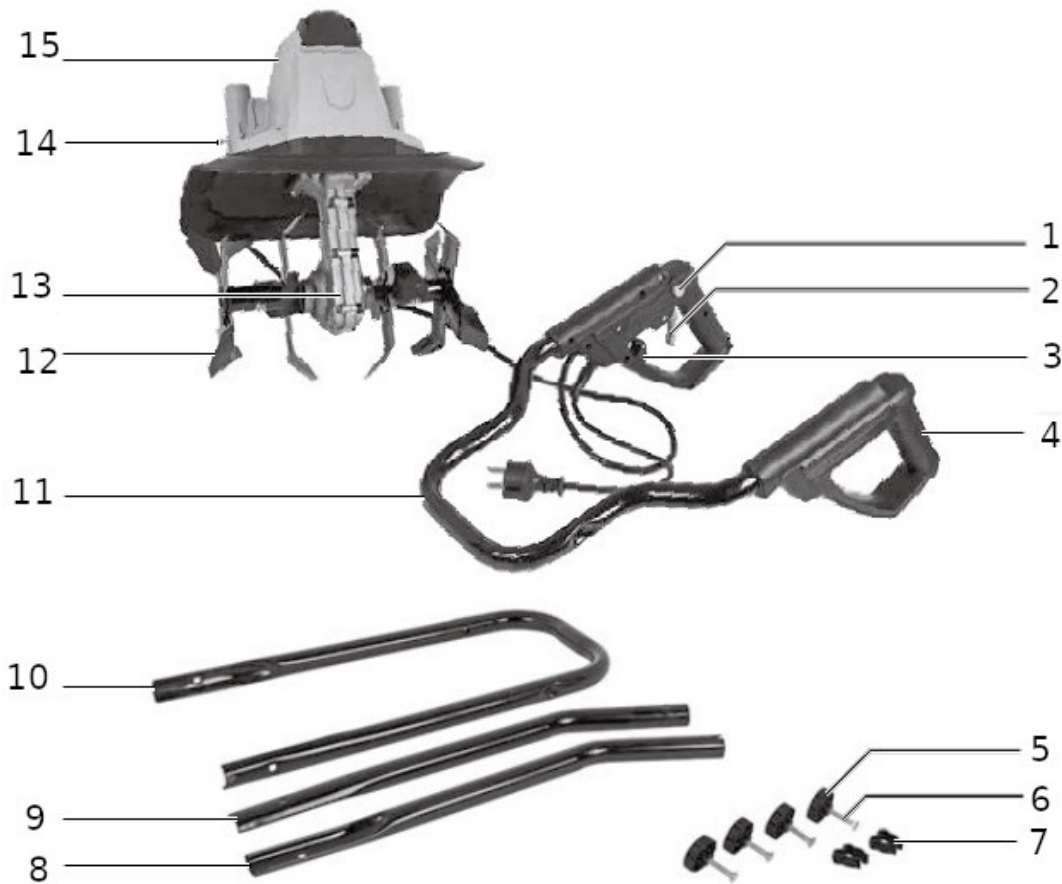

Nº	Name	Nº	Name
1	Safety lock button	9	Lower handle section (right)
2	Trigger lever	10	Central handle section
3	Power cord retainer	11	Upper handle section
4	Main handles	12	Tine assembly
5	Locking knobs (4×)	13	Gearbox/transmission
6	Bolt M6×45 (4×)	14	ST4×16 screws (2×)
7	Power cord clips (2×)	15	Motor housing
8	Lower handle section (left)		

Before using the tiller

Check the tiller and pack contents.

Warning! If any parts are damaged or missing, do not operate the tiller until the parts are replaced. Failure to heed this warning could result in serious personal injury.

1. Remove the tiller and its components from the packaging.
2. Check that the delivery is complete (see section “List of contents”).

3. Check whether the tiller or any of its parts are damaged. If this is the case, do not use the tiller.

Refilling the transmission lubricant

Notice! The tiller comes pre-filled. Failure to top up the transmission lubricant can cause wearing and damage over time.

The drain screw plug **(A)** is located on the right side of transmission housing **(B)**.

1. Lay the tiller on its left side and clean the transmission of dirt and debris prior to removing the drain screw plug.
2. If necessary, remove the tine assemblies to have access to the drain screw plug.
3. Use an 8 mm hex key to unscrew the plug. Empty the oil from the transmission.
4. Fill with high-quality transmissions grease. Reinstall the drain screw plug.

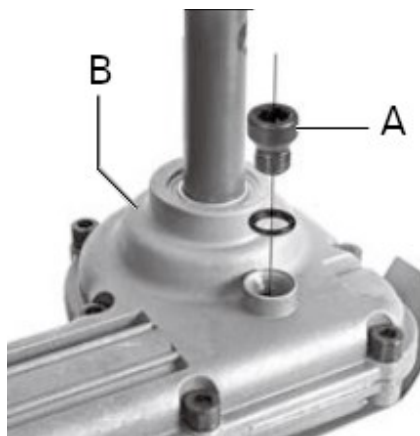

Assembly

Warning! Do not connect to the power supply until assembly is complete. Failure to comply could result in accidental starting and possible serious injury. The tiller must be assembled correctly before use.

1. Insert the lower handle sections **(8, 9)** into the motor housing **(15)** and fix them using the ST4×16 screws **(14)** supplied.



2. Fix the central handle section **(10)** to the lower handle sections **(8, 9)** using two of the M6×45 bolts **(6)** and the locking knobs **(5)** supplied.

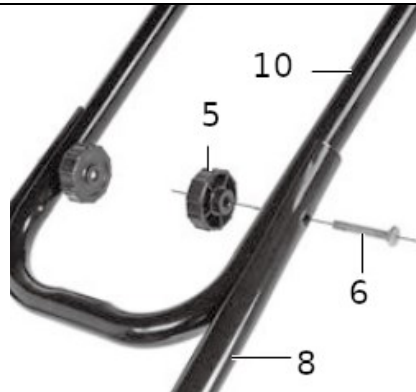

3. Attach the upper handle section (11) to the central handle section (10) using two of the M6×45 bolts (6) and the locking knobs (5) supplied.

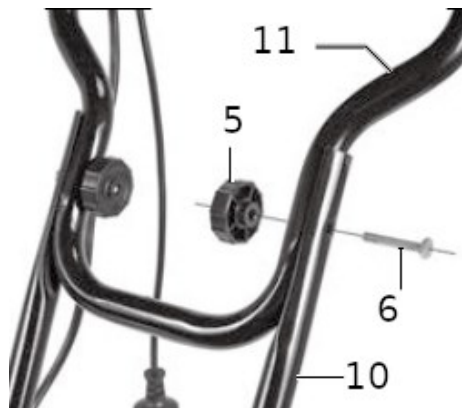

4. Secure the power cord using the power cord clips (7) supplied.



Operation instructions

Mains voltage

- Ensure that the local mains voltage agrees with the information on the appliance rating label.
- If the work area is not close to the mains outlet, an extension cable with a sufficient conductor cross sectional area (min 1.5 mm²) must be used. The extension cable used should be as short as possible. Always ensure that any extension cord used is fully unwound to avoid a risk of overheating. When using the tiller outdoors, use only extension cables approved and marked for outdoor use. The maximum operating current of this must be less than 30 mA.

Connecting to the mains

1. Secure the mains cord into the cord retainer **(3)**.
2. Connect the tiller's plug to the mains or to a suitable extension cable.

Switching on/off

Switching on: Press the safety lock button **(1)** on the safety switch and pull the trigger lever **(2)** up and against the handle bar. The motor will start and the tines will begin to rotate.

Switching off: Release the trigger lever..



Using the tiller

Caution! Switch the motor off and wait for the tines to come to a complete stop before moving the tiller. Do not allow the tines to touch the ground while moving the tiller. The tines as well as the unit itself may be damaged even if the motor is switched off.

- Use the tiller for breaking sod, preparing seed beds, and cultivating gardens and flower beds. The tiller can also dig small holes for planting saplings or potted plants.
- Move the tiller to the work area prior to starting the motor.
- For breaking sod or deep tilling, allow the tines to pull the tiller forward to the end of your arm's reach, then firmly pull it back towards yourself. You will achieve the best results by repeatedly allowing it to move forward and pulling back.
- By pulling the tiller back towards yourself, the tines will dig deeper and more intensely.
- To prevent tripping, take extra precautions when moving backwards and when pulling the tiller back towards yourself.
- If the tiller digs deep enough to stay in one spot, gently rock it side to side until it starts moving forward again.
- Never pass the tiller over the extension cord or mains cord. Make sure that the cord is always in a safe position behind you.
- When working on inclines, always stand diagonally to the incline to retain a firm safe footing. Do not work on extremely steep slopes.
- Before use, remove visible stones or other foreign bodies from the area.

Clearing foreign objects

During operation, a stone or root could become lodged in the tines, or tall grass or weeds may become wrapped around the tine shaft. To clear the tines or tine shaft, release the trigger lever, wait for the tines to come to a complete stop, and unplug the tiller. To simplify removal of tall grass or weeds from the tine shaft, remove one or more of the tines. See "Tine removal and installation" section.

Tilling patterns

When preparing seed beds, it is recommended to use one of the following tilling patterns.



<p><u>Pattern 1:</u> Make two passes over the area requiring tilling, the second at right angles to the first pass.</p>	
<p><u>Pattern 2:</u> Make two passes over the area requiring tilling, the second pass should overlap with the first.</p>	

Maintenance, cleaning, and storage

Warning! Disconnect the tiller from the mains before performing any type of maintenance or adjustments.

Tine removal and installation

Warning! Injury can occur while working on the tines. Wear protective gloves.

Notice! Worn tines invite poor performance and overload of the motor. Check tines before each use. Sharpen or replace the tine assemblies with new ones when necessary. Only use original replacement parts.

1. Remove the M8×40 hex head bolt (**D**) as shown and subsequently remove the tine assembly (**C**) from the shaft.
2. Follow the procedure above in reverse to install the tines.

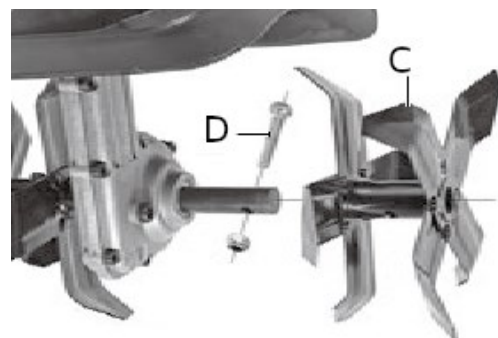

Notice! Make sure that all protective devices are secure and in good condition. Repair or replace these in necessary.



Cleaning

Caution! Never use a water hose to clean the tiller!

- Failure to carry out proper cleaning after every use can result in damage to the tiller or result in poor performance. Clean the underside of the motor support plate and housing around the tines with a scrub brush and a soft cloth dampened with a mild soap and water mixture.
- To remove soil and debris from the transmission and tines, use a stiff brush or a dampened cloth. Clean the vents on the motor housing and remove remaining grass or dirt. Once cleaned, wipe the tines and shaft dry and apply a light coat of oil prevent rust.

Storage

We recommend using the original packaging for storage or covering the product with a suitable cloth or enclosure to protect it against dust. Always store the product in place that is inaccessible to children. The ideal storage temperature is between 10 °C and 30 °C.

1. Switch the product off.
2. Clean the product as described above.
3. Store the product and its accessories in a dark, dry, frost-free, well-ventilated place.

Troubleshooting

Problem	Possible cause	Solution	
Motor does not start	Unit not plugged in	Plug in the unit.	
	No electricity	Check power supply.	
	Defective cable	Check cable, repair, or replace if necessary.	
	Defective safety switch/plug	Arrange for repair.	
	Overheat protection activated	Working depth too large – set to a shorter depth.	
		Blades blocked – remove blockage.	
	Soil too hard – select correct working depth and move forward and backward several times while slowing down the operation speed.		
Wait until the motor cools down for about 15 min before re-use.			
Abnormal noise	Tine is jammed	Switch off, wait until the tines come to a complete stop, remove blockages.	
	Lubrication running out	Tiller must be repaired.	
	Loose bolts, nuts, or other components	Tighten all components, arrange for repair if noises persist.	
Abnormal Vibrations	Damaged or worn blades	Replace damaged or worn blades.	
	Working depth too large	Set to correct working depth.	
Poor results	Work depth too small	Set to correct working depth.	
	Worn blades	Replace damaged or worn blades.	



Technical specifications

Rated voltage	230 V 50 Hz
Rated power (W)	1050
No-load speed (1/min)	380
Tine diameter (mm)	20
Working width (mm)	320
Working depth (mm)	220
Protection class	II

Vibration information

It is necessary to take measures to protect the operator based on an assessment of the actual conditions of use.

Take measures to reduce the risk of excessive vibration:

- Only use the tool as described in these instructions.
- Only use suitable accessories and ensure that they are sharp, in good condition, and suitable for the type of work being carried out.
- Keep the tool maintained and in good condition.
- Wear anti-vibration gloves when using this tool regularly.

Disposal regulations

EU guidelines regarding the disposal of scrap electric appliances (WEEE, 2012/19/EU) were implemented in the law related to electrical and electronic equipment and appliances.

All WiTec electric devices that fall under the WEEE regulations are labelled with the crossed-out wheeled waste bin logo. This logo indicates that this electric equipment must not be disposed with the domestic waste.

The company WiTec Technik GmbH has been registered in the German registry EAR under the WEEE-registration number DE45283704.

Disposal of used electrical and electronic appliances (intended for use in the countries of the European Union and other European countries with a separate collection system for these appliances).

The logo on the article or on its packaging points out that this article must not be treated as normal household waste but must be disposed to a recycling collection point for electronic and electrical waste equipment. By contributing to the correct disposal of this article you protect the environment and the health of your fellow men. Environment and health are threatened by inappropriate disposal.



Material recycling helps reduce the consumption of raw materials.

Additional information on recycling this article can be provided by your local community, municipal waste disposal facilities, or the store where you purchased the article.

Address:
WiTec Wildanger Technik GmbH
Königsbenden 12 / 28
D-52249 Eschweiler

Important notice:

The reprint or reproduction, even of excerpts, and any commercial use, even in part, of this instruction manual require the written permission of WiTec Wildanger Technik GmbH.