

Operation Manual

Industrial Vacuum Cleaner Wet Dry 1000 W 62997



Illustration similar, may vary depending on model

Read and follow the operating instructions and safety information before using for the first time.

Technical changes reserved!

Due to further developments, illustrations, functioning steps, and technical data can differ insignificantly.

Updating the documentation

If you have suggestions for improvement or have found any irregularities, please contact us.



The information contained in this document may alter at any time without previous notice. It is prohibited to copy or spread any parts of this document in any way without prior written allowance. All rights reserved.

The WilTec Wildanger Technik GmbH cannot be held accountable for any possible mistakes in this operating manual, nor in the diagrams and figures shown.

Even though, the WilTec Wildanger Technik GmbH has undergone biggest possible efforts to ensure that the operating manual is complete, faultless, and up to date, mistakes cannot be entirely avoided.

If you should find a mistake or wish to make a suggestion for improvement, we look forward to hearing from you.

Send an e-mail to:

service@wiltec.info

or use our contact form:

<https://www.wiltec.de/contacts/>

The most recent version of this manual in various languages can be found in our online shop via:

<https://www.wiltec.de/docsearch>

Our postal address is:

WilTec Wildanger Technik GmbH
Königsbenden 12
52249 Eschweiler
Germany

To return orders for exchange, repair, or other purposes, please use the following address. Attention! To allow for a smooth execution of your complaint or return, it is important to contact our customer service team before returning the goods.

Returns Department
WilTec Wildanger Technik GmbH
Königsbenden 28
52249 Eschweiler

E-mail: **service@wiltec.info**

Tel: +49 2403 55592-0

Fax: +49 2403 55592-15



Introduction

Thank you for purchasing this quality product. **To minimise the risk of injury we urge that our clients take some basic safety precautions when using this device. Please read the operation instructions carefully and make sure you have understood its content.**

Keep these operation instructions safe.

Safety instructions

Caution! Before cleaning or servicing the device, the mains plug must be disconnected from the mains.

- **Attention!** Read the operating instructions carefully before assembly and commissioning.
- Check that the mains voltage corresponds to the information on the type plate
- Only connect to a proper 220–240 V, 50 Hz socket. A fuse of at least 13 A is required.
- Disconnect the mains plug from the mains when: the device is not in use, before opening the device, before cleaning and maintenance.
- Never clean with solvents
- Never disconnect the device from the mains by unplugging the power cable.
- Never leave the unit unattended when it is ready for use.
- Take care not to damage the power cable by running over it, crushing it, stretching it, etc.
- The unit must not be operated if the power cable is not in perfect condition.
- If the power cable is damaged, it must be replaced by a qualified electrician to avoid a hazard.
- **Caution!** The following objects must never be vacuumed: burning matches, glowing ashes and cigarette butts, flammable, corrosive, inflammable or explosive substances, vapours, and liquids.
- The unit is not suitable for vacuuming dust that is hazardous to health.
- Store the unit in a dry place.
- Do not operate the unit if it has a defect.
- Maintenance work should only be carried out by a qualified specialist.
- Use the unit only for work for which it is intended.
- Be very careful when cleaning stairs.
- Use only original accessories and spare parts.
- This device is not intended to be used by persons (including children) with reduced physical, sensory, or mental capabilities, or lack of experience and knowledge, unless they have been given supervision or instruction concerning use of the device by a person responsible for their safety.
- Children should be supervised to ensure that they do not play with the device.

Optional power socket

- IPX4 protection is only guaranteed if an IPX4 plug is connected to the socket outlet of the unit or the cover of the socket outlet is closed.
- The max. load of the socket is 2000 W.

Main parts

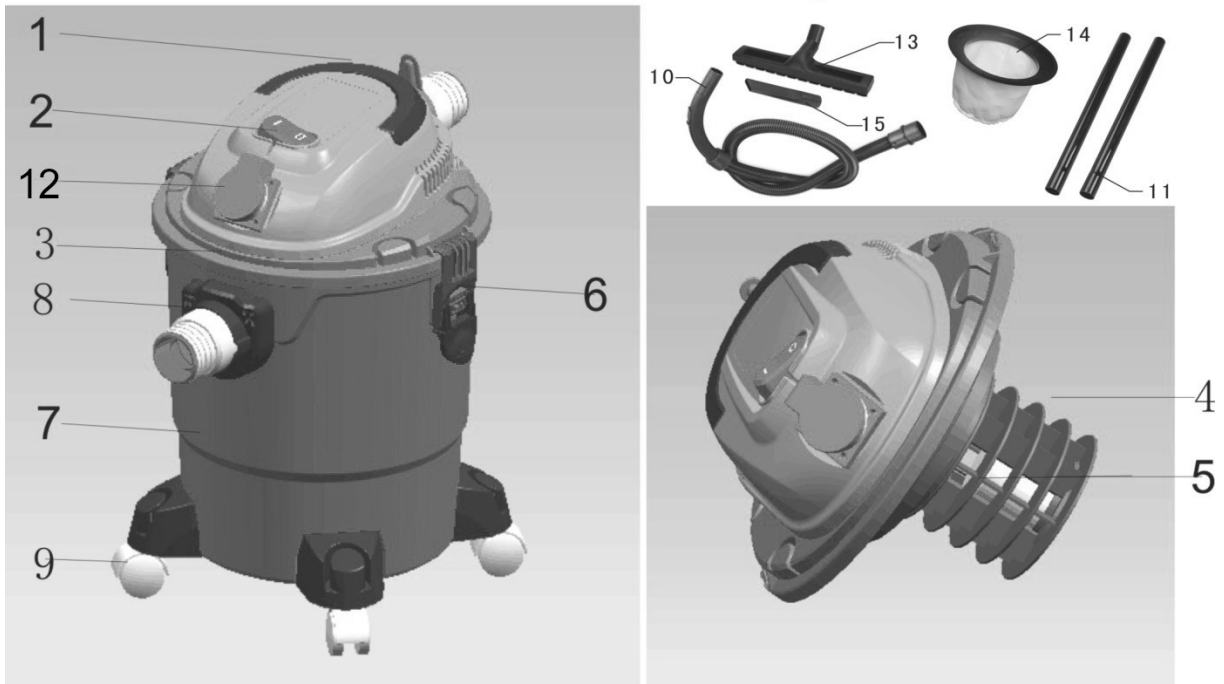

No	Name	No	Name
1	Handle	9	Idler wheel
2	On/Off switch	10	Vacuum tube
3	Top section	11	Vacuum tube
4	Filter basket	12	NA
5	Safety float valve	13	Large vacuum nozzle
6	Clasp	14	NA
7	Container	15	Crevice nozzle
8	Vacuum hose connection		

Nozzle overview

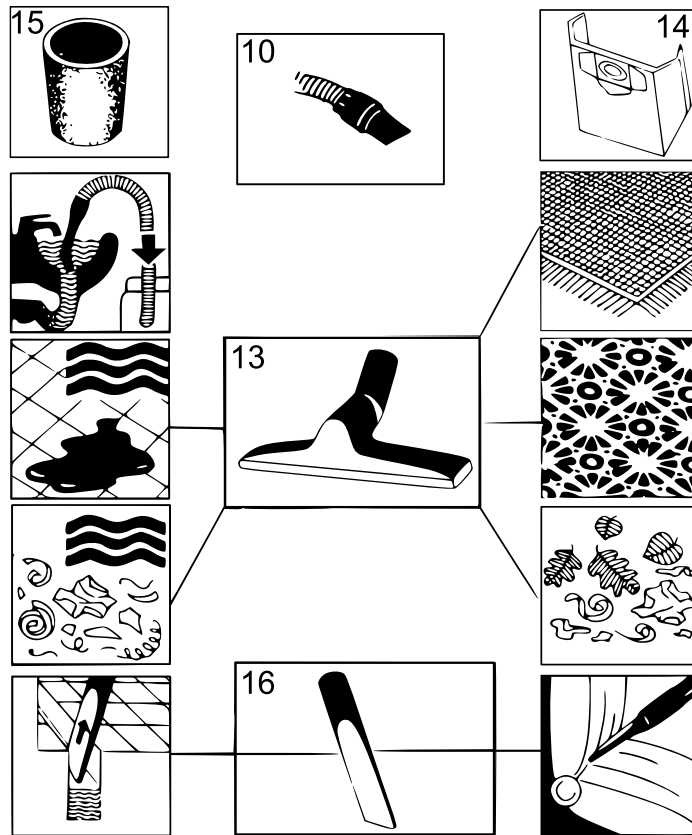

Assembly

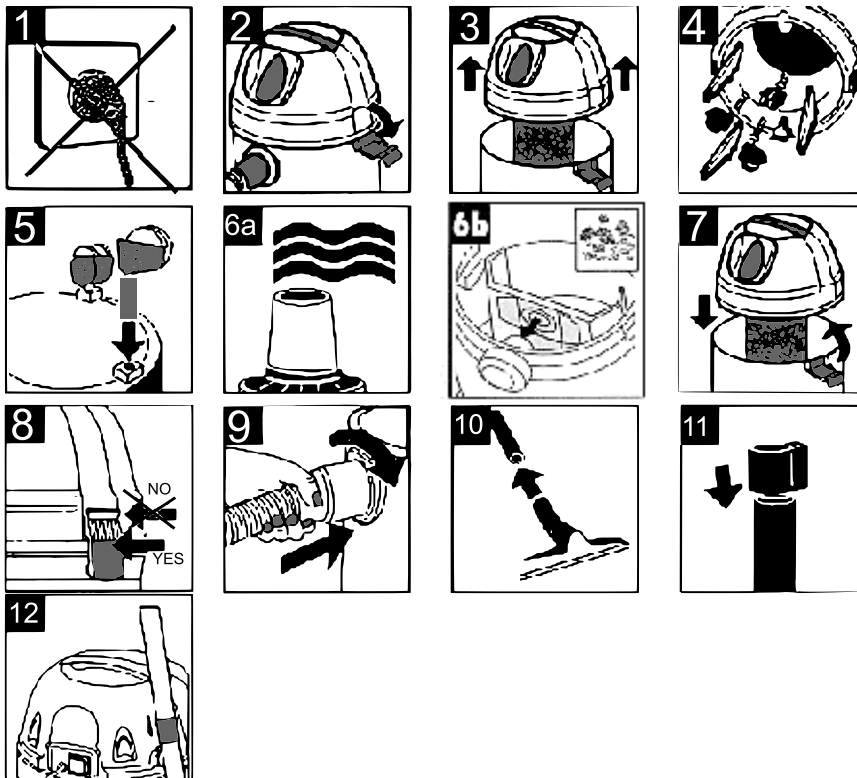

Notice!

- Figure 6 A: Use the foam filter supplied for wet vacuuming.
- Figure 6b: Use the supplied dust bag for dry vacuuming.

Cleaning by wet vacuum cleaner

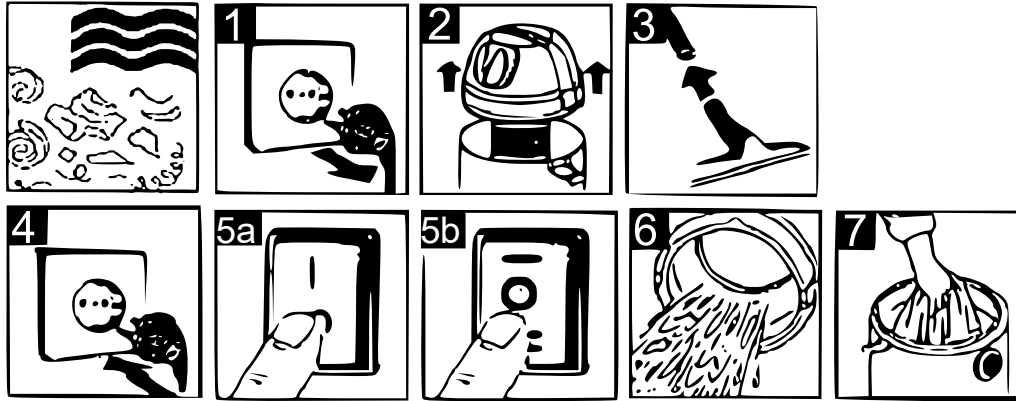

1. Disconnect the mains plug before changing the filter (Fig. 1).
2. Pull the foam filter supplied over the filter basket (Fig. 2) for wet suction.
3. Insert the plug and turn on the switch, then the device starts to work (Fig. 4 and 5a or 5b).

Notice!

- (Depending on the model) If you slide the switch to the “1” position, the vacuum cleaner works; if you slide the switch to the “0” position, the vacuum cleaner does not work. If the device connected to the socket works, the vacuum cleaner also works 3–5 s later. If the device stops working, the vacuum cleaner also stops working.
- The external device for the power of the socket is below 2000 W.
- The dust bag supplied is not suitable for wet vacuuming!

Dry vacuum cleaning

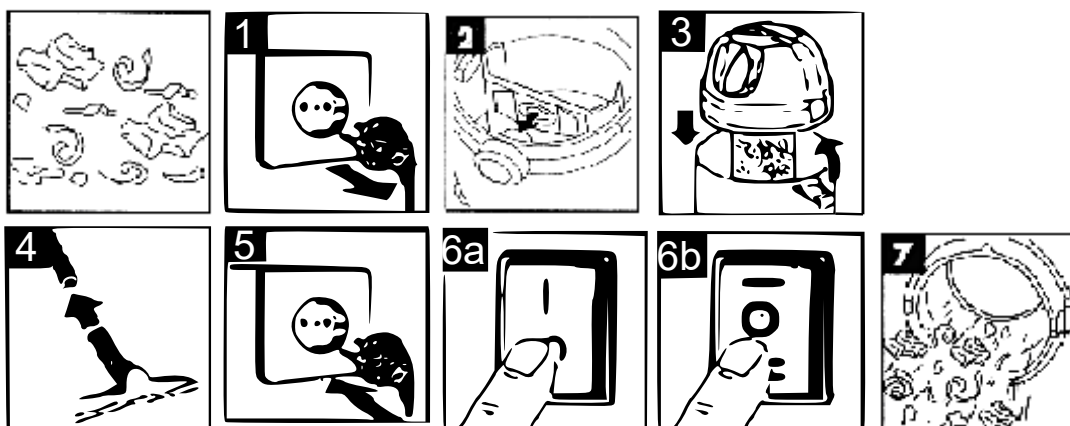

1. Before changing the filter, disconnect the mains plug (Fig. 1). Then remove the bag and empty the dust or replace the bag. Put the dust bag on the connection (Fig. 2) to vacuum dry.
2. Connect the mains plug to the mains and turn on the switch, then the device starts to work (Fig. 5 and 6 A or 6b).

Notice!

- (Depending on the model) If you slide the switch to the “I” position, the vacuum cleaner works; if you slide the switch to the “O” position, the vacuum cleaner does not work. If the device connected to the socket works, the vacuum cleaner also works 3–5 s later. If the device stops working, the vacuum cleaner also stops working.
- The external device for the power of the socket is below 2000 W.
- The dust bag is only suitable for dry vacuuming!

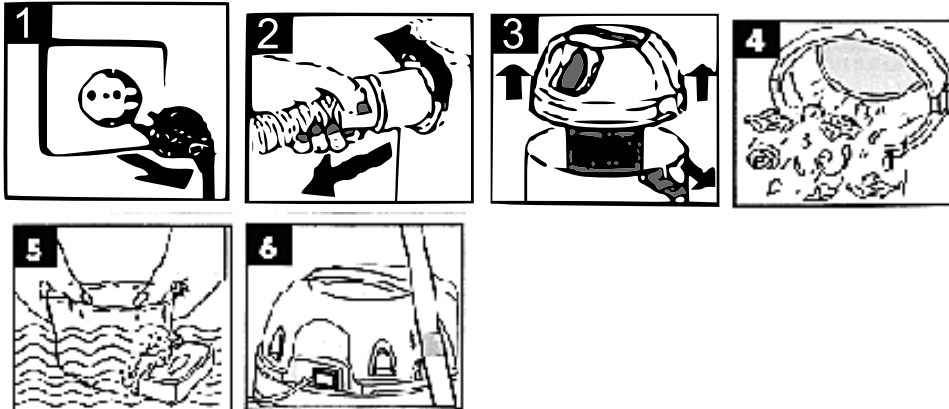
Cleaning and maintenance

1. Disconnect the mains plug before maintenance (Fig. 1).
2. Remove the foam filter (Fig. 3) and wash it with water (Fig. 5).

Important! Do not use detergents to clean the filter. The filter must be thoroughly dry before using the device.

Disposal regulations

EU guidelines regarding the disposal of scrap electric devices (WEEE, 2012/19/EU) were implemented in the law related to electrical and electronic equipment and devices.

All WiITec electric devices that fall under the WEEE regulations are labelled with the crossed-out wheeled waste bin logo. This logo indicates that this electric equipment must not be disposed with the domestic waste.

The company WiITec Technik GmbH has been registered in the German registry EAR under the WEEE-registration number DE45283704.

Disposal of used electrical and electronic devices (intended for use in the countries of the European Union and other European countries with a separate collection system for these devices).

The logo on the article or on its packaging points out that this article must not be treated as normal household waste but must be disposed to a recycling collection point for electronic and electrical waste equipment. By contributing to the correct disposal of this article you protect the environment and the health of your fellow men. Environment and health are threatened by inappropriate disposal.



Material recycling helps reduce the consumption of raw materials.

Additional information on recycling this article can be provided by your local community, municipal waste disposal facilities, or the store where you purchased the article.

Address:
WiITec Wildanger Technik GmbH
Königsbenden 12 / 28
D-52249 Eschweiler

Important notice:

The reprint or reproduction, even of excerpts, and any commercial use, even in part, of this instruction manual require the written permission of WiITec Wildanger Technik GmbH.