

Operation Manual

Electric Scarifier 1500 W

63016



Illustration similar, may vary depending on model

Read and follow the operating instructions and safety information before using for the first time.

Technical changes reserved!

Due to further developments, illustrations, functioning steps, and technical data can differ insignificantly.

Updating the documentation

If you have suggestions for improvement or have found any irregularities, please contact us.



The information contained in this document may alter at any time without previous notice. It is prohibited to copy or spread any parts of this document in any way without prior written allowance. All rights reserved.

The WilTec Wildanger Technik GmbH cannot be held accountable for any possible mistakes in this operating manual, nor in the diagrams and figures shown.

Even though, the WilTec Wildanger Technik GmbH has undergone biggest possible efforts to ensure that the operating manual is complete, faultless, and up to date, mistakes cannot be entirely avoided.

If you should find a mistake or wish to make a suggestion for improvement, we look forward to hearing from you.

Send an e-mail to:

service@wiltec.info

or use our contact form:

<https://www.wiltec.de/contacts/>

The most recent version of this manual in various languages can be found in our online shop via:

<https://www.wiltec.de/docsearch>

Our postal address is:

WilTec Wildanger Technik GmbH
Königsbenden 12
52249 Eschweiler
Germany

To return orders for exchange, repair, or other purposes, please use the following address. Attention! To allow for a smooth execution of your complaint or return, it is important to contact our customer service team before returning the goods.

Returns Department
WilTec Wildanger Technik GmbH
Königsbenden 28
52249 Eschweiler

E-mail: **service@wiltec.info**

Tel: +49 2403 55592-0

Fax: +49 2403 55592-15



Introduction

Thank you for purchasing this quality product. **To minimise the risk of injury we urge that our clients take some basic safety precautions when using this device. Please read the operation instructions carefully and make sure you have understood its content.**

Keep these operation instructions safe.

Note!

- Unpack the product carefully and do not dispose of the packaging until you have unpacked all parts of the product.
- The unit is designed for aerating lawns in private gardens and yards. It is not intended for use in public areas, parks, sports fields, on roads and in agriculture.

Safety instructions and symbols



Before operating the device, carefully read this manual and all safety instructions contained therein.



Do not work in the rain or in adverse weather conditions.



Attention! The blades of the scarifier continue to rotate for some time after the device has been switched off.

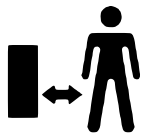

Keep a safe distance.



Attention! Rotating and sharp blades. Protect yourself from injury.



When carrying out maintenance on the machine or if the power cable is pinched or damaged, always switch off the engine and disconnect the power plug from the mains.



Wear hearing protection while working.

Check before each use

- Check the device before each use. Make sure that no parts are missing or damaged. Also check that all screws, bolts, and nuts are tight.
- Do not use the electric scarifier if any safety mechanisms (start lever, safety brake, or covers) are damaged or worn. Never use the machine with a blocked or missing safety mechanism.
- Inspect the area to be ventilated before starting work. Check the working area for foreign objects (e.g., stones, branches, ropes) and remove them if necessary.



Proper use

Caution! Risk of injury! The scarifier can cause serious injuries.

- Do not bring hands and feet near the scarifying cylinder.
- You are responsible for the safety of your work area. Always follow all the instructions and advice given in this manual.
- Observe local noise restrictions.
- Only work in good visibility conditions.
- Do not open the rear cover during use.
- Familiarise yourself with the surroundings of your work area. Be aware of possible hazards that may not be audible because of the noise of the machine.
- Wear sturdy shoes and long trousers to protect your legs.
- Make sure that there are no other people (especially children) and animals in your working area.
- Only operate the scarifier at walking speed.
- Do not use the machine in the rain or in damp or wet conditions.
- Do not use the machine near the edges of swimming pools or garden ponds.
- To avoid injury, the electric scarifier must not be used to trim shrubs, hedges, and bushes. Furthermore, it must not be used for levelling uneven terrain.
- Operating position: Make sure to have a safe footing during operation. Be especially careful when changing direction on a slope.

Attention! Be extremely careful when walking backwards. You could trip!

Interrupting work

Caution! Never leave the scarifier unattended in the working area. When you stop work, park the machine in a safe place. Pull out the mains plug! When you stop work to resort to another place, always switch off the machine while carrying it. Move the wear compensation lever to the transport position.

In case you encounter an obstacle while scarifying, switch off the machine and remove the obstacle. Check the machine for damage and have it repaired if necessary.

Electrical safety

- Keep the extension cord away from the scarifying cylinder.
- Never use the machine in the rain.
- It is necessary to inspect the mains cable regularly for damage and signs of wear. If the mains cable is damaged, do not use the machine. Have the mains cable replaced by qualified personnel.
- Only use approved extension cables with appropriate cross-sections. Please consult a qualified electrician if you are unsure.

Main components



Nº	Name	Nº	Name
1	Locking mechanism of the switch	7	Lever for adjusting the working depth
2	Main switch	8	Grass catcher
3	Upper part of the handle	9	Grass catcher cover
4	Handle connecting screw	10	Mains plug
5	Middle part of the handle	11	Mains cable holder clip
6	Lower part of the handle		

Assembly

Mounting the handles

1. Insert the bottom of the handle into the housing of the machine (Fig. 2, 1).
2. Fasten the bottom part with the screws supplied (Fig. 2, 2).

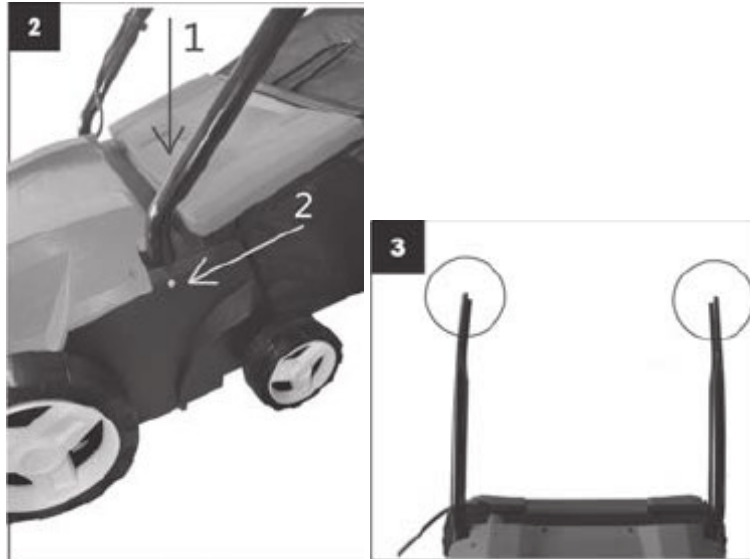

Attention! The notches in the upper part of the handle must point inwards (Fig. 3).

3. Connect the middle part of the handle to the lower part using the fastening screws supplied (Fig. 4).

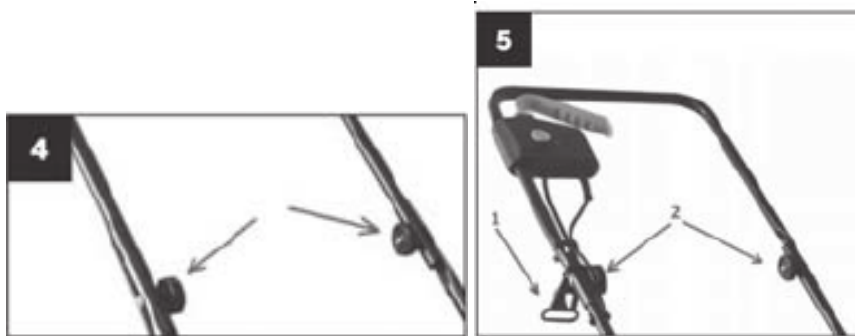

4. First slide the holder clip for the mains cable onto the right side of the upper handle (Fig. 5, 1). Then fix the upper part of the handle to the middle part with the screws provided (Fig. 5, 2).
5. After mounting the handle, attach the mains cable to the handle with the plastic holders (Fig. 6).

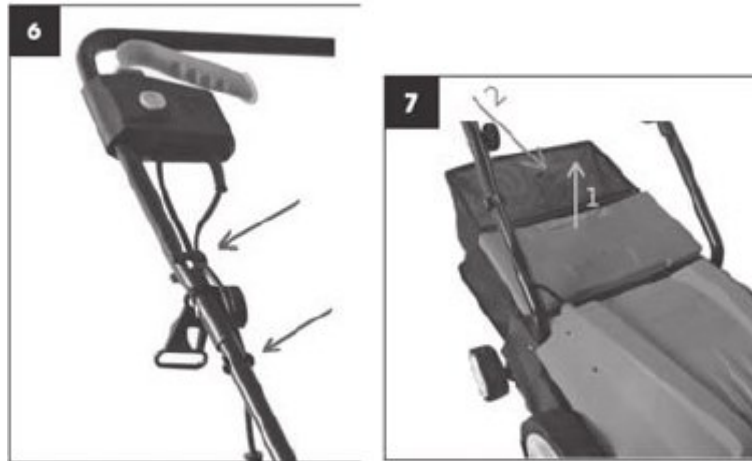

Mounting the grass catcher

The grass catcher is included in the delivery. Simply place it on the machine. Lift the grass catcher cover with one hand (Fig. 7, 1) to place the grass catcher with the other hand (Fig. 7, 2). The hooks on the grass catcher must slide into the holes in the machine body. Then release the grass catcher cover.

Replacing the blades

Danger! The cylinder can cause injuries! Before replacing, disconnect the machine from the mains and wait until the cylinder has come to a standstill. Wear work gloves when replacing.

1. Unscrew the screws (1) on the underside of the chassis (Fig. 8).

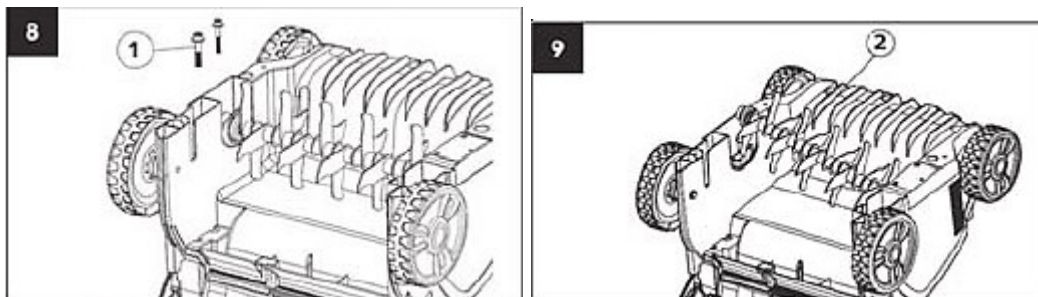

2. Lift the cylinder (2) at an angle and pull it out (Fig. 9).
3. Slide the new cylinder onto the drive shaft so that the pin (4) fits into the corresponding part of the drive shaft (3) (Fig. 10).

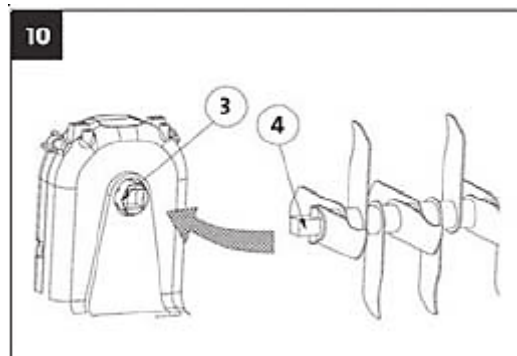

Setting up the machine

Attention! The working depth of the scarifying cylinder should not exceed 3 mm. The aeration cylinder with springs should replicate the ground contour during operation. Setting too great a working depth can damage the scarifying cylinder or overload and destroy the engine even without visible wear on the blades/springs. This can also damage the lawn.

Adjustment after wear

To maintain the recommended working depth, use the working depth adjustment lever (Fig. 1, 7). To adjust the lever, first pull it out upwards and then select the desired working depth. Pos. 1 is for transporting the machine.

Note! The blades and springs of this machine wear out depending on the type of use. The more intensively the machine is used, the greater the wear on the blades and springs are.

Hard or very dry soils accelerate the wear process as does excessive use. In case the wear of the blades worsens the working results of the machine, it is possible to adjust the scarifying cylinders so that the working depth is kept constant at the depth described above.

Commissioning (Fig. 11)

Before restarting, check that the blade has come to a complete stop. Do not switch the machine on and off in rapid succession.

Starting

1. Press and hold the safety button **(1)**. Pull the start lever **(2)** to the handle.
2. Unlock the safety button.



Switching off

Release the start lever **(2)**.

Maintaining and cleaning the machine

Attention! Danger!

- Rotating blades can cause injuries.
- Before carrying out maintenance work, always disconnect the machine from the mains and wait until the cylinder has come to a complete standstill.
- Wear work gloves when carrying out maintenance work. The machine should be cleaned after each use.
- Risk of injury and damage to property.
- Do not clean the machine under running water (especially not by high pressure).



- Do not use hard or pointed objects to clean the machine.
- Remove grass and accumulated debris from the wheels, the scarifying cylinder, and the cover.

Scarifying and aerating

For comfortable work with the machine, it is best to start work at the point closest to the power source and then move away from the power source.

Caution! Do not put too much load on the motor when working, especially in demanding conditions. When the engine is loaded, the engine speed will drop and you will hear a change in the engine noise. If this happens, stop work, release the start lever, and reduce the scarifying/aerating depth. Otherwise, the machine could be damaged.

Note: The motor is protected by a safety mechanism that is activated the moment that the blades get stuck or the motor is overloaded. In that case, switch off the machine and disconnect the mains plug from the power source. The safety mechanism is only reset when the start lever is released. Remove all obstacles and wait a few minutes before resetting the safety mechanism and resuming work. At this time, do not operate the start lever as this will increase the reset time of the safety mechanism. If the machine switches off again, reduce the scarifying/aerating depth again, which will reduce the load on the engine.

Disposal regulations

EU guidelines regarding the disposal of scrap electric devices (WEEE, 2012/19/EU) were implemented in the law related to electrical and electronic equipment and devices.

All WiTec electric devices that fall under the WEEE regulations are labelled with the crossed-out wheeled waste bin logo. This logo indicates that this electric equipment must not be disposed with the domestic waste.

The company WiTec Technik GmbH has been registered in the German registry EAR under the WEEE-registration number DE45283704.

Disposal of used electrical and electronic devices (intended for use in the countries of the European Union and other European countries with a separate collection system for these devices).

The logo on the article or on its packaging points out that this article must not be treated as normal household waste but must be disposed to a recycling collection point for electronic and electrical waste equipment. By contributing to the correct disposal of this article you protect the environment and the health of your fellow men. Environment and health are threatened by inappropriate disposal.



Material recycling helps reduce the consumption of raw materials.

Additional information on recycling this article can be provided by your local community, municipal waste disposal facilities, or the store where you purchased the article.

Address:
WiTec Wildanger Technik GmbH
Königsbenden 12 / 28
D-52249 Eschweiler

Important notice:

The reprint or reproduction, even of excerpts, and any commercial use, even in part, of this instruction manual require the written permission of WiTec Wildanger Technik GmbH.