

Instruction Manual

Pool Cleaning Robot

Naia HJ1009

63229



Illustration similar, may vary depending on model

Please read and follow the operating instructions and safety information prior to initial operation.

Technical changes reserved!

Illustrations, functional steps, and technical data may deviate insignificantly due to continuous further developments.

The information contained in this document may alter at any time without prior notice. No part of this document may be copied or otherwise duplicated without prior written consent. All rights reserved. WilTec Wildanger Technik GmbH cannot be held liable for any possible mistakes in this operating manual, nor in the diagrams and illustrations shown.

Although WilTec Wildanger Technik GmbH has made every possible effort to ensure that this operating manual is complete, accurate, and up-to-date, errors cannot be ruled out entirely.

If you have found an error or wish to suggest an improvement, we look forward to hearing from you.

Send us an e-mail to:

service@wiltec.info

or use our contact form:

<https://www.wiltec.de/contacts/>

The most recent version of this manual in several languages can be found in our online shop:

<https://www.wiltec.de/docsearch>

Our postal address is:

WilTec Wildanger Technik GmbH
Königsbenden 12
52249 Eschweiler Germany

Do you wish to collect your goods? Our address for collection is:

WilTec Wildanger Technik GmbH
Königsbenden 28
52249 Eschweiler Germany

In order to shorten the waiting time and to allow for an easy on-site processing, we kindly ask you to contact us briefly beforehand or to place your order via the webshop.

E-mail: service@wiltec.info

Phone: +49 2403 55592-0

Fax: +49 2403 55592-15

To return your goods for exchange, repair, or other purposes, please use the following address. Attention! To allow for a trouble-free complaint or return, it is important to contact our customer service team before returning your goods.

Retourenabteilung
WilTec Wildanger Technik GmbH
Königsbenden 28
52249 Eschweiler Germany

E-mail: service@wiltec.info

Phone: +49 2403 55592-0

Fax: (+49 2403 55592-15)

Introduction

Thank you for choosing to purchase this quality product. To minimise the risk of injury, we ask you to always take some basic safety precautions when using this product. Please read this operating manual carefully and make sure that you understand it.

Keep these operation instructions in a safe place.

Safety instructions

- This model is especially suitable for pools with flat floor; follow the corresponding instructions in this manual if your pool has a sloped floor.
- To avoid serious damage to your robot, never switch the device on when it is not in the pool.
- The power cable must be connected to an appropriate earthed socket. Only operate the device with a residual current protective device with a triggering amperage of max. 30 mA.
- Do not operate the robot while persons are in the pool.
- Do not try to move the floating bodies alongside the power cable. Always leave them at their initial positions.
- Before switching the device on, make sure that the cable is completely unrolled to avoid any rolling-up of the cable which would impair the efficiency of the robot or damage it.
- The filter bag must be cleaned before or after each use. This avoids that contaminations of the filter bag impair the normal operation of the robot.
- When not in use, the robot must be stored in a cool and well-ventilated place and not in direct sunlight.
- The power-supply unit must be placed in a shadowy place. To avoid any overheating and possible consequential damage of components, never cover the power-supply unit.
- The robot and motor unit should only be opened and/or repaired by qualified persons.
- To avoid any accidents or damages, the power-supply unit should be placed at a min. distance of 3.5 m from the edge of the pool.
- Do not use the device in other working conditions than those stated in this manual. Only use the device according to the intended use defined in this manual.
- Do not remove the protective film of the control panel.
- Close the pool filter system when you use the robot.

Other instructions

- Placing the robot in the pool and removing it from the pool should be so that the wheels of the robot point towards the walls to avoid that the surface of the pool be scratched.

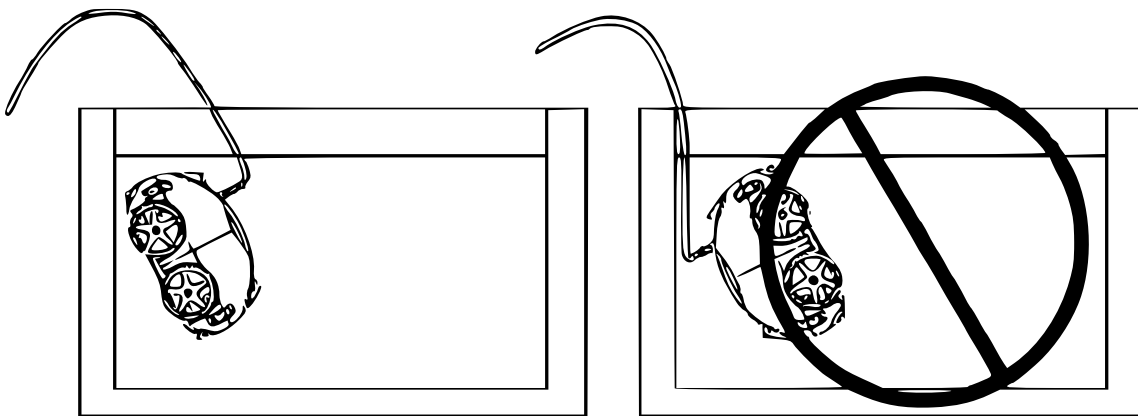

- Store the cleaning robot on a flat surface. No hard objects must touch the casing of the robot to avoid damage.

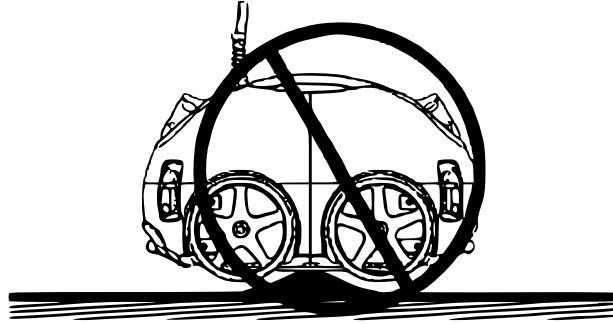

- Do not apply excessive force on the filter unit by squeezing or seizing it when you mount or unmount it to avoid that the casing be damaged.

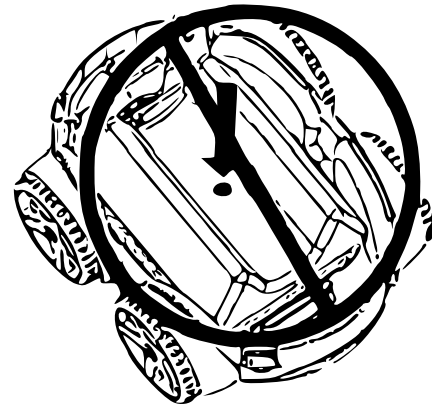
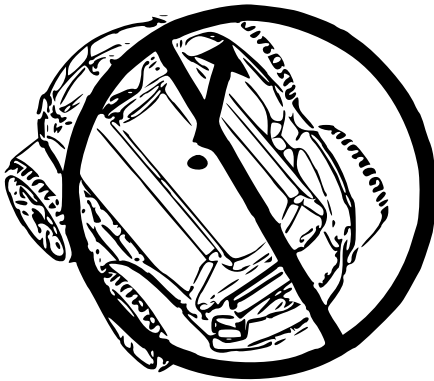

- Do not lift both sides of the filter unit at the same time.

Assembly and installation

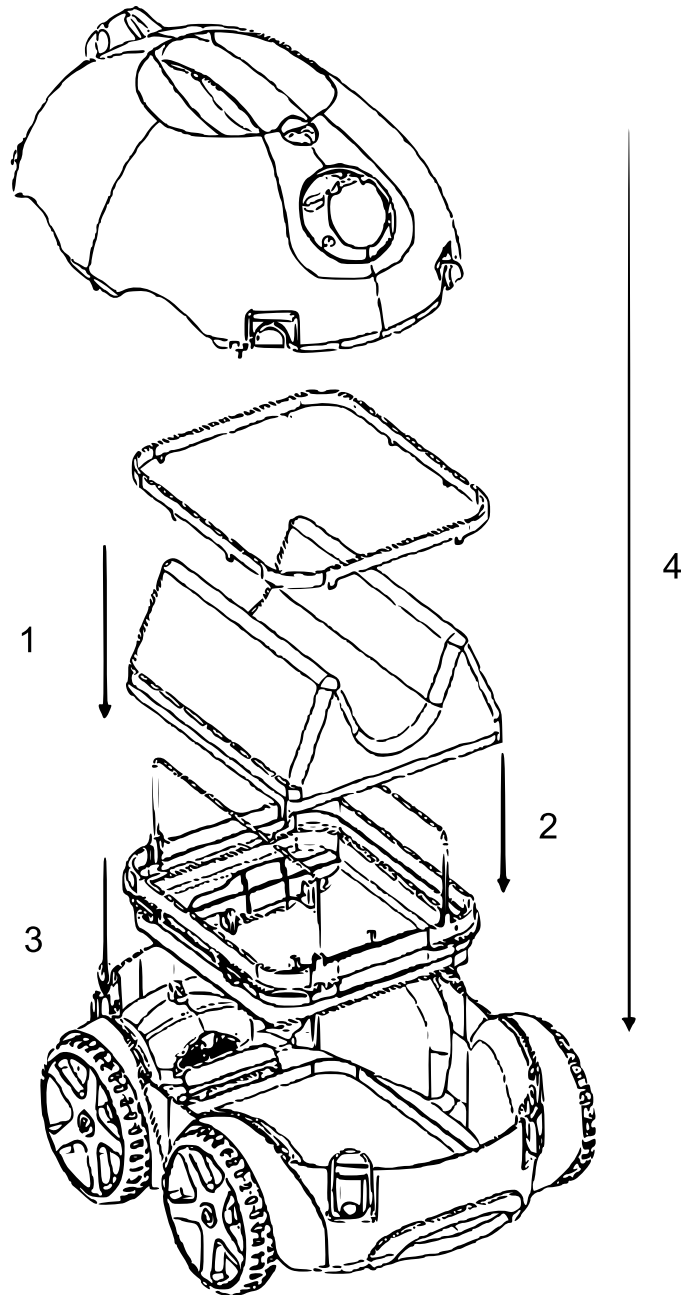

Technical specifications

Nominal intake voltage (V)		220
Nominal intake frequency (Hz)		50
Output voltage (V)		24 (DC)
Operational cycle (h)		1 / 1.5 / 2 / 2.5
Length of cable (m)		12
Max. cleaning surface (m²)		150
Filter capacity (m³/h)		15
Filter ability (µm)		150
Operational water temperature (°C)		10–35
Speed (m/min)		15–18
Protection class	Cleaning robot	IP68
	Power-supply unit	IPX4
Working temperature (°C)		10–40
Pool depth (m)		2.5
Max. inclination/slope (°)		25

Operation

Cable connection

Plug the cable into the socket of the power-supply unit (**Attention!** Make sure that the plug is correctly oriented!) and screw both nuts on either side of the plug to tighten them.

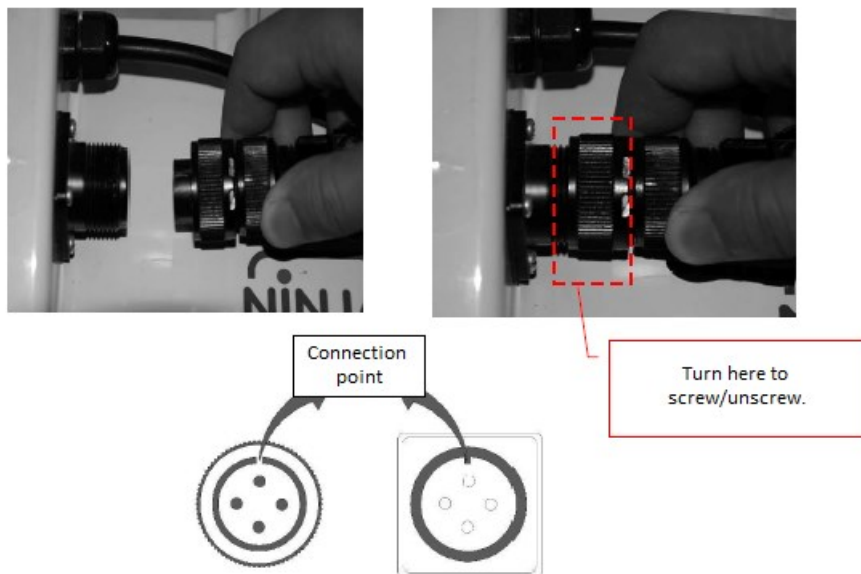

Then plug in the plug to the mains.

Control panel

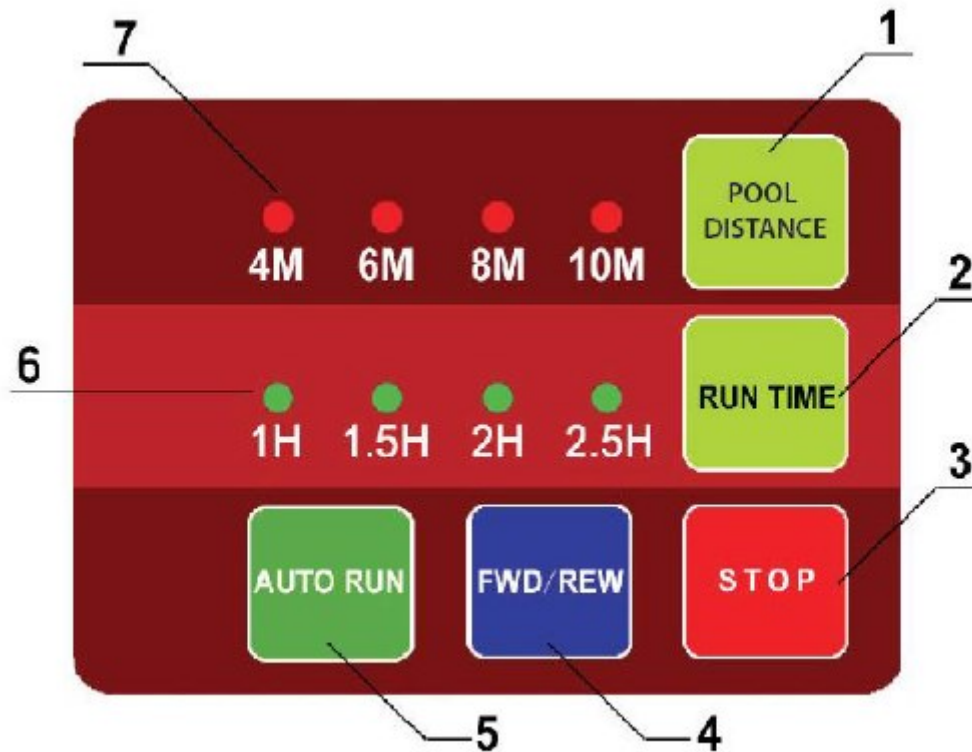

No	Name	Explanation	Function
1	POOL DISTANCE	Wall distance button	Setting the pool width
2	RUN TIME	Automatic service time button	
3	STOP	Stop button	
4	FWD/REW (forward/rewind)	Manual forward/backward movement	Moving the robot to a precise spot
5	AUTO RUN (automatic operation)	Automatic operation button	Cleaning robot is working automatically.
6		Operational time display for automatic operation	
7		Pool width display	

Function and adjustment of nozzles

The robot has two nozzles, one of which opens when the other closes. Water flows through the opening nozzle to move the cleaning robot forward. The user can change the orientation of the nozzle by turning it to control the track that the robot takes.

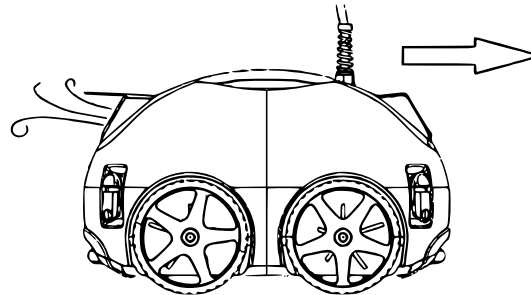

Adjustment of nozzle, speed, and track

- In general, cleaning is more efficient when the robot runs more slowly.
- The larger the curve described by the track, the less the cable is twisted.

Overlapping tracks and different settings of the nozzles

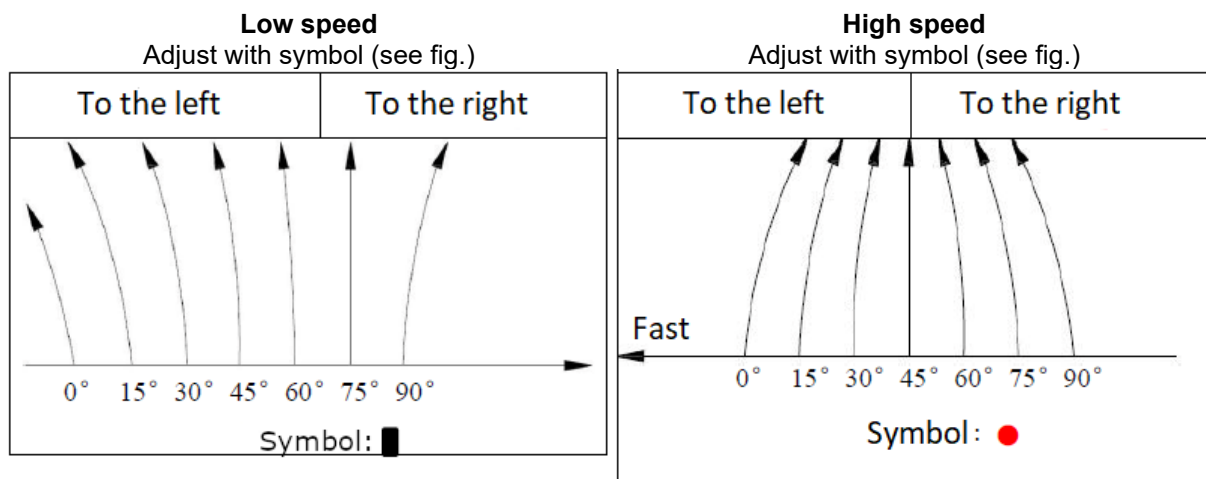
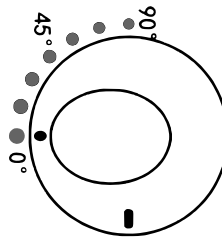

The user can select the appropriate nozzle orientation for different pool types, e.g., a low speed with a large radius of movement, by setting the circle symbol \circ to the 45° position (movement to the left) or 75° position (movement to the right).

Nozzle adjustments

- In most cases, the same orientation of both nozzles is suitable for every pool shape.
- A curved and direct track alternate if one of the nozzles is set to 30° and the other to 60°; this will permit that a very large portion of the floor be covered, and it will help to release any cable twists.

Distance adjustment

- On the control panel, select a suitable pool distance according to the pool width.
- It is recommended to select a larger distance if the nozzle is set to a low speed or if your pool is sloped. With a pool of 6 m of width, it is recommended to select an 8 m or 10 m distance if the robot is to run slowly.

Sloped pool adjustments

Set the nozzle to a high speed, so that the robot can cope with the slope, by reinforcing the water flow rate of the robot (see fig. concerning high speed).

Note! With some pool shapes, it cannot be guaranteed that the cleaning robot can cover the entire surface of the floor. You can adapt the nozzle orientation to reduce the moving curve ; however, that means that the cable will be twist more often.

Recommended nozzle orientation

Direction of higher speed

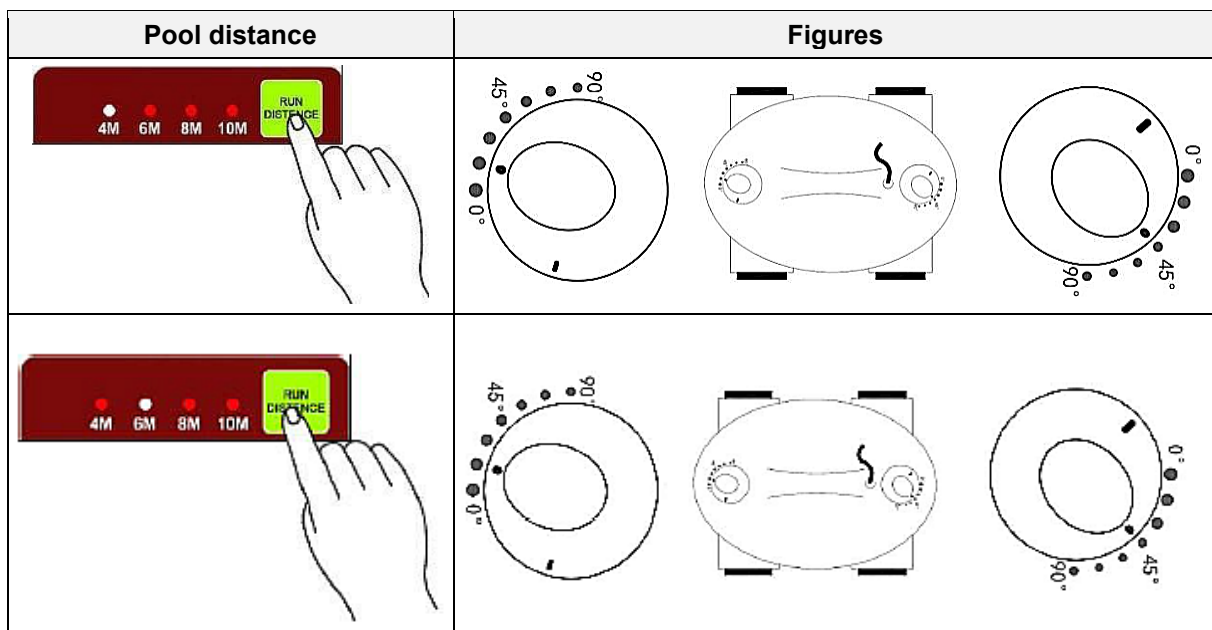

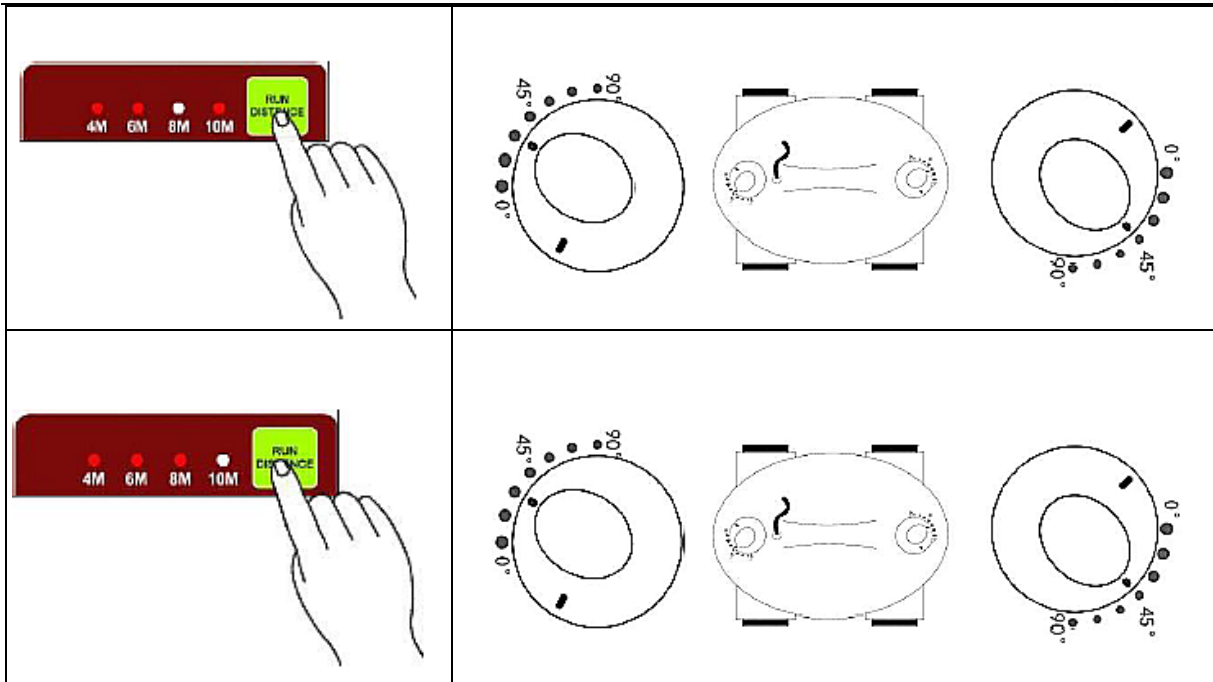

Direction of lower speed

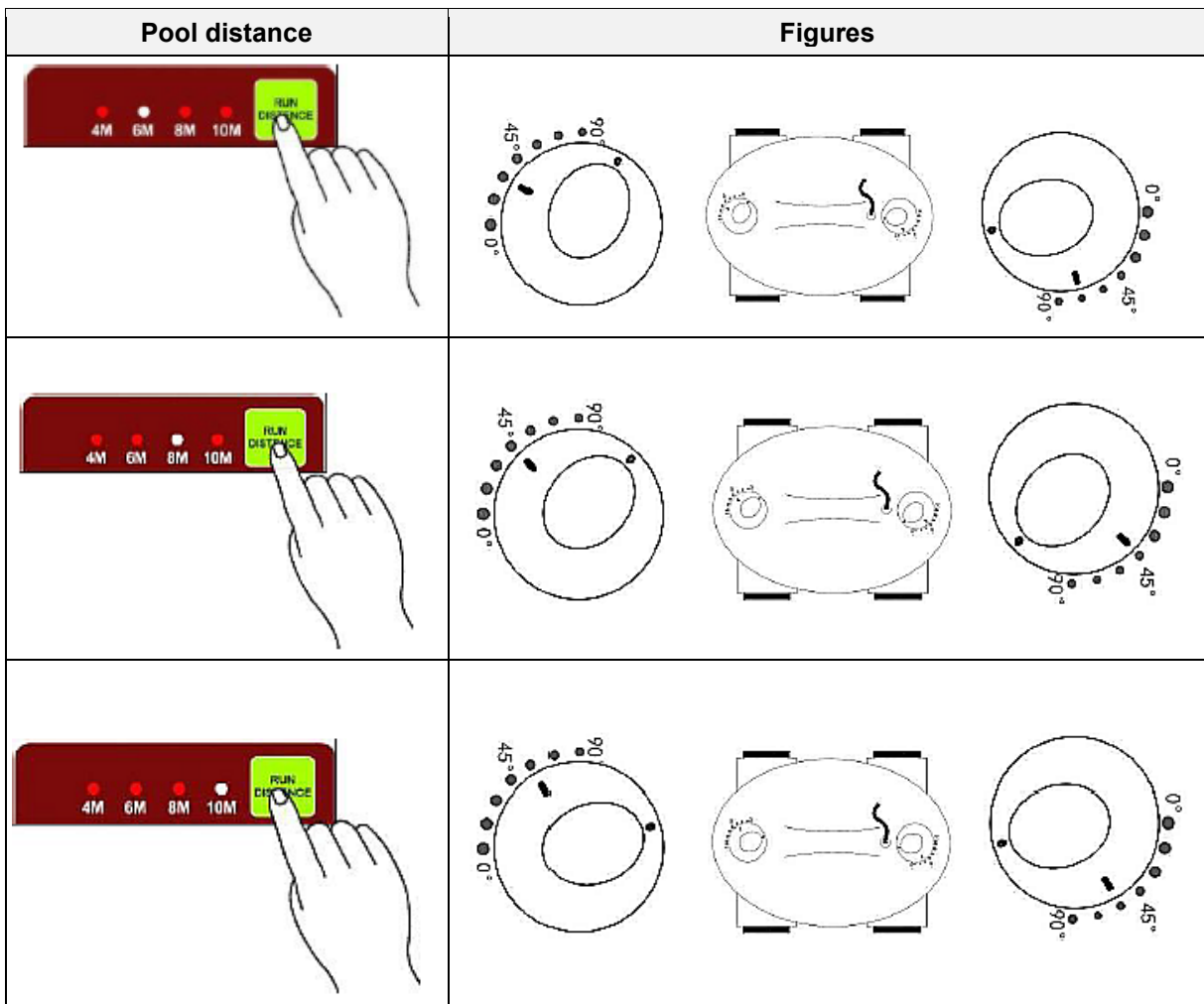

Sloped pool

Pool distance	Figures		
Depending on pool size			

Note! The above-mentioned values are recommendations. The user must adapt the suitable nozzle orientation considering the above-mentioned procedure and the actual pool.

Placing the cleaning robot into the water

1. With one hand, hold the cable, making sure that there is enough cable between your hand and the robot that the device can plunge into the water without however touching the floor. With the other hand, hold the handle of the cleaning robot and slowly place the device into the water.

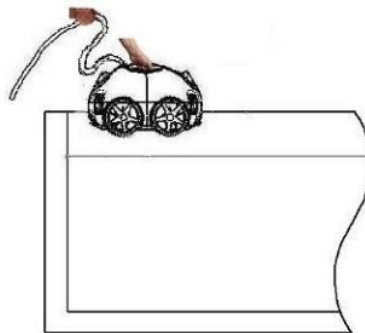

2. Hold the cable until the robot has filled itself with water and begins to sink towards the floor.

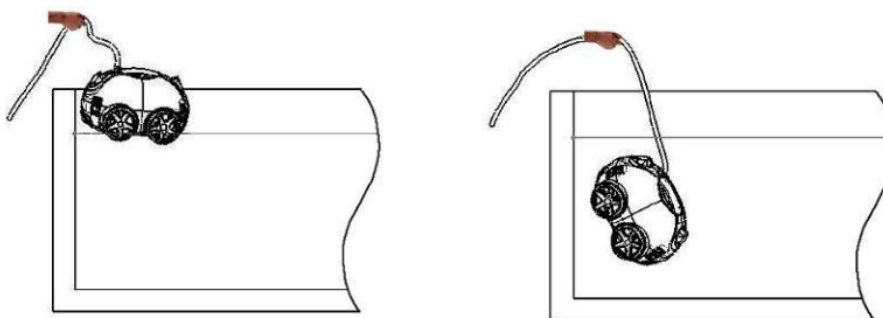

3. By obeying the above procedure, you will avoid that the cleaning robot tip over.

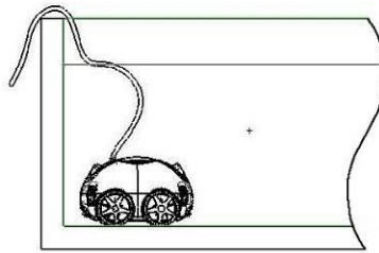

Cleaning the filter bag

Taking out the bag

1. Open the retaining ring and the robot.

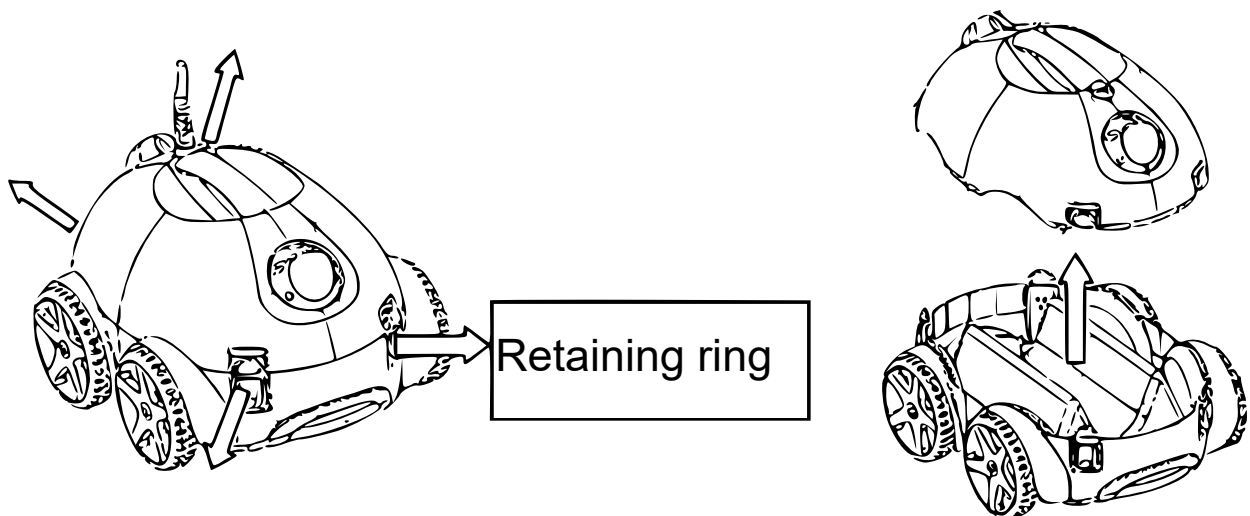

2. On one side, press down the bracket and lift the filter unit.



3. Remove the filter unit.

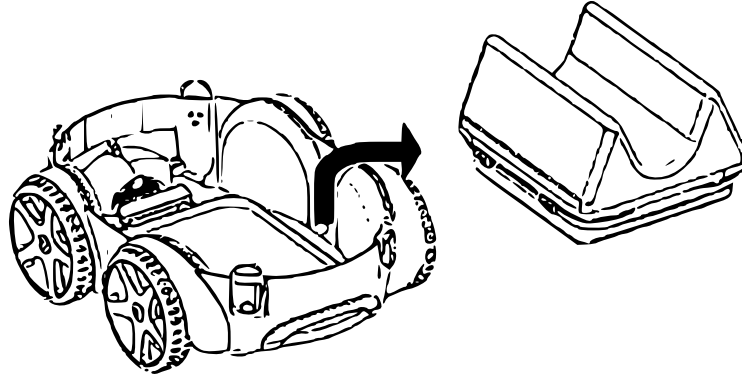

4. Open the small bracket and take out the filter bag for cleaning.

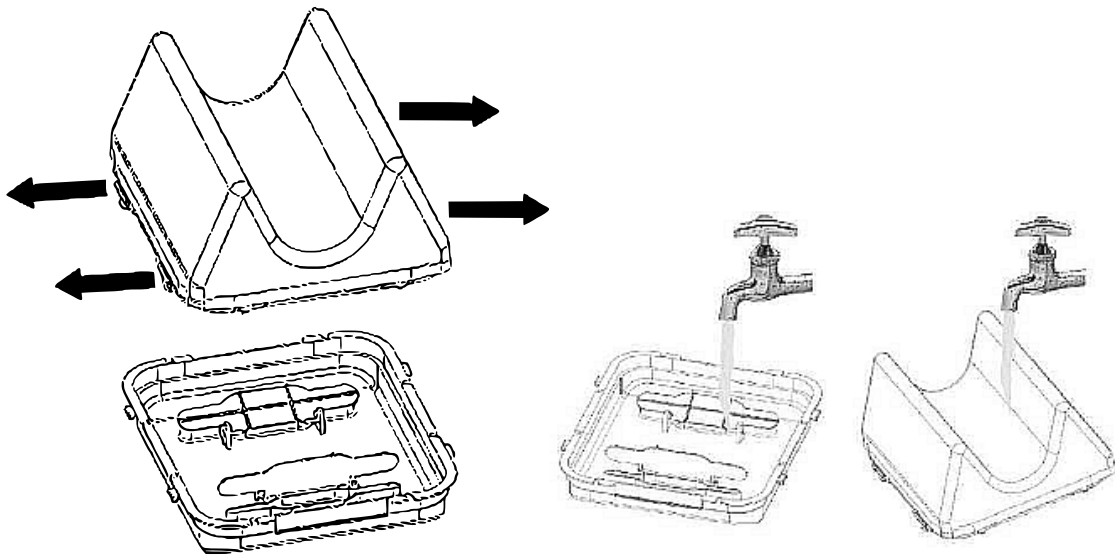

Reinstall

Reinstall the filter unit. Insert one side of the filter cartridge into the bracket.

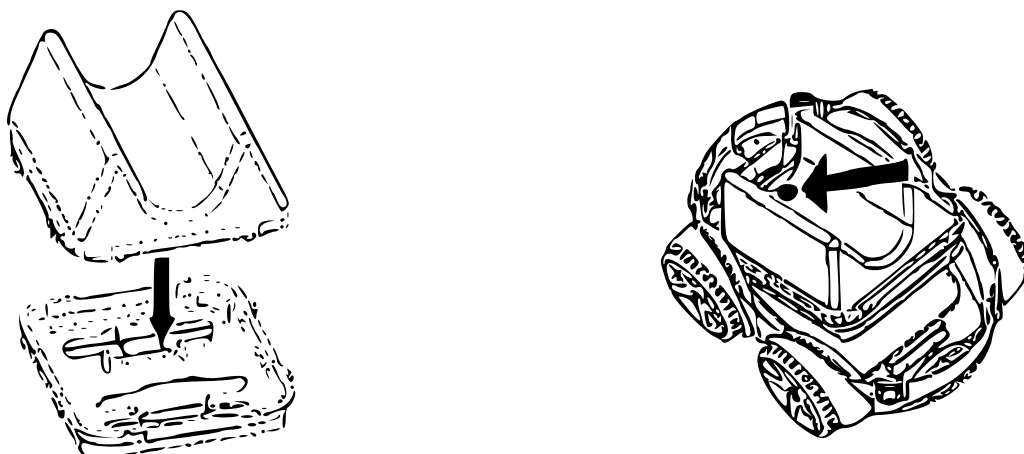

Press down the bracket on the opposite and correctly place the filter unit.

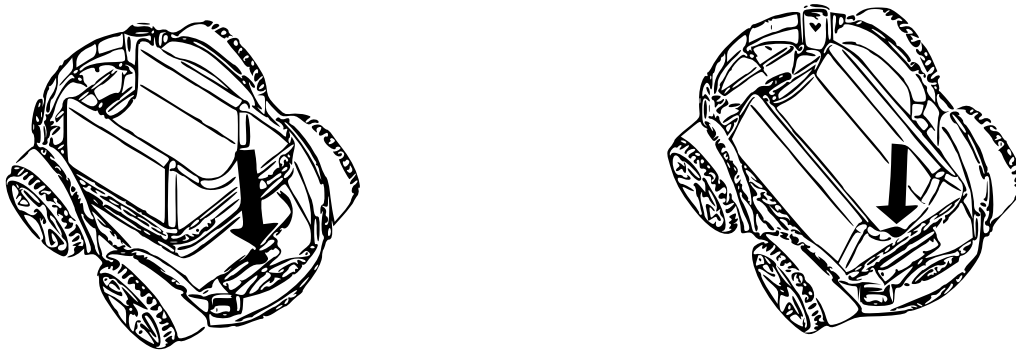

Replacing the filter bag

Insert a new filter bag if the old one is damaged. Obey the steps of the following figure.

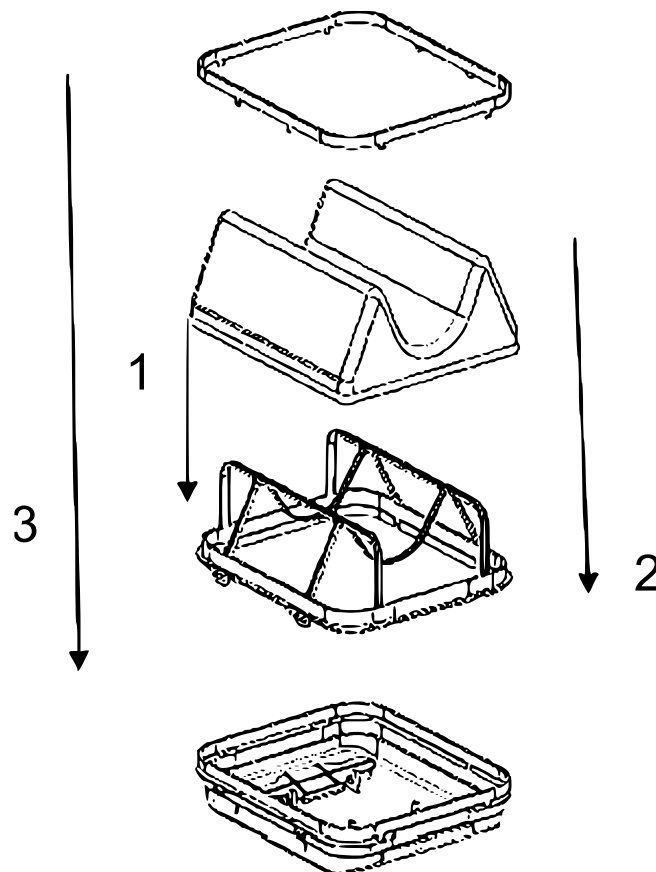

Helpful hints

- Unplug the plug after use. However, do not plug it out with your hands being wet.
- The cleaning robot should not touch the pool walls when you take it out of the water to avoid that the surface of the pool be scratched or the robot be damaged.
- Before taking the robot out and placing it on the edge of the pool, hold it above the water surface during approx. 10–15 s to allow the water remaining inside the casing to drain off.
- Hold the robot at the handle to take it out of the pool.



Troubleshooting

Problem	Possible cause	Solution
Cable twists itself or coils up	1. Cable not completely unwound	1. Unplug the plug and disentangle cable.
	2. Bad nozzle angle	2. Set water outlet to correct angle.
	3. Obstacle in the pool	3. Remove obstacle.
	4. Stuck to the main drain of the pool	4. Switch off filter system of the pool.
	5. Long operational time	5. Disentangle cable by hand.
Robot does not cover the entire surface of the floor	1. Power-supply unit incorrectly placed	1. Correctly place the power-supply unit so that the robot can reach every spot.
	2. Nozzle badly oriented	2. Set nozzle to correct orientation.
	3. Unusual pool shape	3. Set nozzle so that the moving radius increases.
	4. Filter system and pump switched on	4. Switch off filter system of the pool.
	5. Cable too short	5. Unwind cable further.
Cleaning robot does not run	Bad connection of mains cable/plug.	Correctly plug in mains cable/plug.

Regulations for waste disposal

The Waste Electrical and Electronic Equipment Directive (WEEE Directive, 2012/19/EU) of the EU was implemented in the German law related to electrical and electronic equipment and appliances.

All WiITec electric devices that fall under the WEEE directive are labelled with the symbol of a crossed-out wheeled rubbish bin. This symbol indicates that this electric device must not be disposed of with the domestic waste.

WiITec Technik GmbH is registered with the German registration authority EAR (Stiftung Elektro-Altgeräte Register) under the WEEE-registration number DE45283704.

Disposal of used electrical and electronic devices (intended for use in the countries of the European Union and other European countries with a separate waste collection system for these devices).

The symbol on the packaging or the product itself indicates that this product must not be treated as normal domestic waste but must be disposed of at a recycling collection station for electrical and electronic waste.

By disposing of this product correctly, you contribute to the protection of the environment and the health of your fellow people. Inappropriate disposal threatens the environment and health.



Material recycling helps to reduce the consumption of raw materials.

Additional information about the recycling of this product can be provided by your local commune, the municipal waste disposal facilities, or the store where you purchased the product.

Address:
WiITec Wildanger Technik GmbH
Königsbenden 12 / 28
52249 Eschweiler Germany

Important Note:

Reproduction and any commercial use (of parts) of this operating manual, requires a written permission of WiITec Wildanger Technik GmbH.