

Safety instructions

- Ensure that the jack pads are checked for cracks, breaks, or other damages before each use.
- Never exceed the maximum load weight of the pads (1000 kg per pad).
- Ensure that all movable or detachable parts such as the metal pins in the support plates are securely fastened.
- Do not make any modifications to the pads, as this can affect the structure and safety.
- Avoid using the support plates near unattended children and pets.

Usage instructions

- Ensure that the top of the pads is horizontally aligned before placing anything onto them. Additionally, arrows on the top of the pads must point in the direction of travel to optimally distribute the weight of the caravan.
- Carefully place the heavy-duty supports of the caravan in the centre of the pads to ensure even weight distribution. Ensure that all supports are fully on the pads.
- Use the supplied metal pins and cotter pins to secure the pads permanently to the heavy-duty support of the caravan.
- Regularly check whether the supports of the caravan are secure and the support plates are stable and immovable.

Note! The jack pads should remain attached to the caravan during travel and do not need to be disassembled.

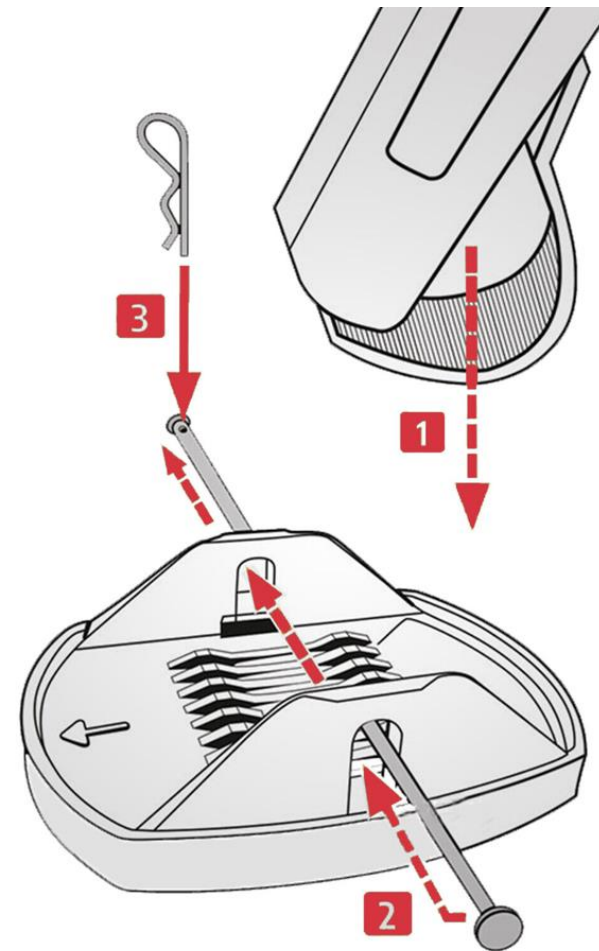

No	Name
1	Caravan support
2	Metal pin
3	Cotter pin