

User's Manual
Bending Machine
63426



Illustration similar, may vary depending on model

Read and follow the operating instructions and safety information before using for the first time.

Technical changes reserved!

Illustrations, functional steps, and technical data may deviate insignificantly due to continuous further developments.

Updating the documentation

If you have suggestions for improvement or have found any irregularities, please contact us.



The information contained in this document may alter at any time without prior notice. No part of this document may be copied or otherwise duplicated without prior written consent. All rights reserved. WilTec Wildanger Technik GmbH cannot be held liable for any possible mistakes in this operating manual, nor in the diagrams and illustrations shown.

Although WilTec Wildanger Technik GmbH has made every possible effort to ensure that this operating manual is complete, accurate, and up-to-date, errors cannot be ruled out entirely.

If you have found an error or wish to suggest an improvement, we look forward to hearing from you. Send us an e-mail to:

service@wiltec.info

or use our contact form:

<https://www.wiltec.de/contacts/>

The most recent version of this manual in several languages can be found in our online shop:

<https://www.wiltec.de/docsearch>

Our postal address is:

WilTec Wildanger Technik GmbH
Königsbenden 12
52249 Eschweiler – Germany

To return your goods for exchange, repair, or other purposes, please use the following address. Attention! To allow for a trouble-free complaint or return, it is important to contact our customer service team before returning your goods.

Retourenabteilung
WilTec Wildanger Technik GmbH
Königsbenden 28
52249 Eschweiler – Germany

E-mail: **service@wiltec.info**

Tel: +49 2403 55592-0

Fax: +49 2403 55592-15



Introduction

Thank you for choosing to purchase this quality product. To minimise the risk of injury, we ask you to always take some basic safety precautions when using this product. Please read this operating manual carefully and make sure that you understand it. Keep these operation instructions in a safe place.

Safety instructions/warnings

- Keep your working area proper and tidy. Untidy work areas invite accidents and injuries.
- Consider the conditions of your working area. Do not work in damp, wet, or badly lit areas. Do not expose the device to rain. Always make sure that your working area is sufficiently lit.
- Keep children away from your working area. Children must not be near the work area. Never allow children to use the device.
- Store non-used equipment. During non-use of this device, it must be stored within a dry room to prevent rust from forming. Keep the device out of children's reach if possible.
- Never apply excessive force on a tool or machine. These will do a better and safer job if used within the scope of performance that they have been designed for.
- Always use the appropriate tool. Do not use small tools or accessories for work that would need to be done with a large industrial machine. Never use tools or devices for work that they have not been designed for.
- Wear appropriate clothing. Do not wear loose clothing or jewellery that could get caught in moving parts. It is advisable to wear protective work gloves and anti-slip shoes. Tie long hair together to avoid it getting caught by the machine.
- Secure the workpiece to be machined. Use clamps or a vice that keep the workpiece at the same place. This is safer than holding it by hand and frees both hands to operate additional tools.
- Do not stoop down too far. Ensure a safe stand and keep your balance.
- Maintain your tools with care. Keep tools proper to ensure their functioning reliably and safely. Obey the instructions on lubricating and replacing accessory parts. Always keep the handles clean, dry, and free from oil and grease.
- Stay alert. Fully concentrate on the job to be done and use common sense when working. Do not use any tools, machines, or devices when you are tired.
- Before operating any tool or device, check it for damaged components. Any part that could be damaged must be checked properly for its operability. Check the alignment of moving parts and ensure that they are not blocked or otherwise damaged. Any damage should be repaired or replaced correctly by a specialist.
- For repair, only use identical spare parts. Only use the appropriate accessories.

Machining round steel

The bending machine must be secured to a jaw vice or T-slot plate.



1. Insert two 13 mm shafts.
2. Hold the workpiece between the block and fixed shaft.
3. Rotate the handle a quarter turn to form a right angle (90°).



1. Insert an appropriately sized circle forming piece.
2. Hold the workpiece between the block and circle forming piece.
3. Loosen the handle after the right angle has been formed.
4. Move the clamping point of the workpiece and gradually turn the handle until a ring forms as shows.



Depending on the size chosen and the appropriate forming pieces, the workpiece can be bent to form semi-circles, full circles, or different bends.

Machining flat steel



1. Insert an appropriate circle forming piece and angle forming piece.
2. Hold one end of the flat steel between the circle forming piece and angle forming piece, form an angle, then loosen the handle.
3. Move the clamping point of the workpiece and gradually turn the handle until a ring forms as shown.

Note! To form different shapes, you can choose different clamping points.



1. In case you wish to bend several portions of identical length, you can use the adjustment pin to define the length of the workpiece.
2. Insert the pin into the adjustment hole of the bending machine, then slide it until it has the correct length, and tighten the small rotary knob.



Using an appropriate angle piece and the appropriately adjusted pin, you can form your workpiece as shown; so, you will be able to shape square workpieces, e.g.

Exploded view and parts list

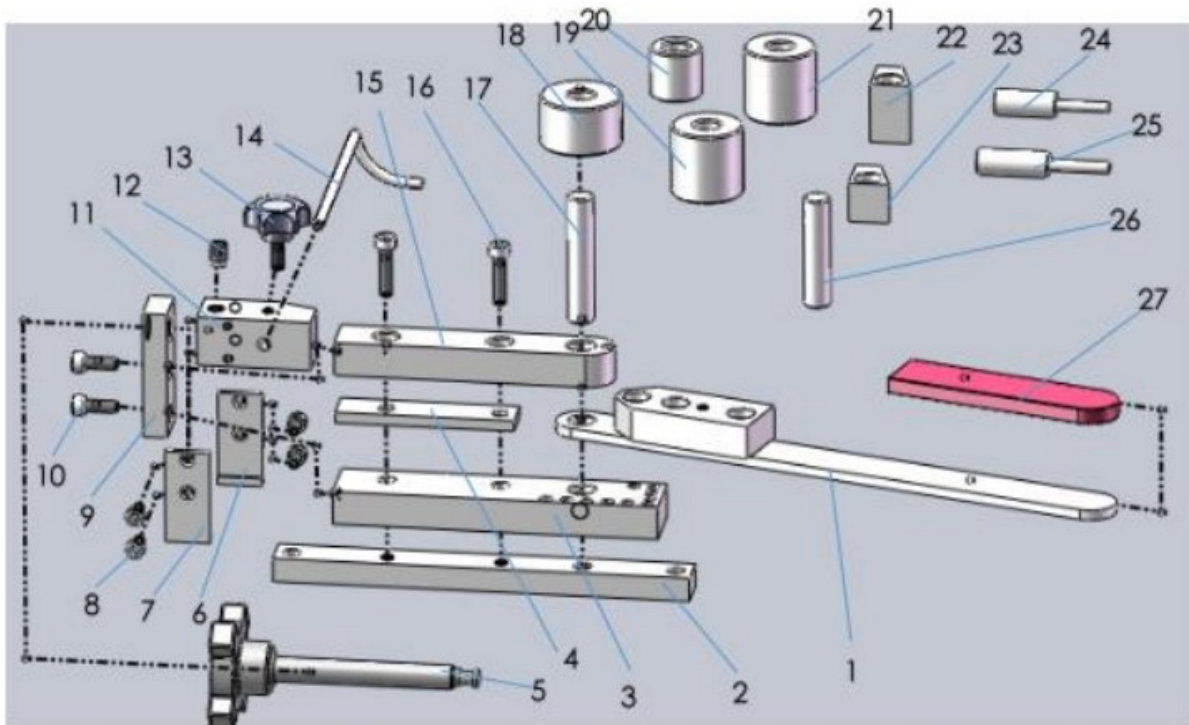

No	Name	Qty.	No	Name	Qty.
1	Handle	1	15	Guide rail	1
2	Base plate	1	16	Hexagon socket screw (M6×25)	2
3	Work plate	1	17	Shaft (13 mm)	1
4	Small plate	1	18	Circle forming piece (40 mm)	1
5	Screw		19	Circle forming piece (30 mm)	1
6	Right plate	1	20	Circle forming piece (25 mm)	1
7	Left plate	1	21	Circle forming piece (35 mm)	1
8	Hexagon socket screw (M5×10)	4	22	Long angle forming piece	1
9	Connecting plate	1	23	Short angle forming piece	1
10	Hexagon socket screw (M6×16)	2	24	Shaft (5 mm)	1
11	Block	1	25	Shaft (6 mm)	1
12	Fixing bolt (M8×12)	1	26	Short shaft (13 mm)	1
13	Rotary knob (M6×16)	1	27	Rubber cover for handle	1
14	Adjusting pin	1			

Important Note:

Reproduction and any commercial use (of parts) of this operating manual, requires a written permission of WilTec Wildanger Technik GmbH.