

User's Manual

3-in-1 Leaf Blower

63897



Illustration similar, may vary depending on model

Read and follow the operating instructions and safety information before using for the first time.

Technical changes reserved!

Illustrations, functional steps, and technical data may deviate insignificantly due to continuous further developments.

Updating the documentation

If you have suggestions for improvement or have found any irregularities, please contact us.



The information contained in this document may alter at any time without prior notice. No part of this document may be copied or otherwise duplicated without prior written consent. All rights reserved. WilTec Wildanger Technik GmbH cannot be held liable for any possible mistakes in this operating manual, nor in the diagrams and illustrations shown.

Although WilTec Wildanger Technik GmbH has made every possible effort to ensure that this operating manual is complete, accurate, and up-to-date, errors cannot be ruled out entirely.

If you have found an error or wish to suggest an improvement, we look forward to hearing from you. Send us an e-mail to:

service@wiltec.info

or use our contact form:

<https://www.wiltec.de/contacts/>

The most recent version of this manual in several languages can be found in our online shop:

<https://www.wiltec.de/docsearch>

Our postal address is:

WilTec Wildanger Technik GmbH
Königsbenden 12
52249 Eschweiler – Germany

To return your goods for exchange, repair, or other purposes, please use the following address. Attention! To allow for a trouble-free complaint or return, it is important to contact our customer service team before returning your goods.

Retourenabteilung
WilTec Wildanger Technik GmbH
Königsbenden 28
52249 Eschweiler – Germany

E-mail: **service@wiltec.info**

Tel: +49 2403 55592-0

Fax: +49 2403 55592-15



Introduction

Thank you for choosing to purchase this quality product. To minimise the risk of injury, we ask you to always take some basic safety precautions when using this product. Please read this operating manual carefully and make sure that you understand it. Keep these operation instructions in a safe place.

Warning: For your own safety, read this instruction manual before operating your new device. Non-compliance with any of the following instructions might lead to serious injuries. Familiarise yourself with the operation of the leaf blower before operating it.

Proper use

The device is intended to be used for blowing leaves and natural waste from the garden and must not be used for other purposes.

Symbols on the device



Thoroughly read the operating manual before use.



Keep bystanders away. Never operate the device whenever people, especially children, and animals are too close.



Wear protective glasses to protect your eyes during use.



Wear a hearing protection to protect yourself from noise.



Keep your hands away from moving parts (impeller).

Safety instructions

Caution: Thoroughly read the safety notes before operating the device.

Familiarise yourself with the device

- Carefully read the operating instructions until you have fully understood and are able to follow all warnings and safety advice before you start using the device.
- Limit the use of the device to users who understand and will follow all warnings and safety instructions in this manual.

Safety within working area

- Remove debris or grass clippings from driveways, pavements, patios, etc.



- Blow the clippings, straw, and leaves in a pile.
- **Warning:** Examine the work area before starting the device. Remove all debris and hard objects such as rocks, glass, wire, etc. that could ricochet or be thrown, causing injury or damage during operation.

Personal safety

- Always wear protective glasses and ear protection when using and maintaining the device. Stirred stones or debris could otherwise be thrown in your eyes or face and lead to serious injuries and/or blindness.
- Always wear safety shoes. Never use the device barefoot or wearing sandals.
- Always wear a dust or face mask when working in a dusty environment.
- Tie hair together that exceeds shoulder length. Secure or remove any jewellery, loose clothing, loose straps, ribbons, fringes, etc., as they could be caught by moving parts.
- Never work with the leaf blower if you are tired or feel ill, or if you are under the influence of alcohol, drugs, or medicine.
- Keep children, animals, and other bystanders at least 15 m from your work area when you start or use the device. Never point the air nozzle at other people or animals.
- Do not operate the device without having installed the inlet cover to avoid any contact with the rotor.
- Do not operate the device for an excessively prolonged time. Make regular breaks.

Fuel-handling safety

- Eliminate all sources of sparks or flames (including jobs that may cause sparks) and do not smoke in areas where fuel is mixed, poured, or stored.
- Mix and pour fuel in an outdoor area. Store fuel in a cool, dry, well-ventilated place. Use an approved, labelled container for all fuel purposes.
- Do not smoke when handling fuel or operating the device.
- Make sure that the device is properly installed and in good working condition.
- Do not fill the fuel tank when the engine is hot or running.
- Avoid spilling fuel or oil. Wipe up any fuel spills before starting the engine.
- Before starting the engine, move at least 3 m from the fuel and the refuelling point.
- Always store fuel in a container approved for flammable liquids.
- **Warning:** Only use the fuel approved for operation of this device as stated in this instruction manual. Only use petrol correctly mixed with 2-stroke-motor-lubricant.
- Do not operate the device without the exhaust pipe and cover being properly installed.
- Do not come into contact with the hot exhaust pipe and spark plug wire.
- Never operate the device in narrow or badly ventilated areas, for exhaust fumes form.

Safety of operation

- This leaf blower is only suitable for blowing together leaves and other debris on the ground.
- Operation of the device should be limited to technically experienced and properly trained persons.
- Before each use, inspect the device for worn, loose, missing, or damaged parts. Only operate the leaf blower when it is in perfect condition.
- Always remove oil and fuel from the housing. Never start the device in closed rooms or buildings. **Inhaling exhaust gases can be fatal!**
- Exhaust systems can get very hot and will remain so for some time after stopping. This also applies to idle use. Contact can cause burns to the skin. Think about the **fire hazard!**
- To avoid static electric shock, do not wear rubber gloves or other insulated gloves during operation.
- Do not place the device on any surface other than a clean, hard area while the engine is running. Foreign objects such as gravel, sand, dust, grass, etc. can be picked up by the air inlet and ejected through the exhaust opening, which can damage the device or property, or cause serious injury to bystanders or the user.



- Avoid dangerous environments. Do not work in unventilated rooms or in places where explosive gases or carbon monoxide can develop.
- Do not work on unstable surfaces such as ladders, trees, steep slopes, roofs, etc. Make sure that you keep balance and stand securely at all times.
- Hold the device so that leaves blown together are not directed towards persons, animals, glass, and solid objects such as trees, cars, walls, etc. The air discharge pressure can throw up stones, dirt, or sticks and thereby injure people and animals, break glass, or cause other damage.
- Only operate the device with the suitable accessories. Always mount the blowpipes. Switch off the device before placing it on the ground, before fixing accessories, or removing them.
- The blower opening and tubes must be checked regularly. The engine must be switched off and the spark plug connector removed. Keep vents and exhaust pipes free of debris to ensure proper airflow.
- Never use the device to spray chemicals, fertilisers, or other substances that may contain toxic substances.
- To prevent fire spreading, do not use the device near burning branches or bushes, chimneys, barbecue areas, ashtrays, etc.
- Only use the device according to the intended use defined in this manual.
- Tighten all screws and fixing elements and keep the device in good operating condition. Never operate it if it has been adjusted incorrectly or mounted incompletely and insecurely.
- Always keep the handles clean, dry, and free from oil and grease.
- Operate the device at appropriate times of the day – neither too early in the morning nor too late in the evening – to avoid disturbing persons. Refer to the times listed in local ordinances. Working hours between 9 a.m. and 5 p.m. from Monday to Saturday are usually advisable. However, respect regulations referring to midday stillness.
- To reduce the noise level, operate the device at the lowest possible throttle speed to get the job done.
- Never place the hot engine near flammable material.

Safety of maintenance

1. Any maintenance work not listed in this manual should be performed by a qualified person.
2. The spark plug cap must be removed before servicing the device. This is not necessary for carburettor adjustments.
3. Use only recommended spare parts. The use of other spare parts can invalidate your warranty and damage your device.
4. Empty the fuel tank if the device is not used for a long time. Use the remaining fuel in the carburettor by starting the engine and running it until it stops by itself.
5. Do not store the device or fuel in a closed area where fuel exhaust gases can come into contact with sparks, open flames (e.g., from water heaters), electric motors or switches, stoves, etc.
6. Keep it in a dry place and out of children's reach.
7. Secure the device during transport so that it cannot skid, tip over, or fall down.

Residual risks

Even if the device is properly operated, it is not possible to eliminate all residual risks. The following risks can arise due to the construction of the device:

- damages to lungs if the user does not wear an effective protective mask.
- damages to hearing if the user does not wear an effective protection.
- damages caused by vibrations if the user operates the device during a long time, if it is not handled correctly, or if it is maintained improperly.

Warning: This machine generates an electromagnetic field when in operation. This field can affect the functioning of active or passive medical implants under certain conditions. To avoid the risk of serious injury or death, persons with a medical implant should consult their doctor and/or the manufacturer of the implant before using this machine.

Warning: Never remove, modify, or add components of or to the device. Otherwise, injuries and/or damages to the device might follow, and the manufacturer's warranty will be voided.

Technical specifications

Motor type	2-stroke motor (1E34F-1)
Spark plug type	L7T
Cubic capacity (cm³)	22
Tank capacity (ℓ)	0.5
Fuel type	Mixture (oil:petrol)
Mixing ratio	1:40
Motor power (kW / 1/min)	0.75 / 7500
Idle speed (1/min)	3000 ± 200
Rotation speed with nominal output (1/min)	6800
Starter type	Rope starter
Diameter of cylinder (mm)	34
Weight (kg)	7
Total dimensions (mm)	560×310×360
Carburettor type	Diaphragm
Ignition type	Electric ignition (CDI)

Mounting

Mounting the suction part

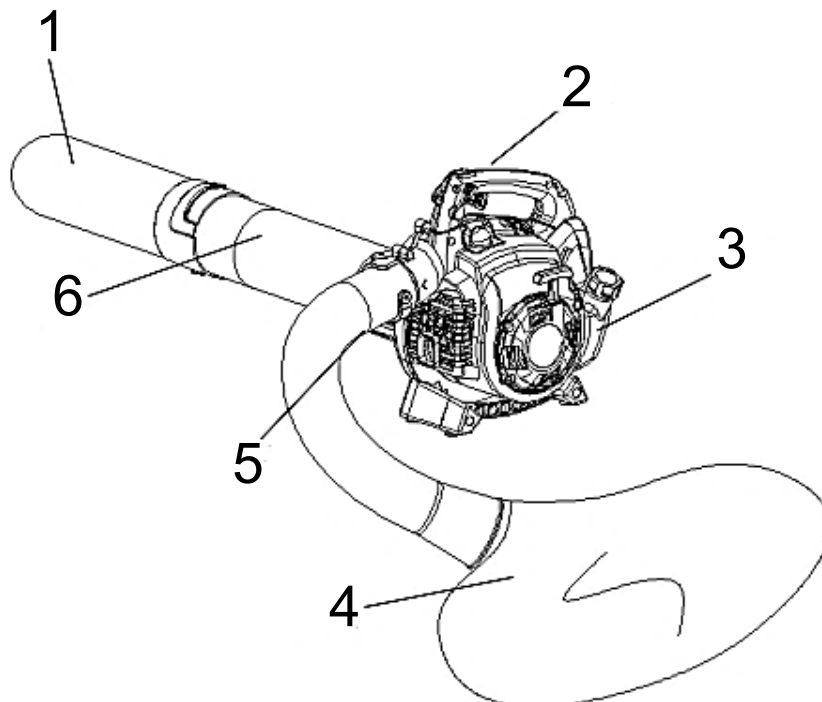

No	Name
1	Suction tube 1



2	Handle
3	Tank
4	Collecting bag
5	Lower handle
6	Suction tube 2

1. Open the cover of the fan, then connect suction tube 1 to suction tube 2.

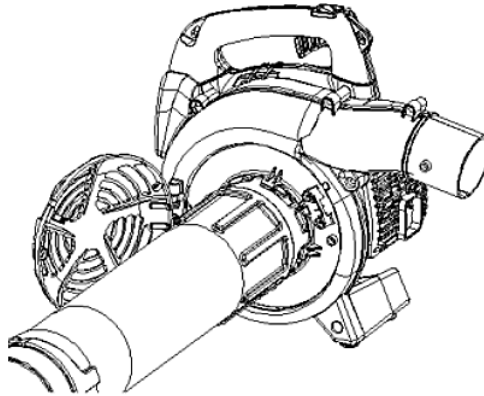

2. Introduce the discharge tube into the collecting bag, then secure this with the help of the fastening clamp.

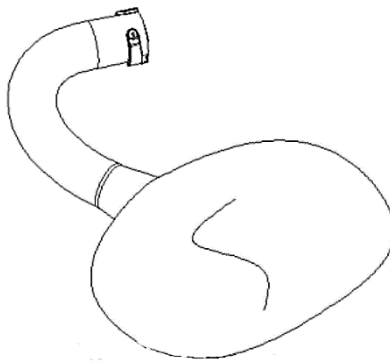

3. Connect the discharge tube to the device.

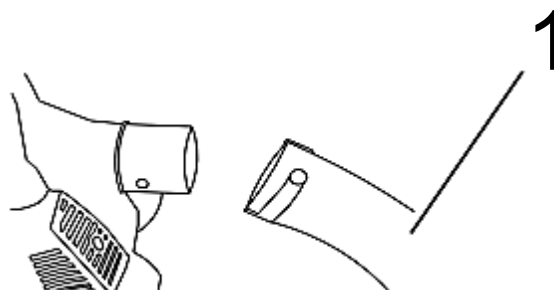

No	Name
1	Discharge tube

4. For reinforcing, use a M5×10 screw.

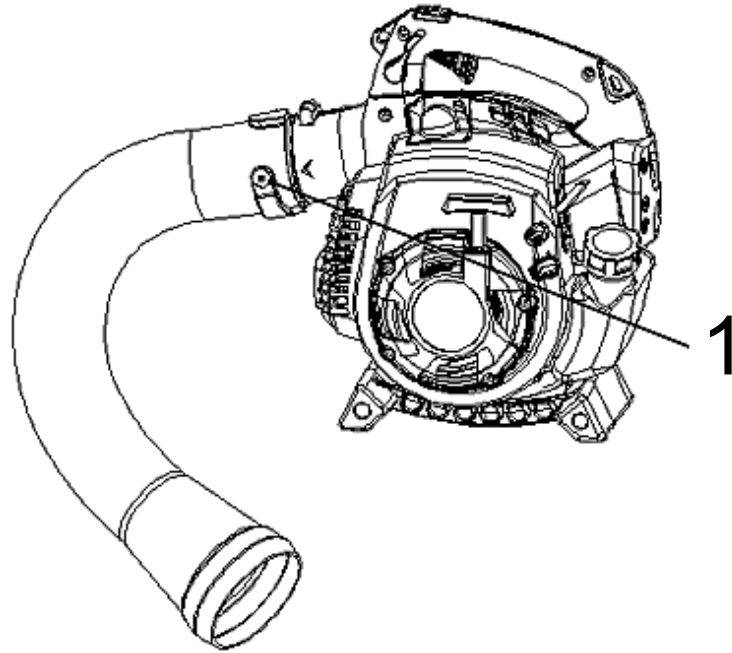

No	Description
1	Set in the M5×10 screw here.

Mounting the blower tube

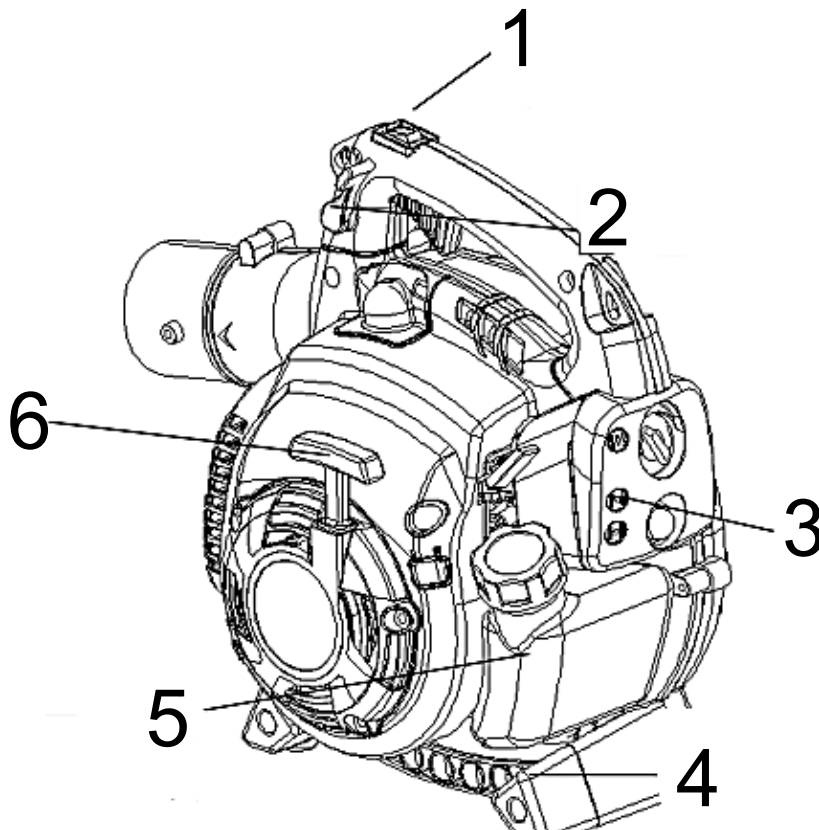

No	Name
1	Stop switch
2	Throttle control lever



3	Air filter cover
4	Lower handle
5	Petrol tank
6	Rope starter

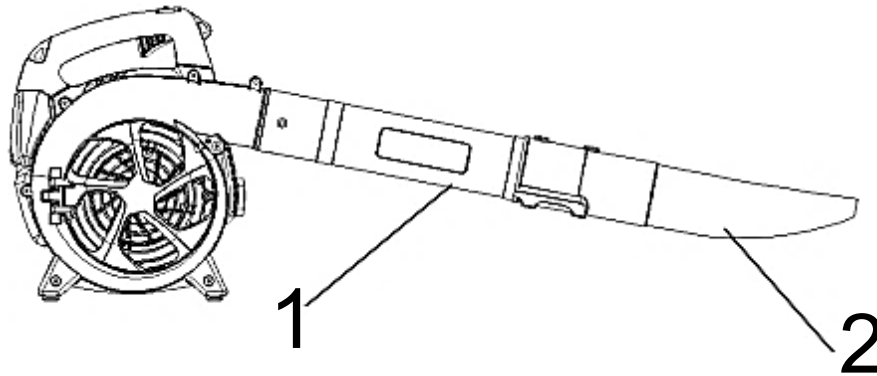

No	Description
1	Blower tube B
2	Blower tube A

1. Connect blower tube B to the machine.

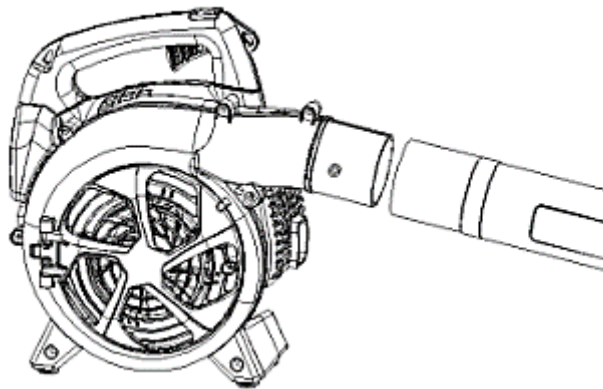

2. Set blower tube A to blower tube B by turning it.

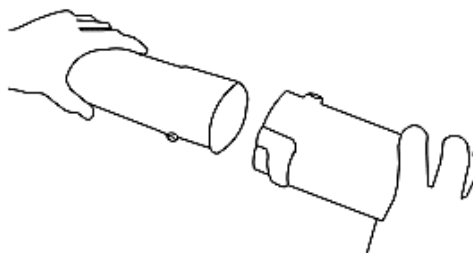

3. For reinforcing, use a M5×10 screw.

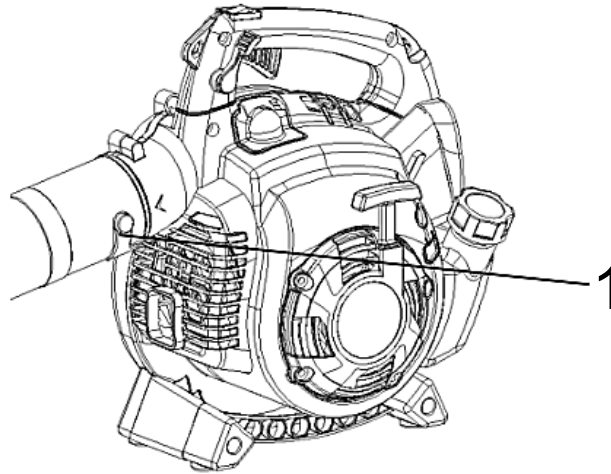

No	Description
1	Set in the M5×10 screw here.

Mixing fuel

⚠ Attention! Only mix the quantity of fuel directly necessary! In case fuel must be stored for a time longer than 30 days, it should be treated in advance with a stabiliser or similar product.

Requirements to the fuel

- Only use fresh, clean fuel.
- Only use fuel that has an octane number of 90 or higher.
- Mix the whole fuel with high-quality 2-stroke engine oil in a 1:40 ratio.

⚠ Warning! Fire hazard! Never transfer or store fuels near flammable material! Before starting the motor, set the machine down on a free area, and at a minimum distance of 3 m from any other fuels or flammable material.

Filling the tank

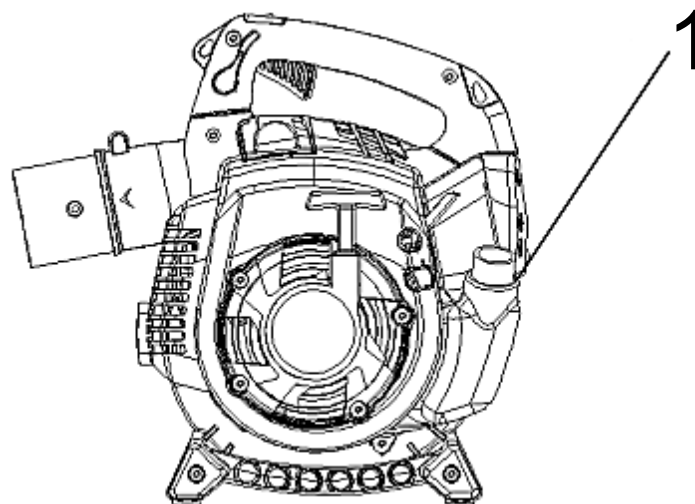

No	Description
1	Remove the tank cap.



1. Put the machine on the floor or a stable work surface and wipe off all contaminations around the tank cap.
2. Take off the tank cap.
3. Fill clean, fresh fuel into the tank.
4. Replace the cap and wipe off any spilt fuel before starting the machine.

Starting the device up

Attention!

- The rope starter can be damaged when misused.
- Never pull out the entire rope.
- Before starting the motor, first switch on the starter.
- Let the rope rewind slowly.
- Never start the machine if lines are damaged or missing.

Starting

1. Purge the fuel system by repeatedly pressing the primer until no more air bubbles are to be seen inside the fuel line.
2. **Only cold start:** Fully extend the throttle of the motor by pulling the throttle lever (throttle closed).
3. Place the machine to the floor and hold the handle of the machine with one hand.
4. With the other hand, slowly pull the starter rope until the motor begins to vibrate.
5. Now start the machine by rapidly pulling the starter rope up.
6. If necessary, Repeat the 5th step twice or thrice until the motor starts.

When the engine starts

 **Attention!** To achieve a highest possible suction power and service life, wait for the motor to warm up before using the device.

1. Let the motor run with idle speed until the operation temperature has been reached (after approx. 2–3 min.).
2. When the motor has warmed up, open the throttle step by step by slowly and fully retracting the throttle lever.
3. Now the machine should be operable.

When the engine does not start

Repeat the starting procedure. In case the motor still does not start, follow the “Starting a flooded engine” steps.

 **Warning!** Any incorrect installation of the spark plug might cause serious damage to the motor!

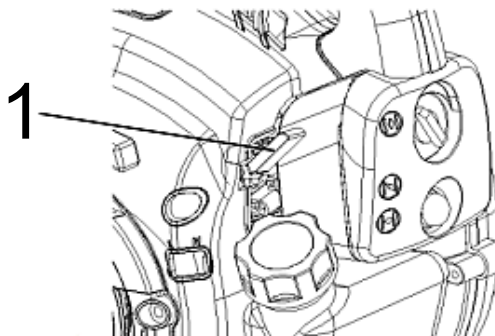



No	Description
1	Throttle lever

Starting a flooded engine

1. Move off the spark plug cable and use a spark plug wrench to remove the spark plug by turning it anti-clockwise.
2. If the spark plug is dirty or contaminated by fuel, clean or replace it.
3. Remove excess of fuel from the combustion chamber by repeatedly starting the engine with the spark plug removed.
4. Re-place the spark plug, then tighten it with the help of the spark plug wrench. If you have a torque wrench, tighten the spark plug to 16.7–18.6 Nm. Re-connect the spark plug cable.
5. Repeat the starting procedure with the motor being warm.
6. If the engine still will not fire or start, refer to the troubleshooting section at the end of this manual.

Setting the engine idle speed

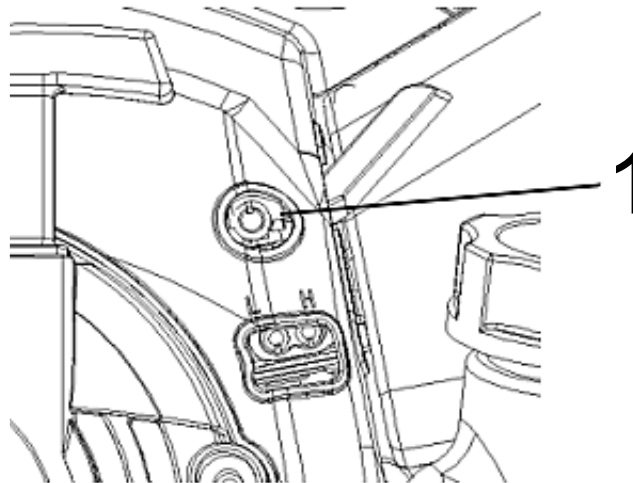

No	Description
1	Idle adjustment screw

1. Start the engine according to the procedures described previously.
2. Let the motor run with idle speed until the operation temperature has been reached (after approx. 2–3 min.).
3. Using a screwdriver, adjust the engine idle speed to 3000 ±200 rpm.
 - Turn the idle screw clockwise to increase the idle speed.
 - Turn the idle screw anti-clockwise to reduce the idle speed.

! Important! Hoses and intake manifolds must be installed when adjusting the engine idle speed. Engine idle speed will also be affected if the intake manifold or hoses are blocked, damaged, or incorrectly installed.

Turning off the engine

1. Allow the engine to cool down by idling for 2–3 min.
2. Stop the engine by pulling the stop switch.
3. Engine noise increases with higher throttle position. Always use the lowest throttle setting necessary to get the job done.

Sucking and blowing

Using the sucking function

If you use the suction function, check the collection bag in time. When full, unzip the collection bag and empty it.

Using the blowing function

Always pay attention to the strength and direction of the airstream. Never direct the blower exhaust stream at people or animals.



Warning! Before servicing this machine, shut off the engine and disconnect the spark plug cable.

- Clean dirt and debris from the outside of the blower.
- Check the engine, tank, and hoses for possible fuel leaks and repair them.
- Check the engine cooling fins for a build-up of dirt and debris and clean them if necessary.

Inspect the entire machine for damage, loose, or missing parts or fasteners and repair them if necessary.



Maintenance

Every 10 hours of operation (more often in dusty working conditions)

1. Loosen the air filter cover mounting screw and remove the cover and filter element.
2. Check the filter. If the filter element is deformed or damaged, replace it with a new one.
3. Clean the filter in clean fuel and squeeze it out or dry it with a hair dryer. Wash the air filter cover in clean fuel and wipe it clean or dry it with a hair dryer.
4. Insert the element and cover and tighten the cover fixing screw.

Every 10 to 15 hours of operation

1. Remove the spark plug with a spark plug wrench (turn it anti-clockwise).
2. Clean the spark plug gap and adjust it to 0.6–0.7 mm. Replace any damaged or visibly worn spark plug with a type L7RTC spark plug or equivalent.
3. Screw the spark plug into the cylinder head by hand, then tighten it securely with the spark plug wrench. If you have a torque wrench, tighten the spark plug to 16.7–18.6 Nm.

Every 50 hours of operation

- But more often if you notice decreased performance
- **Inspection:** Inspect the entire machine and hoses for damage, including loose or missing parts, and repair if necessary.
- **Spark plug:** Replace the spark plug with an L7RTC plug with a gap of 0.6–0.7 mm.
- **Fuel filter:** Using a wire hook, pull out the fuel filter from inside the fuel filter. Then remove the filter element and wash it in clean fuel.
- Before reinstalling the filter, check the condition of the fuel line. If any damage or deterioration is noted, the leaf blower should be withdrawn from service until it can be inspected by a qualified professional.



⚠ Attention!

- Never allow dirt or foreign bodies to enter the cylinder openings.
- Thoroughly clean the spark plug area and cylinder head before removing the spark plug.
- Let the engine cool down before servicing the spark plug.
- Incorrect installation of the spark plug can lead to severe engine damage.

Storage (30 days or more)

Cleaning

Thoroughly clean the outside of the device. Inspect the entire machine and hoses for damage, including loose or missing parts, and repair them if necessary.

Fuel

Drain the fuel tank and clean the carburettor and lines by running the machine until it stops due to lack of fuel.

Lubrication

Remove the spark plug, then pour about 7.5 ml of oil into the cylinder through the spark plug hole. Before reinstalling the spark plug, pull the recoil starter 2 to 3 times to spread the oil on the walls of the cylinder.

Air cleaner

Remove, clean, and reinstall the filter element.

Troubleshooting

Problem		Possible cause	Proposed solution
Spark plug does not fire	Spark plug	Wet poles	Dry.
		Carbon deposit	Clean.
		Insulation damaged	Replace.
		Wrong spark plug gap	Set to 0.6–0.7 mm.
	Magneto	Disturbance of the poles	Replace.
		Cable sheathing damaged	Repair or replace.
		Bad coil insulation	Replace.
		Coil wire damaged	Replace.
Spark plug works perfectly	Compression ratio and fuel delivery good	Electronic ignition unit defective	Replace.
		Too much fuel in the cylinder	Drain fuel.
	Good fuel delivery, but poor compression ratio	Presence of water or dirt in fuel	Replace.
		Worn or cracked cylinder and piston ring	Replace.
	Carburettor does not deliver fuel	Spark plug loose	Tighten.
		No fuel in tank	Add fuel.
	Filter clogged	Clean.	



		Tank air hole clogged	Clean.
--	--	-----------------------	--------

Problem		Possible cause	Proposed solution
Engine lacking power	Compression ratio is fine	Filter plate clogged	Clean.
		Air flows through connection	Tighten.
		Air led through connection of carburettor	Tighten.
		Engine overheating	Switch off engine and let it cool down. Avoid prolonged high loads and high speeds.
		Water in fuel	Fill in fresh fuel.
		Carbon clogging the exhaust	Clean.
	Engine overheating	Diluted fuel	Adjust carburettor.
		Cylinder covered with carbon	Clean.
		Poor oil	Use 2-stroke engine oil, adjust mixing ratio.
		Motor does not run properly (no nozzle)	Assemble machine correctly.
	Knocking noises in the engine	Poor fuel	Replace.
		Carbon in cylinder	Clean.
		Rotating parts worn and used	Check and replace.

Problem		Possible cause	Proposed solution
Motor stops during operation	Engine stops suddenly	Power plug lead wire loose	Have it replaced.
		Piston torn	Have it repaired.
		Spark plug covered with carbon	Clean spark plug.
		Fuel used up	Add fuel.
	Engine stops slowly	Carburettor clogged	Clean.
		Tank air hole clogged	Clean.
		Water in fuel	Fill in fresh fuel.

Regulations for waste disposal

The Waste Electrical and Electronic Equipment Directive (WEEE Directive, 2012/19/EU) of the EU was implemented in the German law related to electrical and electronic equipment and appliances.

All WilTec electric devices that fall under the WEEE directive are labelled with the symbol of a crossed-out wheeled rubbish bin. This symbol indicates that this electric device must not be disposed of with the domestic waste.

WilTec Technik GmbH is registered with the German registration authority EAR (Stiftung Elektro-Altgeräte Register) under the WEEE-registration number DE45283704.

Disposal of used electrical and electronic devices (intended for use in the countries of the European Union and other European countries with a separate waste collection system for these devices).

The symbol on the packaging or the product itself indicates that this product must not be treated as normal domestic waste but must be disposed of at a recycling collection station for electrical and electronic waste.

By disposing of this product correctly, you contribute to the protection of the environment and the health of your fellow people. Inappropriate disposal threatens the environment and health.



Material recycling helps to reduce the consumption of raw materials.

Additional information about the recycling of this product can be provided by your local commune, the municipal waste disposal facilities, or the store where you purchased the product.

Address:
WilTec Wildanger Technik GmbH
Königsbenden 12 / 28
52249 Eschweiler Germany

Important Note:

Reproduction and any commercial use (of parts) of this operating manual, requires a written permission of WilTec Wildanger Technik GmbH.