

User's manual

Camping Washing Machine

64217-64219

wiltec



Illustration similar, may vary depending on model

Please read and follow the operating instructions and safety information prior to initial operation.

Technical changes reserved!

Illustrations, functional steps, and technical data may deviate insignificantly due to continuous further developments.



The information contained in this document may alter at any time without prior notice. No part of this document may be copied or otherwise duplicated without prior written consent. All rights reserved. WilTec Wildanger Technik GmbH cannot be held liable for any possible mistakes in this operating manual, nor in the diagrams and illustrations shown.

Although WilTec Wildanger Technik GmbH has made every possible effort to ensure that this operating manual is complete, accurate, and up-to-date, errors cannot be ruled out entirely.

If you have found an error or wish to suggest an improvement, we look forward to hearing from you. Send us an e-mail to:

service@wiltec.info

or use our contact form:

<https://www.wiltec.de/contacts/>

The most recent version of this manual in several languages can be found in our online shop:

<https://www.wiltec.de/docsearch>

Our postal address is:

WilTec Wildanger Technik GmbH
Königsbenden 12
52249 Eschweiler – Germany

To return your goods for exchange, repair, or other purposes, please use the following address. Attention! To allow for a trouble-free complaint or return, it is important to contact our customer service team before returning your goods.

Retourenabteilung
WilTec Wildanger Technik GmbH
Königsbenden 28
52249 Eschweiler – Germany

E-mail: **service@wiltec.info**

Tel: +49 2403 55592-0

Fax: +49 2403 55592-15

Introduction

Thank you for choosing to purchase this quality product. To minimise the risk of injury, we ask you to always take some basic safety precautions when using this product. Please read this operating manual carefully and make sure that you understand it. Keep these operation instructions in a safe place.

Safety instructions

- The device is not intended for use by persons (including children) with impaired or limited physical, sensory, and mental abilities or lack of experience and/or real knowledge, unless they are supervised by a person responsible for their safety or follow the instructions made by this person on how to correctly use the device.
- Children should be supervised to ensure that they do not play with the device.
- Never connect the earth plug to a gas pipe, water pipe, telephone cable, or lightning conductor.
- Do not use the device in case the power cord or plug is damaged. **Danger of electric shock! Fire hazard!**
- Only use the hoses included. Old hoses must not be used again.



<p>Do not expose the washing machine to direct sunlight or rain.</p>	<p>Do not place the washing machine to a humid location.</p>	<p>Make sure that no water may contact the plugs and switches.</p>
<p>Let the water thoroughly drain from the drain tube.</p>	<p>Do not disconnect the plug by pulling the cable.</p>	<p>Keep the washing machine away from fire or sources of heat.</p>
<p>Do not wipe off the washing machine with flammable material (e.g., petrol).</p>	<p>Do not pour water exceeding 60 °C into the washing machine.</p>	

Parts

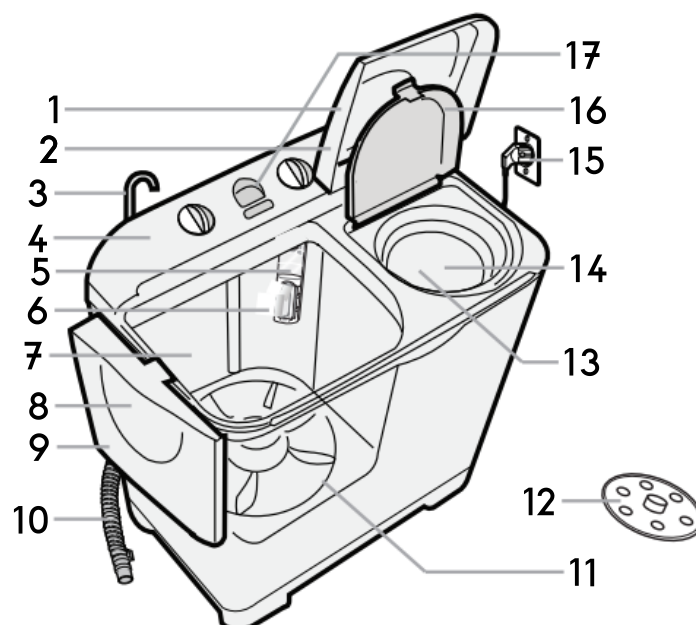

No	Name/description	No	Name/description
1	Spin-dryer lid — When opening the lid during spin-drying, the procedure is interrupted for safety reasons.	10	Drain hose (model without pump)
2	Cover of spin-dryer mechanism	11	Pulsator
3	Drain hose (model with pump)	12	Compensation disk cover
4	Control panel	13	Spin-drying drum
5	Fluff filter support	14	—
6	Fluff filter	15	Power cable
7	Washing drum	16	Inner spin-dryer cover
8	Washing drum cover — Make sure that the cover stays close during washing.	17	Water inlet
9	Rubbing lid – Some models are equipped with a rubbing lid. The rubbing lid is designed for rubbing very dirty clothes with detergent.		

Accessories

- Suction hose
- Connection of water inlet hose
- User's manual
- Compensation disk

Control panel

The control panel and water inlet vary depending on the model of the device. Refer to the control panel corresponding to your device.

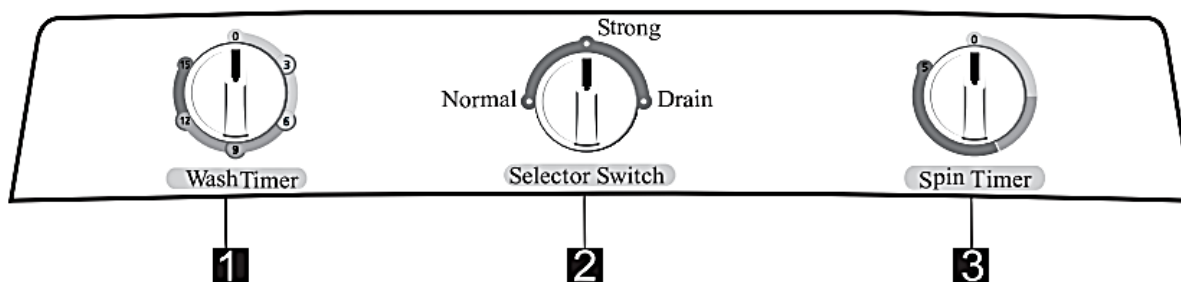

No	Name/description
1	Washing machine timer — for setting the washing time (1–15 min)
2	Selector switch — for switching over to the operational modes “Normal,” “Strong,” “Drain”
3	Spin-drying time — for adjusting the spin-drying time (1–5 min)

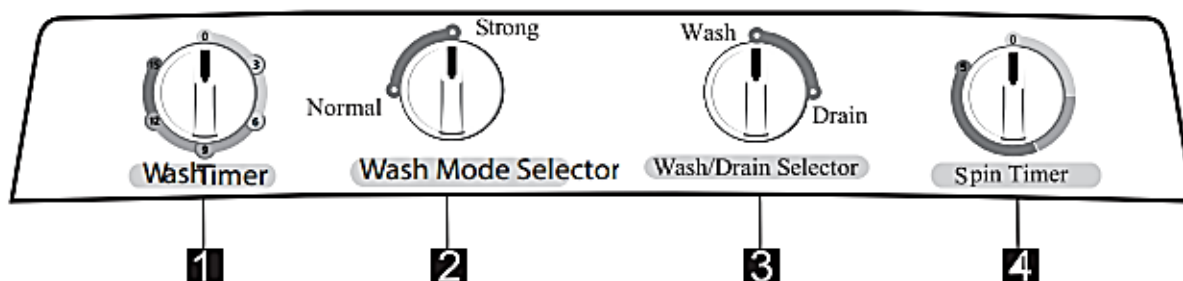

No	Name/description
1	Washing machine timer — for setting the washing time (1–15 min)
2	Selector switch — for switching over to the operational modes “Normal” and “Strong”
3	Selector switch Wash/Drain — for switching over to washing procedure and drain
4	Spin-drying time — for adjusting the spin-drying time (1–5 min)

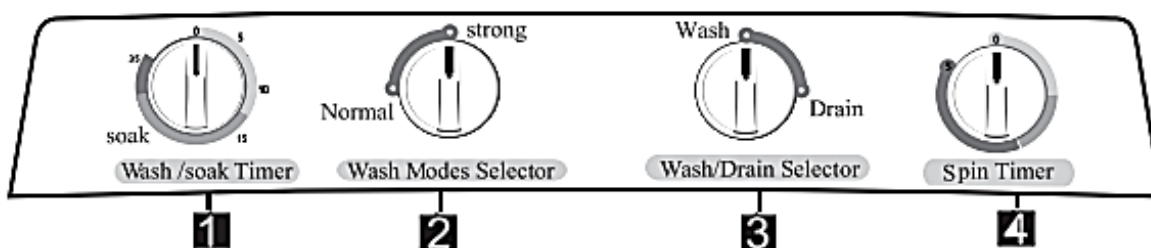

No	Name/description
1	Washing machine timer — for setting the washing/soaking time
2	Selector switch — for switching over to the operational modes “Normal” and “Strong”
3	Selector switch Wash/Drain — for switching over to washing procedure and drain
4	Spin-drying time — for adjusting the spin-drying time (1–5 min)

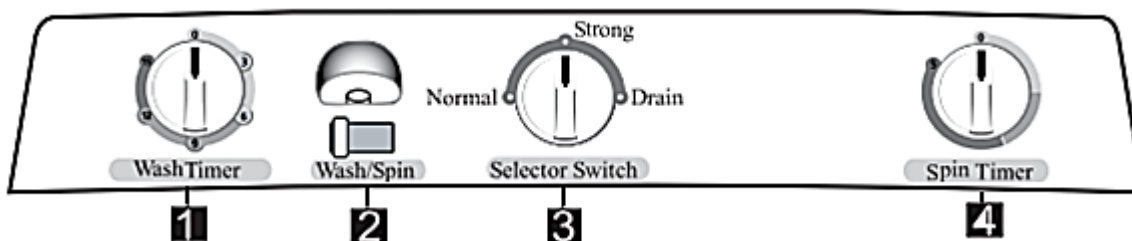

No	Name/description
1	Washing machine timer — for setting the washing time (1–15 min)
2	Selector switch Wash/Spin-drying
3	Selector switch — for switching over to the operational modes “Normal,” “Strong,” “Drain”
4	Spin-drying time — for adjusting the spin-drying time (1–5 min)

Using the integrated water inlet

The integrated water inlet is meant to supply the washing and spin-drying procedure. With the selector switch “Wash/Spin-drying”, you can switch between the water supply of the washing drum and spin-drying drum.

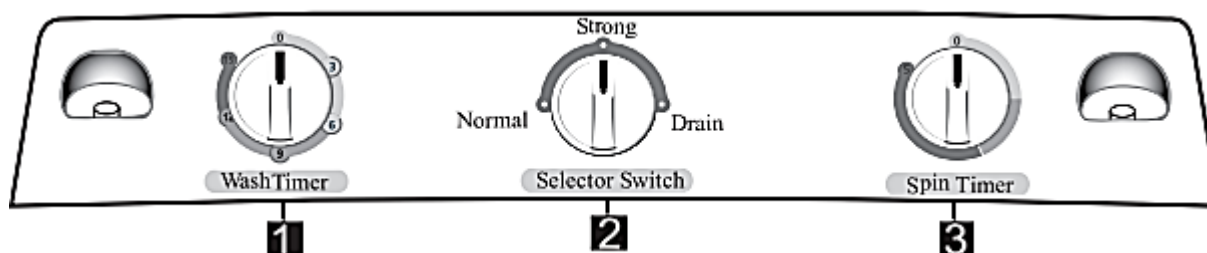

No	Name/description
1	Washing machine timer — for setting the washing time (1–15 min)
2	Selector switch — for switching over to the operational modes “Normal,” “Strong,” “Drain”
3	Spin-drying time — for adjusting the spin-drying time (1–5 min)

Using the double water inlet

The machine has two water inlets. Each drum has a separate water inlet.

Attention!

- The maximum water inlet pressure is 3 bar.
- The minimum water inlet pressure is 0.2 bar.

If spin-drying does not come to a standstill in the space of 12 s after opening the lid, stop operation and contact an expert.

Installation

- Place the washing machine to a level and stable surface.
- Keep the washing machine at a distance of more than 5 cm from the wall to avoid noises during washing.

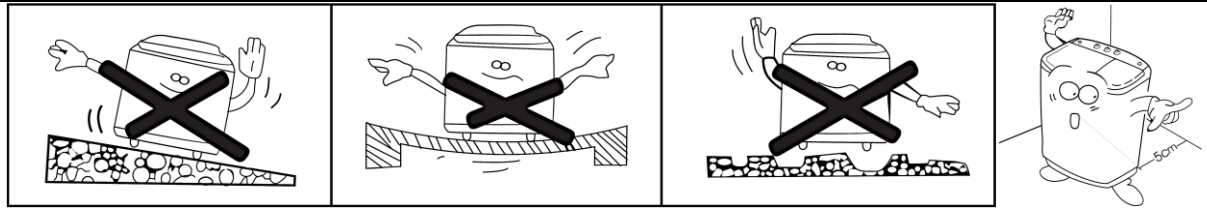

Connecting the drain hose (if there is no drain pump)

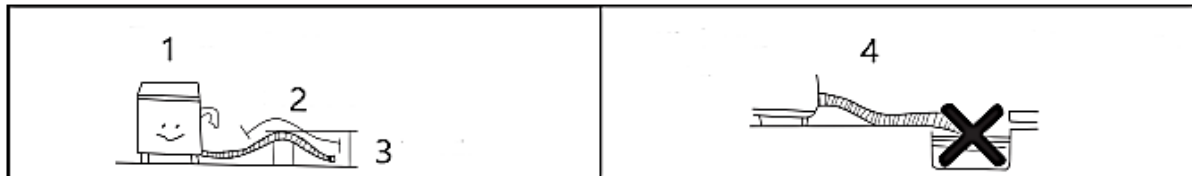

No	Name/description
1	Drain hose extension
2	Below 2 m
3	Below 15 cm
4	The end of the drain hose must never be put into water.

Operation

Preparing clothes before washing

Make sure that all objects such as keys, pins, or coins are removed from the clothes.	Greasy or coloured clothes should be washed separately.
Turn inside out before washing fleecy clothes.	Wash delicate clothes in a nylon net.

Washing

- Before washing, note the following:
 - Connect the water inlet hose and open the water cock.
 - Connect the power cable to the power supply.



- Place the end of the drain hose (A) downwards in a washbasin.
- Place the end of the drain hose (B) approx. 100 cm above the floor and in a washbasin or bathtub.

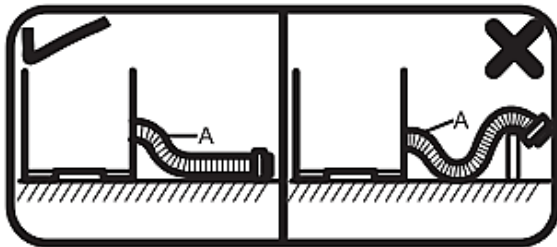

Without pump

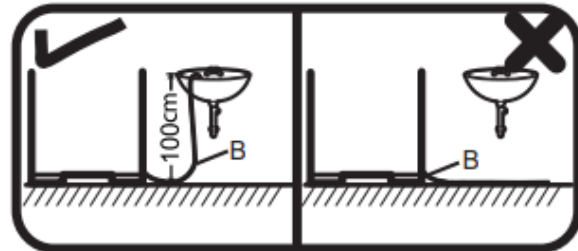

With pump

1. Set the selector switch to a mode as desired.
2. Set the Wash/Drain selector switch to the "Wash" position.
3. Set the water inlet selector switch to the "Wash" position.
4. Place the clothes that should be washed into the washing drum.
5. Pour water into the washing drum, then add detergent.
6. Set the washing timer.
7. After washing, set the selector switch to the "Drain" position or set the Wash/Drain selector switch to the "Drain" position.

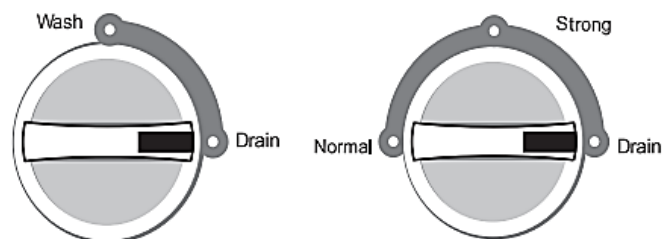

Flushing

1. Set the selector switch to the "Normal" position or set the Wash/Drain selector switch to the "Wash" position.

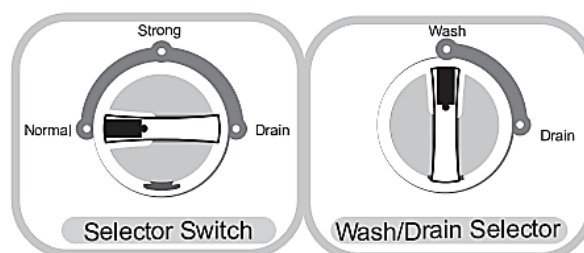

- Supply the correct quantity of water for the washing drum not to spill over.

Draining

- Make sure to keep the water supply. Adjust the water pressure so that the water supplied does not exceed the water drained.
- Set the washing timer to 6–8 min.
- As soon as the washing timer switches off, close the water cock.
- Drain the water by setting the selector switch to the “Drain” position.
- With a drain pump missing, lay absolutely down the drain hose.
- With a drain pump present, place the end of the drain hose into a washbasin or bathtub.



Spin-drying

- Place clothes into the spin-drying drum, dispose them evenly.

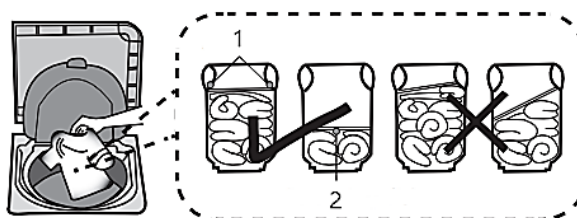

No	Name
1	Underside of compensation weight
2	Compensation disk

- Make sure to apply the cover of the compensation disk and to close the inner lid.

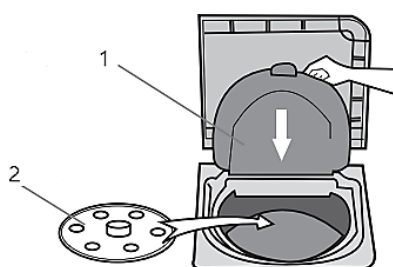

No	Name
1	Inner cover
2	Compensation disk

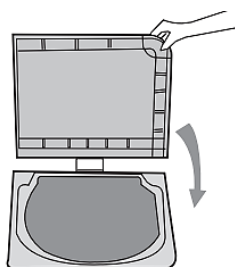

- Close the lid of the spin-drying drum.

- Set the spin-drying timer to 1–5 min.

Operation time

Spin-drying

Type of clothes	Time of spin-drying (min)
Shirts (synthetic)	1–2
Vests	3–5
Work clothes	5

Washing

Type of clothes	Washing time (min)	Setting
Very solid, heavy fabric	10–15	Strong
Linen, cotton, etc.	8–10	
Normal clothes (socks, etc.)	7	Normal
Somewhat solid synthetic fibre	2–5	
100 % wool, mixed wool, fine synthetic fibre with label demanding hand wash only	2–5	

Soaking (if necessary)

Type of clothes	Soaking time (min)
Very dirty clothes with stains	5–15

Attention! For safety reasons, you must close the water cock before spin-drying.

If the washing machine is equipped with a drain pump, please note the following:

- Using a washing machine equipped with a drain pump is the same as using a washing machine without drain pump.
- When the selector switch for washing is set to the “Drain” position, the pump begins to drain the water.
- When the spin-drying timer is turned, the spin-drying drum begins to rotate. In the same time, the pump starts running.
- Do not suspend the drain hose to a height exceeding 1 m; otherwise, the pump might not work correctly.
- Sometimes the pump is running, yet no water is drained. This is not a problem. Move the drain hose downwards.
- Switch off the device after draining is completed.



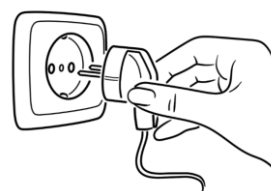

Maintenance

- After washing, disconnect the plug from the mains.
- Clean the device with a clean, dry, and soft cloth.
- After taking out the clothes, the drums need to be cleaned lest no deposits form.
- Remove the fluff filter and clean it.



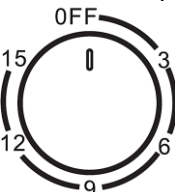

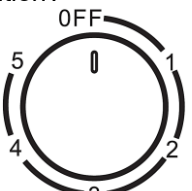
Troubleshooting

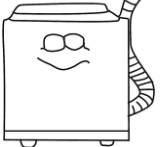
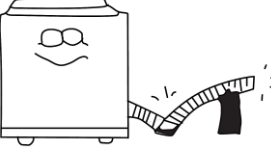
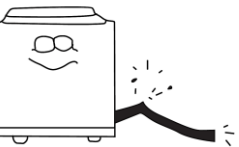
Problem	Check		
Washing does not start	Rotary knob set to "Off" position? 	Energy supplied? 	
Spin-drying does not start	Rotary knob set to "Off" position? 	Is the lid closed? 	Are the clothes disposed unevenly? 
No water is drained (if no pump is present)	Is the drain hose placed to a too high position? 	Is the drain hose twisted or too much inclined? 	Is the drain hose frozen? 
Washing too weak	<ul style="list-style-type: none"> • Are there too many clothes in the drum? • Is the fan belt too loose? • Is the tension too low? 		

Notes on spin-drying

Dispose the clothes evenly inside the drum.

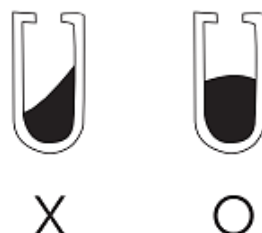

Attach the cover of the spin-drying mechanism.

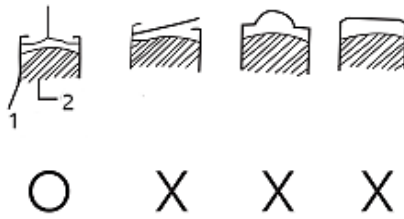

1	2
Clothes	Spin-dryer

Keep your hands away from the rotating drum.



Regulations for waste disposal

The Waste Electrical and Electronic Equipment Directive (WEEE Directive, 2012/19/EU) of the EU was implemented in the German law related to electrical and electronic equipment and appliances.

All WilTec electric devices that fall under the WEEE directive are labelled with the symbol of a crossed-out wheeled rubbish bin. This symbol indicates that this electric device must not be disposed of with the domestic waste.

WilTec Technik GmbH is registered with the German registration authority EAR (Stiftung Elektro-Altgeräte Register) under the WEEE-registration number DE45283704.

Disposal of used electrical and electronic devices (intended for use in the countries of the European Union and other European countries with a separate waste collection system for these devices).

The symbol on the packaging or the product itself indicates that this product must not be treated as normal domestic waste but must be disposed of at a recycling collection station for electrical and electronic waste.

By disposing of this product correctly, you contribute to the protection of the environment and the health of your fellow people. Inappropriate disposal threatens the environment and health.



Material recycling helps to reduce the consumption of raw materials.

Additional information about the recycling of this product can be provided by your local commune, the municipal waste disposal facilities, or the store where you purchased the product.

Address:
WilTec Wildanger Technik GmbH
Königsbenden 12 / 28
52249 Eschweiler Germany

Important note:

Reproduction and any commercial use (of parts) of this operating manual, requires a written permission of WilTec Wildanger Technik GmbH.