

# Operation Manual

## NW-4-400ROD 4-stage Reverse Osmosis 64400



Illustration similar, may vary depending on model

Read and follow the operating instructions and safety information before using for the first time.

Technical changes reserved!

Due to further developments, illustrations, functioning steps, and technical data can differ insignificantly.

Updating the documentation

If you have suggestions for improvement or have found any irregularities, please contact us.



The information contained in this document may alter at any time without previous notice. It is prohibited to copy or spread any parts of this document in any way without prior written allowance. All rights reserved.

The WilTec Wildanger Technik GmbH cannot be held accountable for any possible mistakes in this operating manual, nor in the diagrams and figures shown.

Even though, the WilTec Wildanger Technik GmbH has undergone biggest possible efforts to ensure that the operating manual is complete, faultless, and up to date, mistakes cannot be entirely avoided.

If you should find a mistake or wish to make a suggestion for improvement, we look forward to hearing from you.

Send an e-mail to:

[service@wiltec.info](mailto:service@wiltec.info)

or use our contact form:

<https://www.wiltec.de/contacts/>

The most recent version of this manual in various languages can be found in our online shop via:

<https://www.wiltec.de/docsearch>

Our postal address is:

WilTec Wildanger Technik GmbH  
Königsbenden 12  
52249 Eschweiler  
Germany

To return orders for exchange, repair, or other purposes, please use the following address. Attention! To allow for a smooth execution of your complaint or return, it is important to contact our customer service team before returning the goods.

Returns Department  
WilTec Wildanger Technik GmbH  
Königsbenden 28  
52249 Eschweiler

E-mail: **service@wiltec.info**

Tel: +49 2403 55592-0

Fax: +49 2403 55592-15



## Introduction

Thank you for purchasing this quality product. **To minimise the risk of injury we urge that our clients take some basic safety precautions when using this device. Please read the operation instructions carefully and make sure you have understood its content.**

Keep these operation instructions safe.

## Safety instructions

- Clean and replace the filter cartridges regularly.
- Do not disassemble parts indiscriminately; this can lead to leaks or damage.
- Do not use power supply units with an unsuitable rated voltage.
- Disconnect the mains plug and close the water tap before storing the appliance for a longer period.
- Do not store or use the appliance at an ambient temperature of 0 °C or below.
- Take care when installing or removing the cartridge or moving the appliance.

## Other instructions

- When not in use, interrupt the water supply and close the ball valve to prevent damage from pressure surges. Uncontrolled pressure surges can lead to leaks and damage to the filter housing. We accept no liability for damage caused by pressure surges.
- In the event of problems, disconnect the appliance from the power and water supply and contact a specialist. Replacing the filters may solve the problem.
- The appliance vibrates slightly during the filtering process.
- It is recommended that the cartridges are replaced by a specialist.
- If the water supply is insufficient, the indicator light lights up yellow and the buzzer sounds for 5 s
- After 50 operating hours, the indicator lights up green and the buzzer sounds for 10 s. At the same time, the system stops operating and reminds the user to replace the 3 pre-filters. The calculation of the filter service life starts after the system is switched on again.

## Note!

- Before opening the faucet for the first time, make sure that the system is correctly installed and working properly. Rinse the filters for 10–15 min before taking the first glass of water for drinking.
- Allow the system to run normally for more than 90 min before carrying out a test.

### Product and accessories

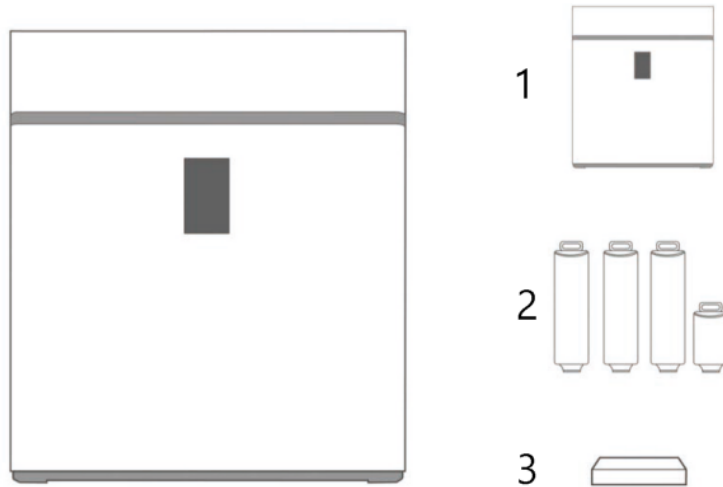

No	Name
1	Filter system
2	Six filter cartridges, including: PP sediment filter (PP), activated-carbon filter (CTO), reverse-osmosis membrane (RO), and activated-carbon post-filter (T-33)
3	Accessories box, including: water faucet, three-way valve, three hoses, user's manual, adaptor, and drain clamp

### Drawings illustrating contents of accessories box

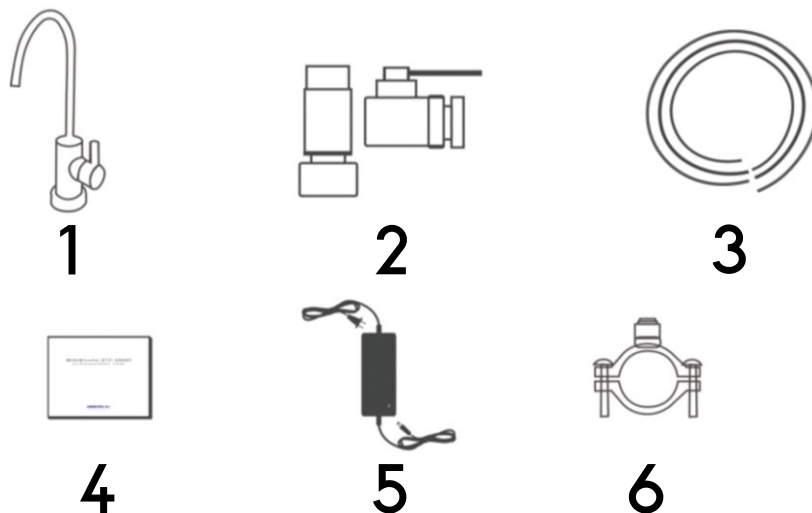

No	Name	No	Name
1	Water faucet	4	User's manual
2	3-way valve	5	Adaptor
3	3 hoses (red, blue, and white)	6	Drain clamp

**Note:** Might vary depending on disposability.

Connection diagram

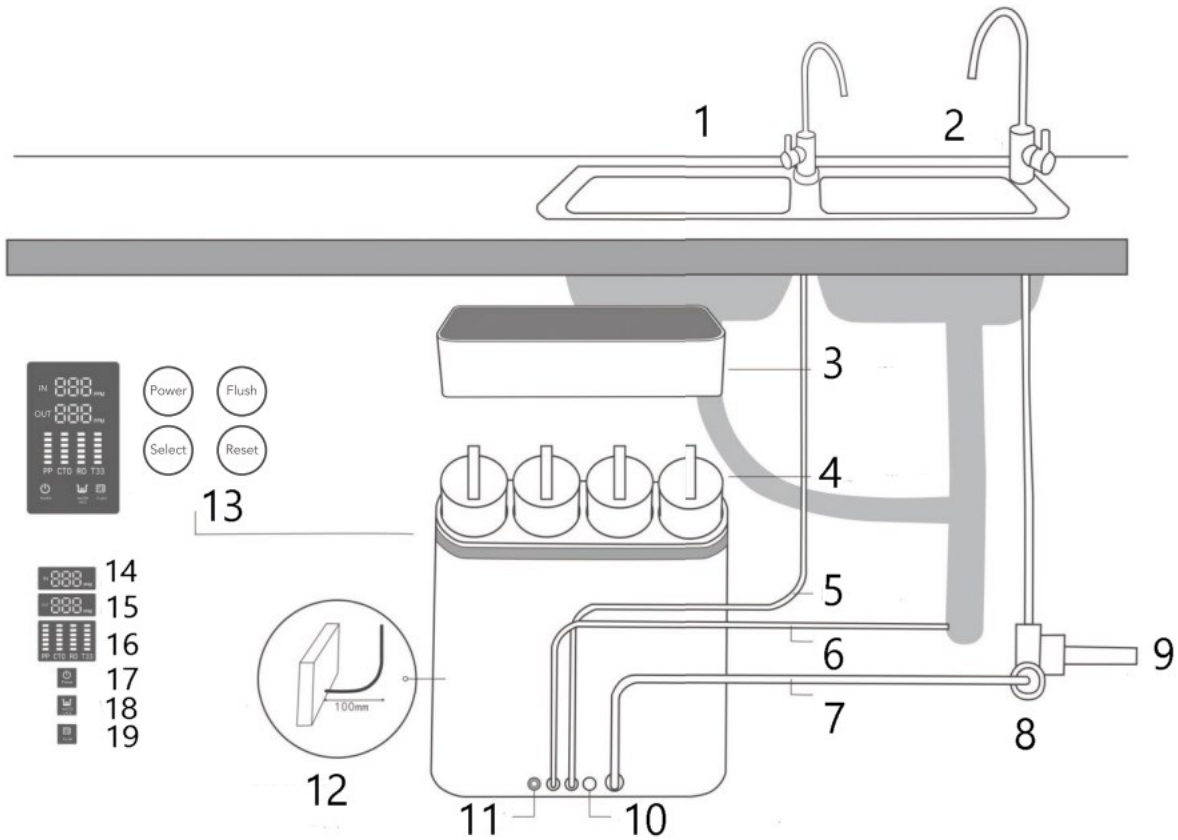

Nº	Name/description	Nº	Name/description
1	Reverse osmosis faucet	11	Current
2	Faucet	12	Leave at least 100 mm space on the back of the products to bend the tubes.
3	Dust cover	13	Display content and buttons
4	4 filter inserts	14	Inlet TDS
5	Pure water pipe	15	TDS outlet
6	Drain-heater pipe	16	Service life of the cartridge
7	Inlet pipe	17	Capacity
8	3-way ball valve	18	Low water alarm
9	Line for tap water	19	Cartridge flushing
10	Filtered water (optional)		

## Installation

### Installing the ball valve and T pieces

- Install the T piece and the 3-way ball valve according to the instructions.
- Wrap the thread of the 3-way ball valve and T piece with adhesive rubber.
- Connect the water supply line ( $\frac{3}{8}$ " , white) from the device to the feed-water valve.
- Install the 3-way ball valve to the T piece, then connect it to the water source.

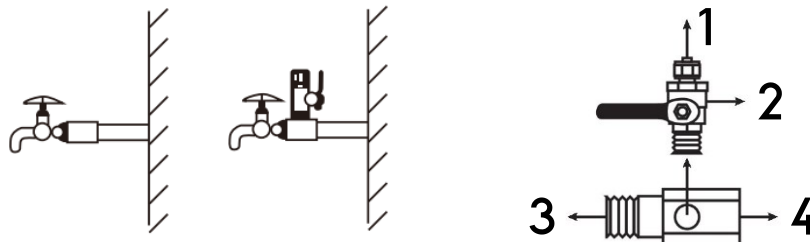

No	Name/description	No	Name/description
1	Water supply hose	3	Connect to pipe
2	3-way ball valve	4	Connect to faucet

### Mounting the water faucet

- Chose a suitable spot near your washbasin to install the water faucet.
- Drill a 12-mm diameter hole into the worktop.
- Install the washers, plates, gaskets, and nuts in the order shown and tighten them on the worktop.
- Fix the reverse-osmosis water line ( $\frac{1}{4}$ " , blue) to the underside of the water faucet, then connect the line to the device.

**Attention!** Make sure that the lines have been connected properly.

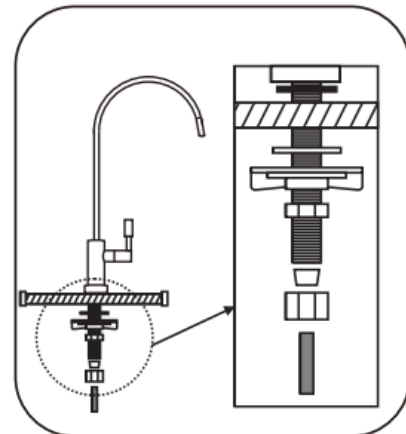

### Installing the drain clamp

- Install the drain clamp to the drainpipe above the syphon and tighten it.
- Using the drain clamp as a guide, drill a 6-mm hole large enough to feed the  $\frac{1}{4}$ -inch pipe through one side of the drainpipe. Do not drill through both sides!
- Connect the drainpipe ( $\frac{1}{4}$ " , red) from the device to the drain clamp.

### Attention!

- Cut the hoses cleanly and at right angles. Failure to do so will result in poor connections and possible water leaks.
- The lowest point of the pipe should be the point where the drain clamp is connected.
- The pipe should not sag, as this might lead to excessive noise when the wastewater flows to the drain.

### Drain-clamp assembly

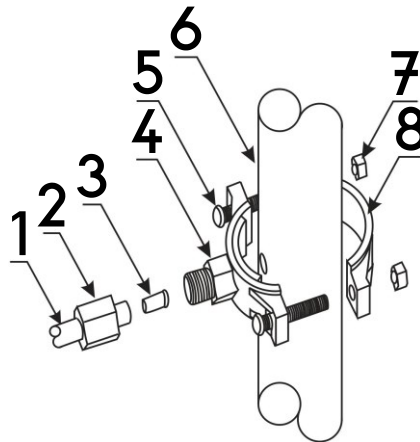

Nº	Name/description	Nº	Name/description
1	Drain hose	5	M6×35 screw
2	Cap nut	6	Drain pipe
3	Use	7	M6 nut
4	Drain clamp, front holder	8	Drain clamp, rear holder

### Instructions for initial commissioning

1. Connect the reverse osmosis system to the adapter, then the power indicator light lights up, the buzzer sounds three times, the device rinses for 90 s and the rinsing symbol flashes
2. The reverse osmosis system starts producing water and the integrated computer displays the TDS value, cartridge life and operating indicator in real time. All symbols go out when the water tank is full.
3. The water reservoir symbol flashes and buzzes 10 times if there is not enough water or the water pressure is too low. The machine rinses for 5 s if there is enough water or the water pressure is too high. 4.
4. The machine stops producing water and issues a warning message. All symbols flash and the buzzer sounds 30 times after 6 hours of uninterrupted operation or if a water leak is detected.

**Note!** During normal operation, you should drain water for 10–15 min to rinse the cartridges when using the machine for the first time.

## Replacing the cartridges and maintaining the device

### Recommended replacement intervals for cartridges

Stages	Filter cartridges	Function	Service life (guide value) (months)
1 <sup>st</sup> stage	PP sediment filter	Removes larger suspended particles from the water.	3–6
2 <sup>nd</sup> stage	CTO activated-carbon filter	Effectively remove chlorine, bind colour and odours from the water to extend the service life of the reverse-osmosis membrane.	3–6
3 <sup>rd</sup> stage	Reverse-osmosis membrane	Filters the finest pollutants from the water and allows only pure water to pass through.	12–24
4 <sup>th</sup> stage	Activate-carbon post-filter	Purifies the water again and ensures a good flavour.	3–6

### Reminder to replace the cartridges

There are 6 fields that display the current service life of the corresponding filter cartridge. All displays go out when the service life of the filter has expired.



### Note!

1. The actual service life of the filter can be influenced by the region, the water quality, the seasons and the daily water consumption, so that the time period for the filter change can vary.
2. Please replace regularly.

### Resetting the cartridges

Press and hold the selection button for 3 s to enter selection mode. Then press Select to select the cartridge that needs to be replaced and then press the Reset button. Selection mode is cancelled automatically if no operation is performed within 5 s.





## Replacing the cartridge

Please switch off the water and switch off the power before replacing the cartridges

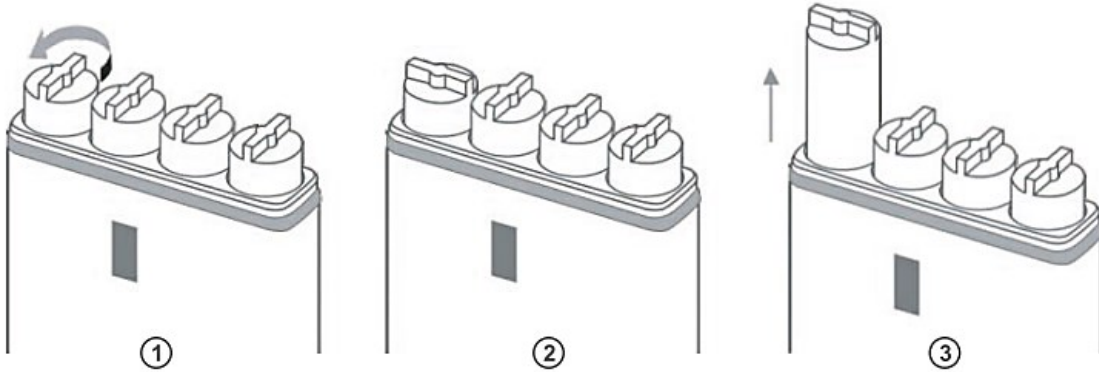
1. Open the lid.
2. Hold the cartridge handle firmly and turn it 90° anti-clockwise, then pull out the cartridge.



3. Insert a new cartridge, align the arrow mark with  and turn it 90° clockwise to .

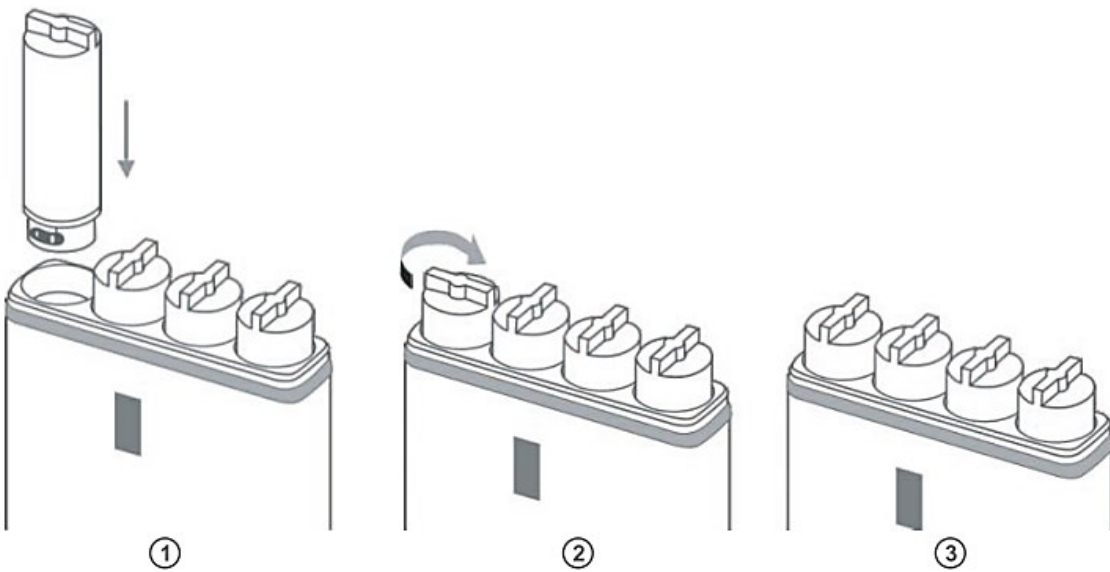

4. Replace the cap after replacing it (the cap cannot be replaced if the cartridges are not in the correct position).

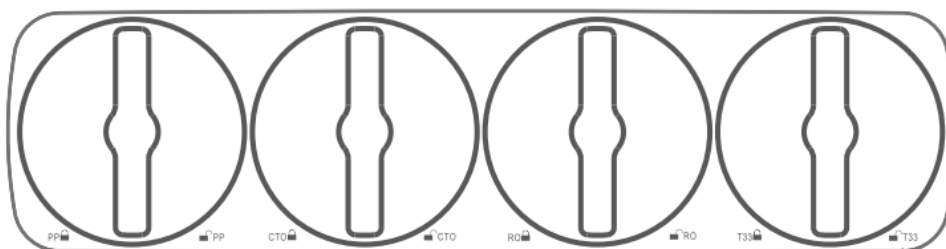

### Technical specifications

Quality of feed water	Municipal tap water
Pure water flow rate ( $\frac{l}{min}$ )	1.2
Temperature of feed water (°C)	5–45
TDS value of feed water (ppm)	≤ 250
Chlorine content of feed water (ppm)	≤ 0.2
Rejection (%)	90–99
Feed-water pressure (bar)	1–4
Stability against electric shocks	Type 2

### Process chart of water treatment

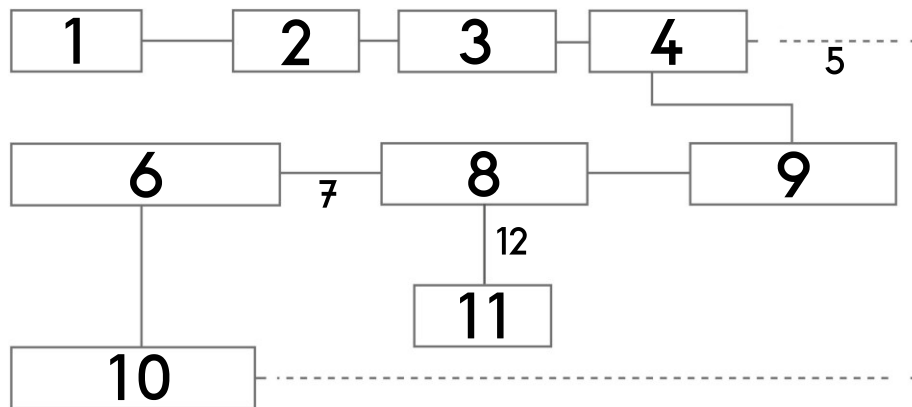

Nº	Name	Nº	Name
1	Feed water	7	Reverse-osmosis water
2	PP sediment filter	8	Reverse-osmosis filter
3	GAC activated-carbon filter	9	Pump
4	CTO activated-carbon filter	10	Water faucet
5	Purified water (optional)	11	Drain pipe
6	T33 filter	12	Waste water

## Wiring chart

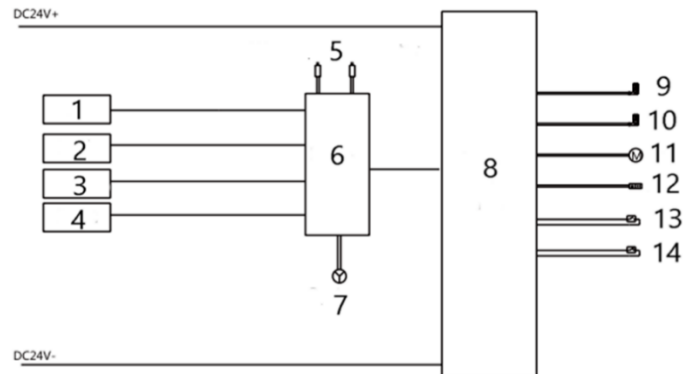

Nº	Name	Nº	Name
1	Electricity	8	Main control panel
2	Flushing	9	Water inlet solenoid valve
3	Select	10	Flush water solenoid valve
4	Reset	11	Pump
5	Water quality detector	12	Leakage detector
6	Display panel	13	Low pressure switch
7	Optional	14	High pressure switch

## Troubleshooting

Problem	Possible cause	Suggested solution
Water pump out of order, system does not work	Insufficient feed water pressure	Increase feed water pressure.
	No power or power failure	Switch on.
	High-pressure switch defective	Replace high-pressure switch.
	Pump blocked, adapter fuse blown	Replace adapter and repair water pump.
Water pump is running, but system is not working	Reverse osmosis membrane clogged	Replace reverse osmosis membrane.
	Pressure loss of the water pump	Repair the water pump.
High TDS value	The TDS value of the feed water is too high or the system has not been used for a long time	Open the faucet to draw pure water for a while.
	Service life of the cartridge has been exceeded	Replace cartridge.
Constantly flowing water when machine is in standby	Solenoid valve for water inlet damaged	Replace feed water solenoid valve.
Cannot stop working when the pressure tank is full or is started repeatedly	High pressure switch is damaged	Repair or replace high-pressure switch.
	Check valve damaged	Replace check valve.

## Disposal regulations

EU guidelines regarding the disposal of scrap electric appliances (WEEE, 2012/19/EU) were implemented in the law related to electrical and electronic equipment and appliances.

All WiTec electric devices that fall under the WEEE regulations are labelled with the crossed-out wheeled waste bin logo. This logo indicates that this electric equipment must not be disposed with the domestic waste.

The company WiTec Technik GmbH has been registered in the German registry EAR under the WEEE-registration number DE45283704.

Disposal of used electrical and electronic appliances (intended for use in the countries of the European Union and other European countries with a separate collection system for these appliances).

The logo on the article or on its packaging points out that this article must not be treated as normal household waste but must be disposed to a recycling collection point for electronic and electrical waste equipment. By contributing to the correct disposal of this article you protect the environment and the health of your fellow men. Environment and health are threatened by inappropriate disposal.



Material recycling helps reduce the consumption of raw materials.

Additional information on recycling this article can be provided by your local community, municipal waste disposal facilities, or the store where you purchased the article.

Address:  
WiTec Wildanger Technik GmbH  
Königsbenden 12 / 28  
D-52249 Eschweiler

Important notice:

The reprint or reproduction, even of excerpts, and any commercial use, even in part, of this instruction manual require the written permission of WiTec Wildanger Technik GmbH.