

Operating instructions

Naturewater 5-stage RO System

64404



Illustration similar, may vary depending on model

Read and follow the operating instructions and safety information prior to initial operation.

Technical changes reserved!

Illustrations, functional steps, and technical data may deviate insignificantly due to continuous further developments.

Updating the documentation

If you have suggestions for improvement or have found any irregularities, please contact us.



The information contained in this document may alter at any time without prior notice. No part of this document may be copied or otherwise duplicated without prior written consent. All rights reserved. WilTec Wildanger Technik GmbH cannot be held liable for any possible mistakes in this operating manual, nor in the diagrams and illustrations shown.

Although WilTec Wildanger Technik GmbH has made every possible effort to ensure that this operating manual is complete, accurate, and up-to-date, errors cannot be ruled out entirely.

If you have found an error or wish to suggest an improvement, we look forward to hearing from you. Send us an e-mail to:

service@wiltec.info

or use our contact form:

<https://www.wiltec.de/contacts/>

The most recent version of this manual in several languages can be found in our online shop:

<https://www.wiltec.de/docsearch>

Our postal address is:

WilTec Wildanger Technik GmbH
Königsbenden 12
52249 Eschweiler – Germany

To return your goods for exchange, repair, or other purposes, please use the following address. Attention! To allow for a trouble-free complaint or return, it is important to contact our customer service team before returning your goods.

Retourenabteilung
WilTec Wildanger Technik GmbH
Königsbenden 28
52249 Eschweiler – Germany

E-mail: **service@wiltec.info**

Tel: +49 2403 55592-0

Fax: +49 2403 55592-15



Introduction

Thank you for choosing to purchase this quality product. To minimise the risk of injury, we ask you to always take some basic safety precautions when using this product. Please read this operating manual carefully and make sure that you understand it. Keep these operation instructions in a safe place.

Safety instructions

- Regularly clean and replace the filter cartridges.
- Do not disassemble the parts randomly; this could provoke leakages or damages.
- Do not use mains adaptors the voltage of which is not suitable.
- Before storing the device for a long period, disconnect the mains plug and close the water tap.
- Do not store or use the device when the ambient temperature is 0 °C or below.
- Proceed with caution when installing or unmounting a cartridge or when moving the device.

Other instructions

- When not using the device, interrupt the water supply and close the ball valve to avoid damages caused by water hammers. Uncontrolled water hammers might cause leakage or damages to the filter housing. Warranty is excluded for damages caused by water hammers.
- When problems occur, disconnect the device from the mains and water supply and contact an expert. Changing the filter might repair the problem.
- The device vibrates during operation.
- It is recommended to have an expert replace the cartridge.
- With insufficient water supply, the control lamp is yellow, a buzzer sounds during 5 s.
- After 50 hours of operation, the indicator is green, and the buzzer sounds during 10 s. At the same time, the system shuts down and reminds the user of replacing the 3 pre-filters. The calculation of the service life of the filters is reinitialised after new start.

Note!

- When operating the device for the first time, check the system for correct installation and smooth operation before opening the water tap. Rinse the filter during 10–15 min before using the water for alimentation purposes.
- Wait for the system to normally run during more than 90 min before performing any test.

Product and accessories

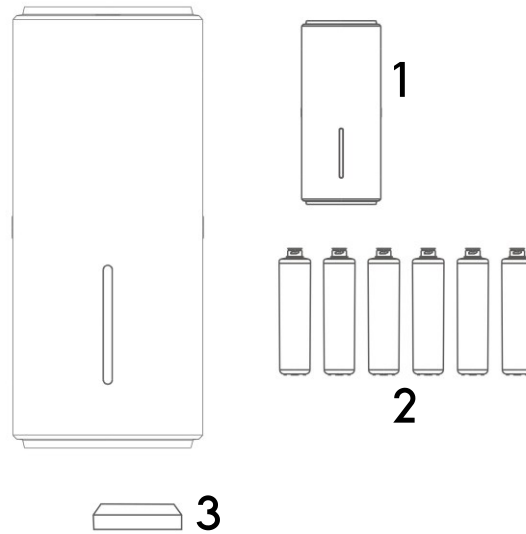

No	Name
1	Filter system
2	Six filter cartridges, including: PP sediment filter (PP), activated-carbon filter (CTO), cocnut activated-carbon filter (COC), 2× reverse-osmosis membrane (RO), and activated-carbon post-filter (T-33)
3	Accessories box, including: water faucet, three-way valve, three hoses, user's manual, adaptor, and drain clamp

Drawings illustrating contents of accessories box

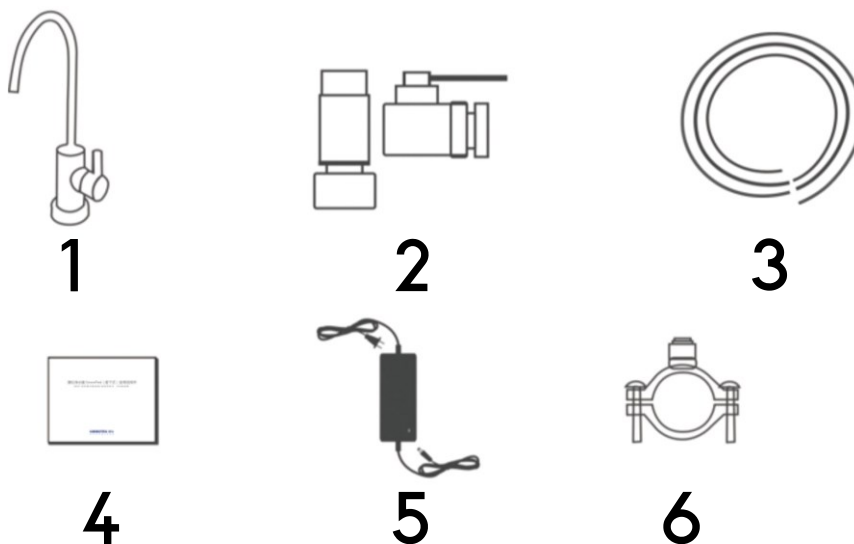

No	Name	No	Name
1	Water faucet	4	User's manual
2	3-way valve	5	Adaptor
3	3 hoses (red, blue, and white)	6	Drain clamp

Note: might vary depending on desposability.

Connection diagram

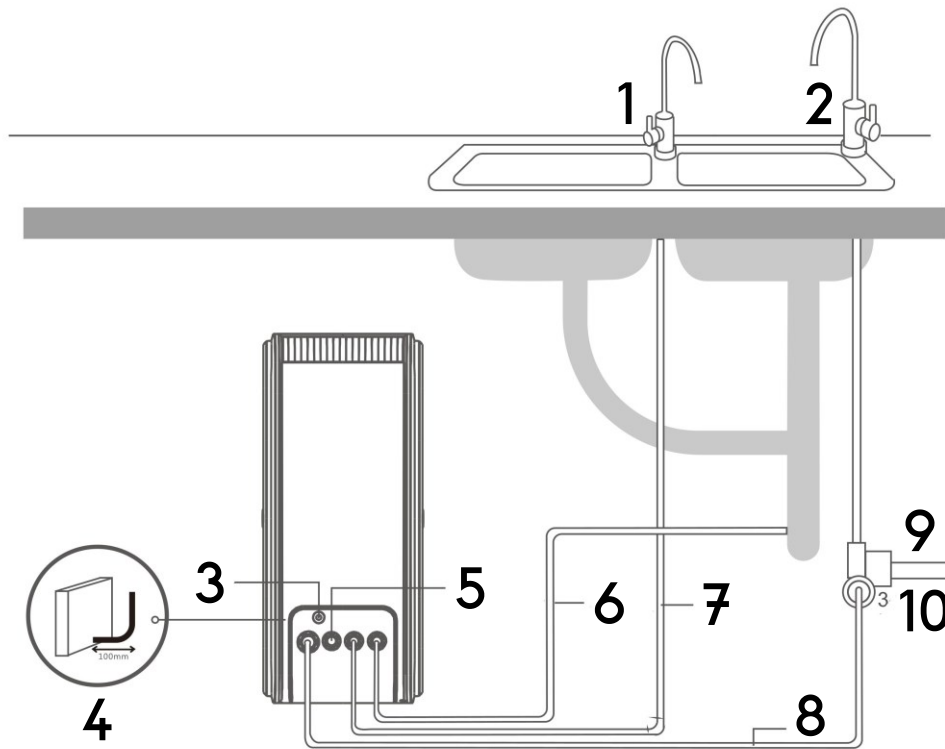

Nº	Name/description	Nº	Name/description
1	Reverse-osmosis water faucet	6	Water drain hose (red ¼" tube)
2	Feed water tap	7	Reverse-osmosis water hose (blue)
3	Energy	8	Water inlet hose (white ⅜" tube)
4	Reserve at least 100 mm for pipe bends at the rear side.	9	Feed water line
5	Filtered water (optional)	10	3-way ball valve

Installation

Installing the ball valve and T pieces

- Install the T piece and the 3-way ball valve according to the instructions.
- Wrap the thread of the 3-way ball valve and T piece with adhesive rubber.
- Connect the water supply line ($\frac{3}{8}$ " , white) from the device to the feed-water valve.
- Install the 3-way ball valve to the T piece, then connect it to the water source.

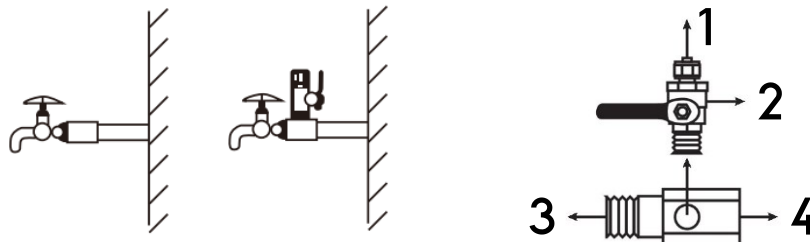

No	Name/description	No	Name/description
1	Water supply hose	3	Connect to pipe
2	3-way ball valve	4	Connect to faucet

Mounting the water faucet

- Chose a suitable spot near your washbasin to install the water faucet.
- Drill a 12-mm diametre hole into the worktop.
- Install the washers, plates, gaskets, and nuts in the order shown and tighten them on the worktop.
- Fix the reverse-osmosis water line ($\frac{1}{4}$ " , blue) to the underside of the water faucet, then connect the line to the device.

Attention! Make sure that the lines have been connected properly.

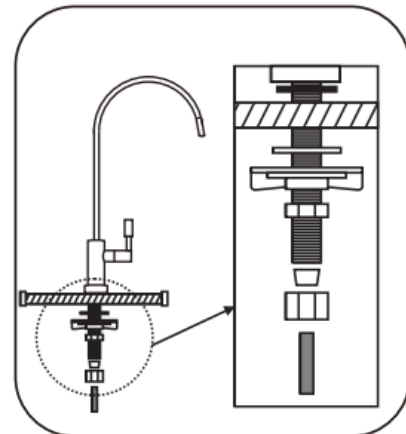

Installing the drain clamp

- Install the drain clamp to the drain pipe above the syphon and tighten it.
- Using the drain clamp as a guide, drill a 6-mm hole large enough to feed the $\frac{1}{4}$ -inch pipe through one side of the drain pipe. Do not drill through both sides!
- Connect the drain pipe ($\frac{1}{4}$ " , red) from the device to the drain clamp.

Attention!

- Cut the hoses cleanly and at right angles. Failure to do so will result in poor connections and possible water leaks.
- The lowest point of the pipe should be the point where the drain clamp is connected.
- The pipe should not sag, as this might lead to excessive noise when the waste water flows to the drain.

Drain clamp assembly

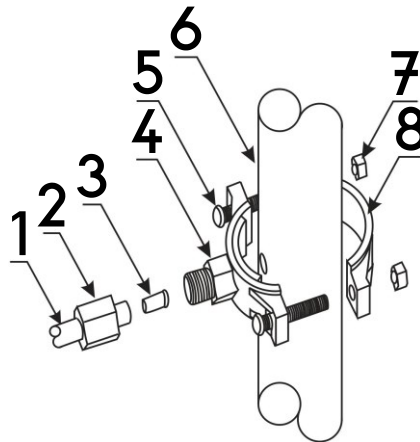

Nº	Name/description	Nº	Name/description
1	Drain hose	5	M6×35 screw
2	Cap nut	6	Drain pipe
3	Use	7	M6 nut
4	Drain clamp, front holder	8	Drain clamp, rear holder

Instructions for first operation

1. Connect the reverse-osmosis system with the adapter. The power-indicator light lights up, the buzzer sounds three times, and the machine is rinsed for 90 s while the indicator light flashes blue slowly.
2. While the indicator light flashes blue slowly, the system starts producing pure water. The device switches to standby, and the indicator light lights up blue continuously when the water tank is full.
3. As soon as the system stops producing pure water, the indicator lamp lights up red. The buzzer sounds 30 times after 6 hours of uninterrupted operation or if a water leak has been detected.

Replacing the cartridges and maintaining the device

Recommended replacement intervals for cartridges

Stages	Filter cartridges	Function	Service life (guide value) (months)
1st stage	PP sediment filter	Removes larger suspended particles from the water.	3–6
2nd stage	CTO activated-carbon filter	Effectively remove chlorine, bind colour and odours, and filter the smallest impurities from the water to extend the service life of the reverse-osmosis membrane.	3–6
3rd stage	COC activated-carbon filter		3–6
4th stage	Reverse-osmosis membrane	Filters the finest pollutants from the water and allows only pure water to pass through.	12–24
5th stage	Activate-carbon post-filter	Purifies the water again and ensures a good flavour.	3–6

Replacing the filter cartridges

1. Before replacing the cartridges, turn off the water, close the tap, open the reverse-osmosis tap, and drain the water in the pipe.

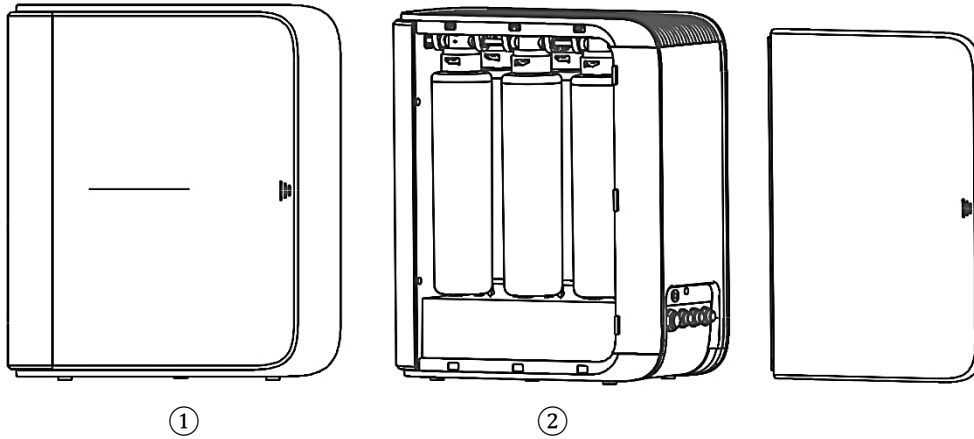

2. Tilt the cartridge by 30°, turn it anti-clockwise, and remove it.

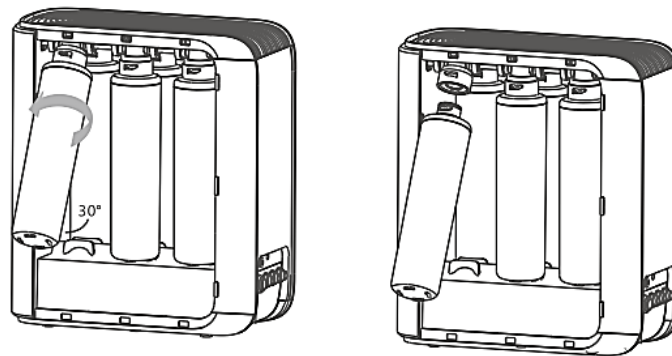

3. Insert the new cartridge by turning it clockwise according to the instructions, then attach the side bracket.

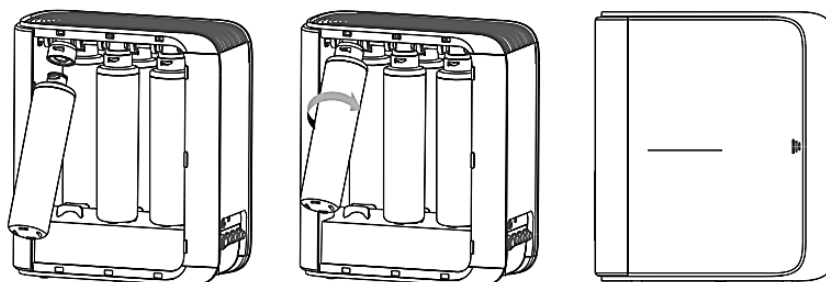

Note!

Please reset the cartridges after replacement.

Technical specifications

Quality of feed water	Municipal tap water
Pure water flow rate (ℓ/min)	1.2
Temperature of feed water ($^{\circ}\text{C}$)	5–45
TDS value of feed water (ppm)	≤ 250
Chlorine content of feed water (ppm)	≤ 0.2
Rejection (%)	90–99
Feed-water pressure (bar)	1–4
Stability against electric shocks	Type 2

Process chart of water treatment

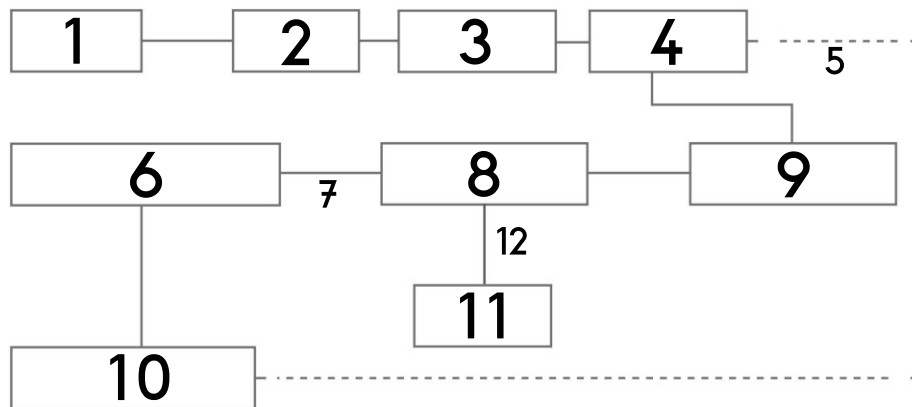

Nº	Name	Nº	Name
1	Feed water	7	Reverse-osmosis water
2	PP sediment filter	8	Reverse-osmosis filter
3	GAC activated-carbon filter	9	Pump
4	CTO activated-carbon filter	10	Water faucet
5	Purified water (optional)	11	Drain pipe
6	T33 filter	12	Waste water

Wiring chart

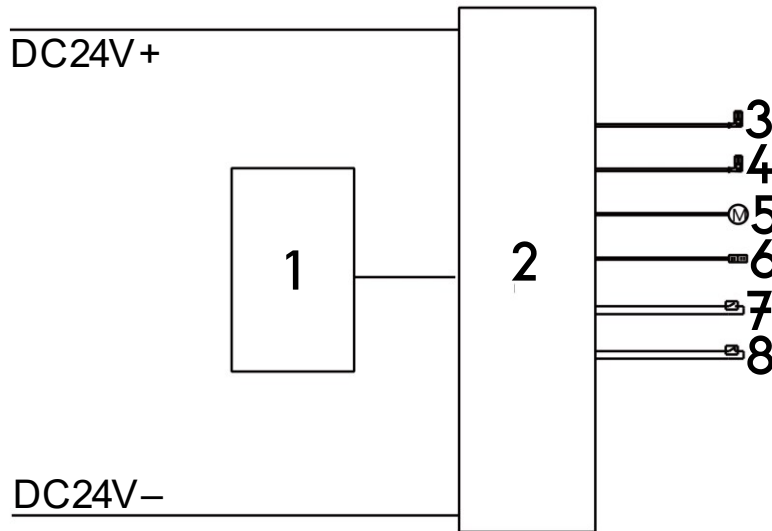

Nº	Name	Nº	Name
1	Indicator light	5	Pump
2	Main control	6	Leakage detector
3	Solenoid valve of water inlet	7	Low-pressure switch
4	Solenoid valve of flush water	8	High-pressure switch

Troubleshooting

Problem	Possible cause	Proposed solution
Water pump out of order, system not working	Insufficient feed water pressure	Raise feed water pressure.
	No electricity or outage	Switch on.
	High-pressure switch damaged	Exchange high-pressure switch.
	Pump blocked, adapter fuse blown	Replace adapter, repair water pump.
Water pump is running, but system is not working	Reverse-osmosis membrane obstructed	Replace reverse-osmosis membrane.
	Pressure loss of water pump	Repair water pump.
	Solenoid valve for flushing damaged	Replace flush solenoid valve.
Constantly flowing water at standstill	Solenoid valve for water inlet damaged	Replace water-inlet solenoid valve.
Cannot be switched off when pressure tank is full or is started repeatedly	High-pressure switch damaged	Repair or replace high-pressure switch.
	Non-return valve damaged	Replace non-return valve.

Regulations for waste disposal

The Waste Electrical and Electronic Equipment Directive (WEEE Directive, 2012/19/EU) of the EU was implemented in the German law related to electrical and electronic equipment and appliances.

All WilTec electric devices that fall under the WEEE directive are labelled with the symbol of a crossed-out wheeled rubbish bin. This symbol indicates that this electric device must not be disposed of with the domestic waste.

WilTec Technik GmbH is registered with the German registration authority EAR (Stiftung Elektro-Altgeräte Register) under the WEEE-registration number DE45283704.

Disposal of used electrical and electronic devices (intended for use in the countries of the European Union and other European countries with a separate waste collection system for these devices).

The symbol on the packaging or the product itself indicates that this product must not be treated as normal domestic waste but must be disposed of at a recycling collection station for electrical and electronic waste.

By disposing of this product correctly, you contribute to the protection of the environment and the health of your fellow people. Inappropriate disposal threatens the environment and health.



Material recycling helps to reduce the consumption of raw materials.

Additional information about the recycling of this product can be provided by your local commune, the municipal waste disposal facilities, or the store where you purchased the product.

Address:
WilTec Wildanger Technik GmbH
Königsbenden 12 / 28
52249 Eschweiler Germany

Important note:

Reproduction and any commercial use (of parts) of this operating manual, requires a written permission of WilTec Wildanger Technik GmbH.