

User's manual

AOYUE Solder Smoke Absorber FEK-01 with LED lights

91934

wiltec



Illustration similar, may vary depending on model

Please read and follow the operating instructions and safety information prior to initial operation.

Technical changes reserved!

Illustrations, functional steps, and technical data may deviate insignificantly due to continuous further developments.



The information contained in this document may alter at any time without prior notice. No part of this document may be copied or otherwise duplicated without prior written consent. All rights reserved. WilTec Wildanger Technik GmbH cannot be held liable for any possible mistakes in this operating manual, nor in the diagrams and illustrations shown.

Although WilTec Wildanger Technik GmbH has made every possible effort to ensure that this operating manual is complete, accurate, and up-to-date, errors cannot be ruled out entirely.

If you have found an error or wish to suggest an improvement, we look forward to hearing from you. Send us an e-mail to:

service@wiltec.info

or use our contact form:

<https://www.wiltec.de/contacts/>

The most recent version of this manual in several languages can be found in our online shop:

<https://www.wiltec.de/docsearch>

Our postal address is:

WilTec Wildanger Technik GmbH
Königsbenden 12
52249 Eschweiler – Germany

To return your goods for exchange, repair, or other purposes, please use the following address. Attention! To allow for a trouble-free complaint or return, it is important to contact our customer service team before returning your goods.

Retourenabteilung
WilTec Wildanger Technik GmbH
Königsbenden 28
52249 Eschweiler – Germany

E-mail: **service@wiltec.info**
Tel: +49 2403 55592-0
Fax: +49 2403 55592-15

Introduction

Thank you for choosing to purchase this quality product. To minimise the risk of injury, we ask you to always take some basic safety precautions when using this product. Please read this operating manual carefully and make sure that you understand it. Keep these operation instructions in a safe place.

Safety instructions

Before using the device for the first time, read the manual and familiarise yourself with it; otherwise, there is a risk of serious damages and/or injuries.

Warning!

- Remove all packaging parts and plastic films. **Fire hazard!**
- Do not stretch the holding arms of the device too far. The device could tip over.



- When inserting the HEPA filter into the device, make sure that the filter is inserted in the centre of the device. Also respect the note "THIS SIDE UP" and the corresponding arrows.



- Before removing it from the packaging, check each component for integrity. If you suspect damage, do not use the device and contact the dealer.
- Set the main switch to "OFF" and unplug the power cord from the socket before transporting the unit.
- Do not hit or step on the device or its components. Do not drop them and be careful not to subject them to any other type of shock. Do not put the device down abruptly and with a violent movement. **Contains fragile components! Risk of damage!**
- Make sure that the device is always earthed. Only connect it to an earthed socket.
- If the device is not used for a long period of time, the mains plug must be unplugged. If possible, switch off the device when you take a break.



- Modifications of the device, especially those of the internal circuit, are not permitted under any circumstances.

Description of the device

- This device is a portable solder fume extractor with built-in filtration consisting of a HEPA filter (high-efficiency particulate air filter) for removing dust particles and an improved activated carbon filter. The HEPA filters filter out 97 % of particles larger than 0.3 μm . Activated carbon sub-filters extend the service life of the main filters. The filters are characterised by a very good price-performance ratio.
- They contain high-performance activated carbon beads that filter odours and toxins from the air.
- The suction is powerful, yet the operation is quiet.
- The device is equipped with a control display that can be used to variably adjust the air flow.
- The holding arms of the device are freely adjustable and maintain their bend, the casters on the bottom of the device allow for great mobility.
- A special nozzle with built-in LED lamp is available.

Scope of delivery

- 1× device with main and activated carbon filter
 - 2× activated carbon sub-filter
 - 2× holding arm and related parts
 - 2× filter hood with LED lamp and activated carbon filter mats
 - 1× air inlet cover to use only one support arm
 - 4× lockable castors
 - 1× power cord
 - 1× user's manual
- Batteries for the lamps are not part of the delivery due to certain delivery regulations. The LED lamps are powered by a 9-V battery.
 - The main filter and activated carbon filter are located in the device. Before use, remove them from the plastic wrap.
 - Names of the filters
 - FEK-MF = main filter
 - FEK-CF = activated carbon filter

Components and boxes

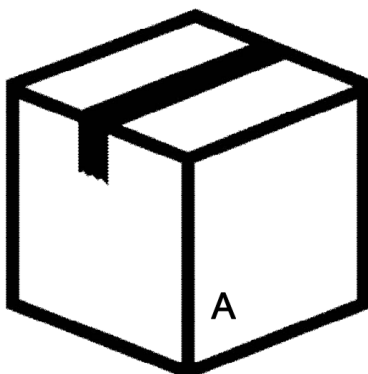

Box A, main carton, containing

- 2 × holding arm
- 1 × box B (main unit)
- 2 × box C (filter hood)
- 1 × box D (separate parts)

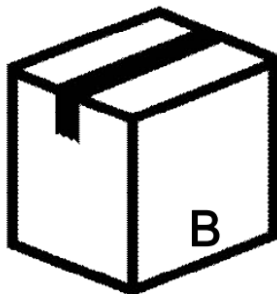

Box B, main unit box, containing

- 1 × main unit
- 1 × user's manual

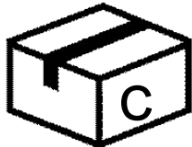

Box C, filter hood box, containing

- 1 × LED nozzle
- 1 × sub-filter



Box D, separate parts box, containing

- 4 × castor
- 1 × air inlet cover
- 1 × power cable

Technical specifications

Intake voltage (V)	110 / 220
Power consumption (W)	80–200
Size (mm)	320 × 450 × 260
Weight (kg)	8.5
Filter contained	HEPA filter, activated carbon filter

Parts



No	Name	No	Name
1	Filter hoods	5	LED display
2	Main switch	6	Active carbon filter
3	Electrical connection	7	Exhaust air outlet
4	Control switches	8	Holding arms

Explanation of the control panel

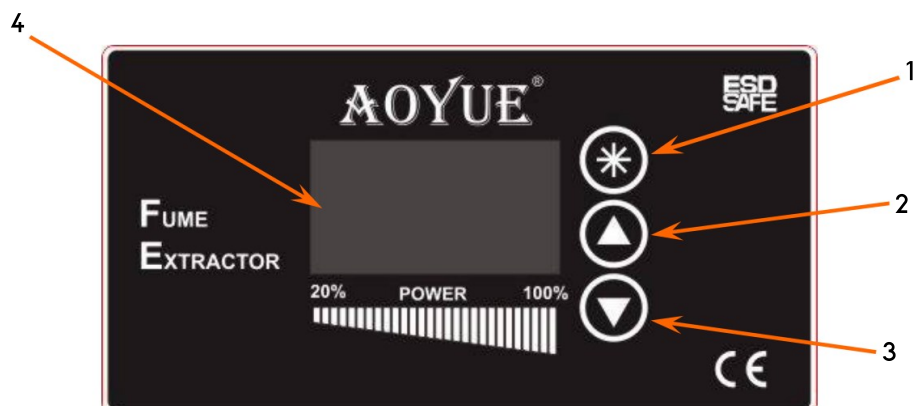

No	Name	No	Name
1	On/off switch (press and hold for switching on and off)	3	Reduce value (down)
2	Increase value (up)	4	LED display

Assembly



1. wheels: Attach wheels.

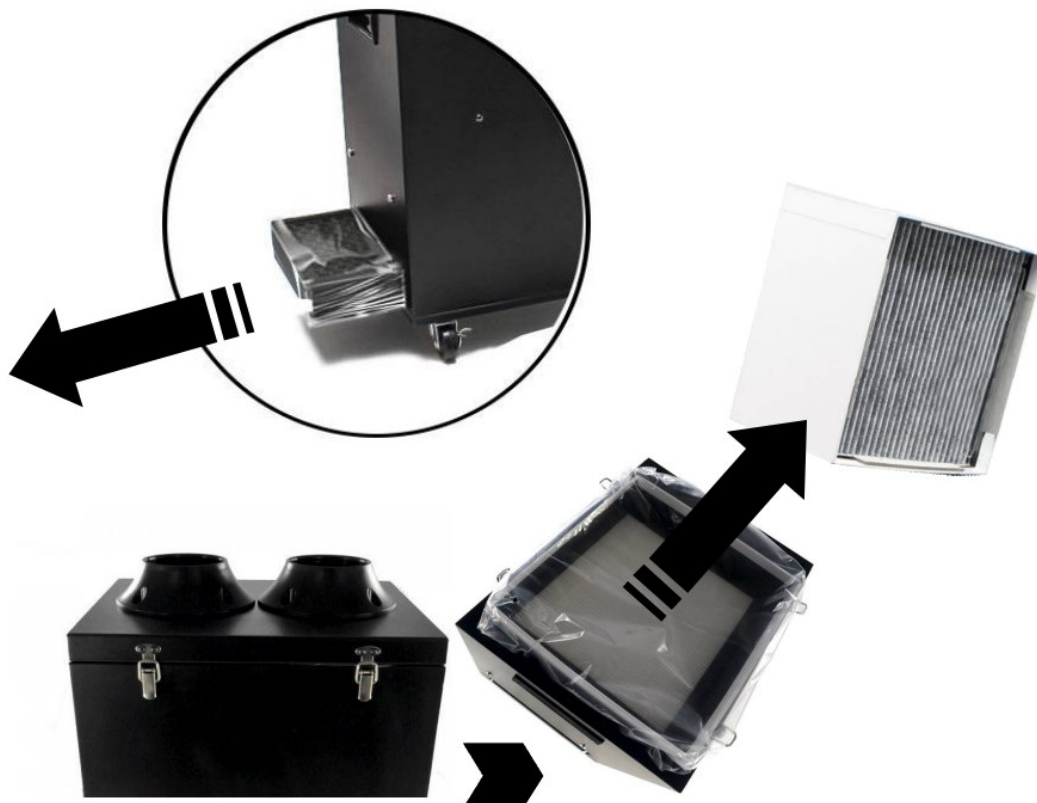

2. filters: Pull out FEK-CF carbon filter and remove protective film before use. Unlock top cover, remove the FEK-MF HEPA filter, and remove protective film.

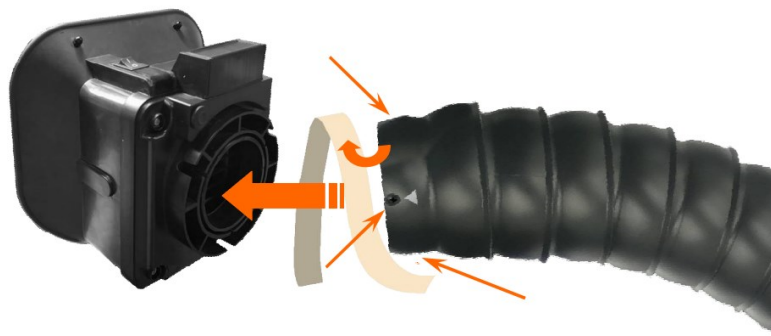

3. filter hood: a) Remove tape covering the 3×6-mm screw on the holding arm (see arrow).

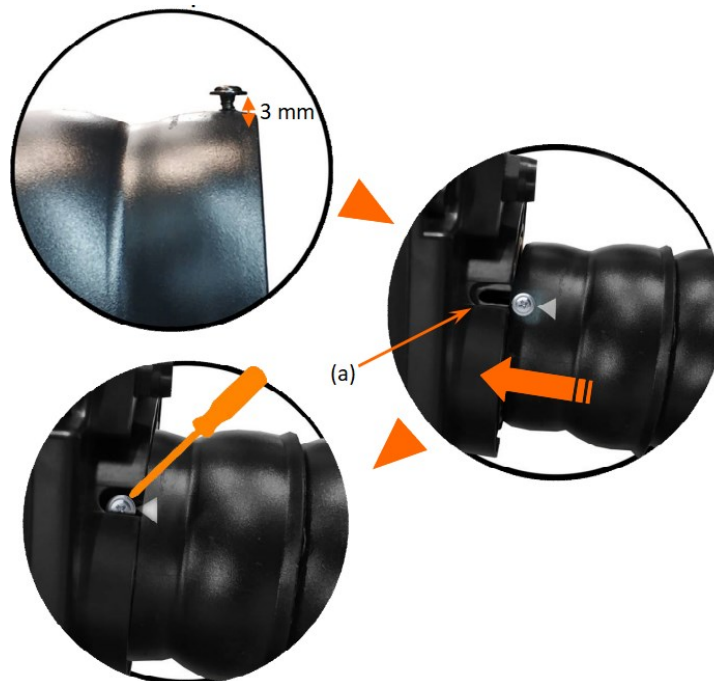

b) The screw protrudes about 3 mm. This allows it to be pushed into the U-shaped slot **(a)**. Push the holding arm in as far as you can, even if it takes a little force. Then tighten the screw until it is flush.



4. holding arms: a) Depending on whether you need one or both holding arms for suction, attach one or both.



b) Insert the arm into the exhaust air outlet. When installing a single arm, cover the unused outlet with the appropriate cover.

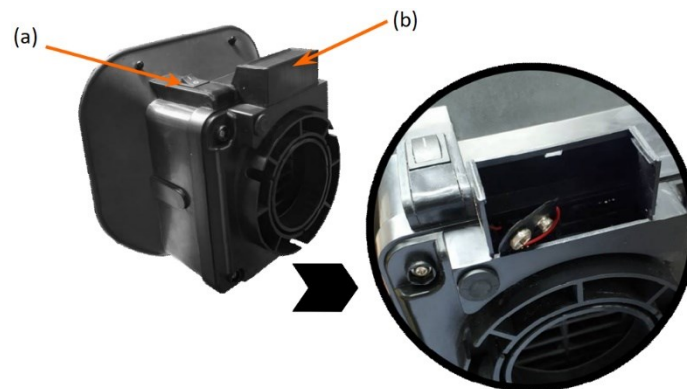

5. filter hood battery: Open the battery compartment cover (b) and insert the battery properly. The hood is switched on at the LED switch (a).

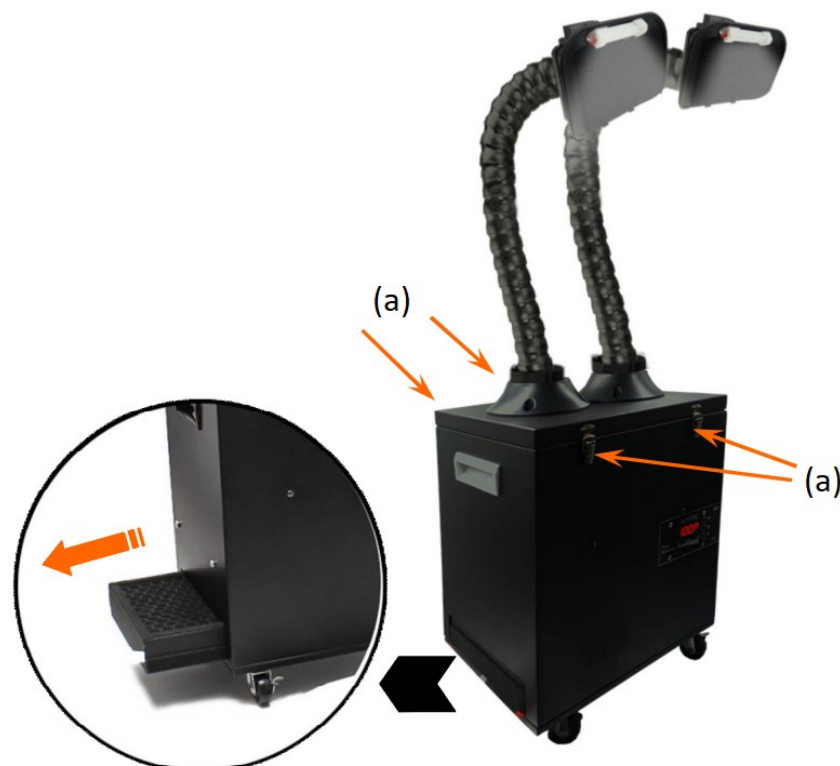

6. Ready! To remove the HEPA filter, the housing must be unlocked (a). Use the two white tabs to remove the activated carbon filter.





Use

General notes on use

- The device must be placed on a flat and firm surface. Be careful not to stretch the arms out too far, otherwise the device could tip over.
- Make sure that all switches are in the “OFF” position and that all connections are secure.
-  **Important:** The operation of the switches is described in the “Explanation of the control panel” section.

Method

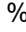
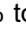
1. Plug the plug into an earthed power socket. The device is protected against electrostatic discharges and must be earthed for this protection to be fully effective.
2. Switch the device on on the main switch. The display panel will show “OFF” which means the unit is in stand-by mode.
3. Attach the arms to the appropriate connection points. Then align the arms to ensure maximum suction.
4. Press the switch  (on/off) to start suction.
5. The up  and down  switches control the speed of the exhaust fan. It can be set to a value from 20 % to 100 %. The speed of the extraction fan is saved with the switch ; pressing this switch again switches the device to stand-by mode.
6. Insert a battery into the battery compartment of the extraction hood as described (see above). Do not forget to close the battery compartment with the appropriate cover.
7. Press the LED switch (5a) to turn on the LED lamp. Press again to turn it off. When the LED lamp is not needed, please turn it off to save power.

Replacing the HEPA filter and activated carbon filter

1. The two filters should be replaced after approximately 3 months. However, the time of replacement depends on how the device is used. It is recommended to replace the two filters at the same time to keep the device working at its best.
2. Signs that indicate that the filters need to be replaced include the following:
 - a. HEPA filter has turned yellow or brown due to the absorption of a lot of particles and smoke.
 - b. The filter performance has lowered because there are many particles in the filter.
 - c. The extraction performance has lowered because the filter is clogged.
3. To replace the HEPA filter, unlock the top cover of the device and pull out the old HEPA filter. Unpack the new HEPA filter and then install it. Make sure that it is in the centre of the unit and note the direction of the arrows.
4. Lock the top cover again to prevent air leakage and suction performance degradation.
5. To replace the activated carbon filter, pull out the old filter by the two white tabs. Unpack the new carbon filter, then slide it into the unit.

Filter replacement notice

- The device may show “FLT” on the display panel. In this case, the filters must be replaced as described above.
- If the replacement of the filter is not required or if the filter has just been replaced, please reset the display by pressing and holding the up and down buttons at the same time until the display goes off.

Switching the frequency

The device can run at 50 Hz or at 60 Hz. The frequency is set at the factory, but it can also be changed manually. To do this, proceed as follows:



1. Set the main switch to "OFF."
2. Press and hold the up and down buttons while turning the power switch to the "ON" position.
3. The set frequency is shown in the display field, 50 or 60.
4. Repeat these steps to set the correct frequency.

 **Warning:** If the device is used with an incorrect frequency setting, suction malfunctions may occur. To avoid these malfunctions, the appropriate frequency must be set.

Important note:

Reproduction and any commercial use (of parts) of this operating manual, requires a written permission of WilTec Wildanger Technik GmbH.